

56th World Dairy Expo / Madison, WI, USA

RED & WHITE CATTLE LOG



Ms Ransom-Rail Beth-Red

2022 International Red & White Show Grand Champion

OCTOBER 4 - 5, 2023

TAKE THE MOMENT HOME

FROM THE COLORED SHAVINGS TO EDUCATION



photo credit: Cowsmo.

THE
DAIRY
SHOW



The Dairy Show, Expo's podcast, connects listeners to dairy producers and industry experts from around the globe to talk cows, cutting edge technology and the colored shavings. New episodes are available on the 2nd and 4th Tuesday of each month. Find The Dairy Show on Spotify, Apple Podcasts, Google Podcasts or at www.worlddairyexpo.com.

Relive every moment of Showring action all year with ExpoTV. Available at www.worlddairyexpo.com, ExpoTV captures highlights of each breed show class and complete livestreams of all six days of competition. Also available are recordings of Expo Seminars, Virtual Farm Tours, Dairy Forage Seminars and Expo en Español.





International Red & White Show

2:00 p.m. Wednesday, October 4 (Heifers)

7:00 a.m. Thursday, October 5 (Cows and Groups)

Dairy Cattle Exhibitor Committee

Chair

Tom Morris, Amery, WI

Vice-Chair

Bryan Voegeli, Monticello, WI

Overall Dairy Cattle Show Superintendent

Dave Bollig, Belleville, WI

Assistant Overall Dairy Cattle

Superintendent

Jon Rasmussen, Fond du Lac, WI

Ethics Coordinator

David Jeans, DVM, Evansville, WI

Katie Agnew, Oconomowoc, WI

Lucas Clanton, Mulberry Grove, IL

Evan Creek, Hagerstown, MD

Ted deMent, Kenney, IL

Brian Dinderman, Orangeville, IL

Erica Enright, Winchester, ON

Tom Foss, Cambridge, MN

Corey Geiger, Beaver Dam, WI

Lynn Harbaugh, Marion, WI

Emily Hartmann, Mulberry Grove, IL

Matt Hawbaker, Clear Spring, MD

Matt Henkes, Luana, IA

Jennifer Hill, Thurmont, MD

Christopher Lang, Big Prairie, OH

Steve Maddox, Riverdale, CA

Sheila McGuirk, DVM, Dodgeville, WI

Donna Mertz, DVM, Blair, NE

Terri Packard, Boonsboro, MD

Joe Rocha, Tillamook, OR

Chad Ryan, Fond du Lac, WI

Dusty Schirm, Ashville, OH

Kevin Stoltzfus, East Earl, PA

Eric Topp, Wapakoneta, OH

Roger Turner, Watertown, WI

Mark Valentine, Thurmont, MD

Bonnie Van Dyk, New Richmond, WI

Andrew Vander Meulen, Brighton, ON

Sarah Wendorf, Ixonia, WI

TJ Wingert, Kent, IL

World Dairy Expo Board of Directors

President

**Bill Hageman, At-Large Representative

Vice-President

**Tom Morris, WDE Dairy Cattle Exhibitor Committee Chair

Secretary/Treasurer

**Bob Hagenow, At-Large Representative

Bill Barlass, Director Emeritus

**Dave Bollig, Overall Dairy Cattle Show Superintendent

Scott Culbertson, Purebred Breeders of World Dairy Expo

Jason Danhof, Purebred Breeders of World Dairy Expo

Alan Deming, Director Emeritus

Kami Dorn, Wisconsin Guernsey Breeders Association

Glen Easter, Dairy Farmers of America

Dr. Paul Fricke, UW-Madison CALS

Corey Geiger, Holstein Association USA, Inc.

Calvin Graber, Associated Milk Producers, Inc.

Keith Heikes, URUS

Dean Hermsdorf, ABS Global, Inc.

**Laura Herschleb, World Dairy Expo General Manager

**Josh Hushon, At-Large Representative

**Kevin Jorgensen, Select Sires, Inc.

Ernie Kueffner, At-Large Representative

Dave Kyle, Foremost Farms USA

**Joan Lau, At-Large Representative

Jeff Lyon, At-Large Representative

Annie McCullough, Farm Journal Media, Official Program Publisher

Jennifer Meyer, Purebred Breeders of World Dairy Expo

Joseph Opsal, Dane County Holstein Breeders

Randy Romanski, Wisconsin Department of Agriculture,

Trade & Consumer Protection

Chad Ryan, Purebred Breeders of World Dairy Expo

Jeannette Sheehan, Purebred Breeders of World Dairy Expo

Jim Sipiorski, CentralStar Cooperative, Inc.

Brooke Trustem, BouMatic

**Bryan Voegeli, Purebred Breeders of World Dairy Expo

Ryan Weigel, Wisconsin Holstein Association

**Doug Williams, WDE Commercial Exhibitor Committee Chair

Emily Yeiser Stepp, National Milk Producers Federation

****Denotes Member of Executive Committee**

Dynasty in Dairy



2023

Official Judge

Phillip Topp

Botkins, Ohio

Associate Judge

Tanner Schmaling

Elkhorn, Wisconsin

Superintendent

Mike Marean

Albany, Wisconsin

World Dairy Expo

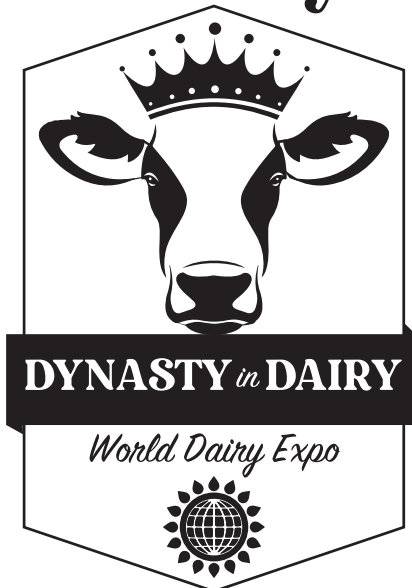

Please see the World Dairy Expo Premium Book for additional Dairy Cattle Show award sponsors.



World Dairy Expo, Inc.

3310 Latham Drive

Madison, Wisconsin 53713 USA

Phone: 608-224-6455

worlddairyexpo.com • wde@wdexpo.com

facebook.com/worlddairyexpo • twitter.com/wdexpo

instagram.com/wdexpo • linkedin.com/company/world-dairy-expo/

[spotify: spoti.fi/2XxFtdx](https://spotify.fi/2XxFtdx) • youtube.com/worlddairyexpo

ExpoFM: 95.7 FM

Staff

Laura Herschleb, General Manager

Laurie Breuch, Dairy Systems Manager

Lexa Miller, Cattle Show & Contests Coordinator

Jenifer Dobbs, Sponsorship Manager

Lisa Behnke, Communications Manager

Jenna Langrehr, Communications Specialist

Brian Paul, Trade Show Manager

Dawn Dommisie, Administrative Services Manager

Cassi Miller, Attendee Programs Manager

Michele Elliott, Staff Accountant

Kim Erb, Purple Cow Gift Shop Manager

Joan Judd, Office Assistant

A special "Thank You" to all Dairy Cattle Show sponsors including:

Supreme Champion:

The Gregory Blaska Memorial Trophy: World Dairy Expo

Supreme Champion Cash Award: BouMatic

Supreme Champion Royal Blanket: Agpro, Inc.

Reserve Supreme Champion Cash Award: Trans Ova Genetics

Reserve Supreme Champion Royal Blanket: E-Zee Milking Equipment, LLC

Supreme Champion of the Heifer Show:

The W. Terry Howard Memorial Trophy: World Dairy Expo

Supreme Champion of the Heifer Show Cash Award:
Trans Ova Genetics

Supreme Champion of the Heifer Show Royal Banner:
Trans Ova Genetics

Reserve Supreme Champion of the Heifer Show Cash Award:
Golden Calf Company

Reserve Supreme Champion of the Heifer Show Royal Banner:
Golden Calf Company

Grand Champion Sashes: Dynasty Genetics

Grand Champion Cash Awards: Udder Comfort Inc.

Junior Champion Sashes: In memory of Verlo DeWall by the DeWall Family

Junior Champion Cash Awards: Cargill Animal Nutrition

Neck Ribbons & Medallions: Jetstream Genetics, Inc.

Sunday Morning Coffee & Donuts: Hellenbrand Lasting Legacy Award

Morning Coffee Cart: ABS Global and St. Jacobs ABC

Dairy Cattle Exhibitor Appreciation Picnic: Destination Madison

Jim Crowley Jr. Overall Herdsmanship Award:
Chairs provided by Select Sires, Inc.

Semen Tank provided by MVE Biological Solutions

Herdsmanship Award Jackets: Select Sires, Inc.

Milking Parlor Equipment & Supplies: BouMatic

Exhibitor Welcome Bags: Extrutech Plastics, Inc.

Dairy Cattle Exhibitor Hats: Kemin Animal Health

Cattle Check-In Apparel: Sheila McGuirk DVM & Terri Ollivett DVM

840 Tag Sponsor: Datamars Livestock-North America

ExpoTV Broadcast: Dairy Management Inc., Diamond V,
Golden Calf Company, Semex/Boviteq, STgenetics and Zoetis

Barn Disinfectant: AgroChem USA, LLC

A special "Thank You" to all Junior Dairy Cattle Show sponsors including:

Junior Show Gold Sponsors:



Junior Show General Sponsor: Wisconsin Jersey Breeders Association, Elmhurst Guernsey

Supreme Champion of the Junior Show Cash Award: BouMatic

Supreme Champion of the Junior Show Trailer Award:
Frenchville Trailer Sales, LLC

Supreme Champion of the Junior Show Royal Blanket: Select Sires, Inc.

Reserve Supreme Champion of the Junior Show Cash Award:
Udder Comfort Inc.

Reserve Supreme Champion of the Junior Show
Royal Blanket: Ameriprint Apparel, LLC

Supreme Champion Heifer of the Junior Show
Michael Hellenbrand Memorial Trophy:
Michael Hellenbrand Memorial Fund

Supreme Champion Heifer of the Junior Show Cash Award:
Golden Calf Company

Supreme Champion Heifer of the Junior Show Royal Banner:
Scott & Nikki Culbertson

Reserve Supreme Champion Heifer of the Junior Show Cash Award:
Golden Calf Company

Reserve Supreme Champion Heifer of the Junior Show Royal Banner:
Ebert Enterprises LLC

Junior Show Grand Champion Sashes: New Holland

Junior Show Junior Champion Sashes: Duane T. Cole, DDS

Grand Champion of Junior Show Cash Awards: Udder Comfort Inc.

Junior Champion of the Junior Show Cash Awards:
Misty Meadow Dairy

Junior Show Neck Ribbons & Medallions:
Select Sires, Inc.

EXPO YOUR WAY

Customize your Expo experience with the WDE mobile event app!

CUSTOM SCHEDULE

View additional details and favorite events to create your custom schedule.

CATTLE & EXHIBITOR SEARCH

Search for your favorite animals or exhibitors to find them in the New Holland Pavilions or Cattle Tent.

DAIRY CATTLE SHOW RESULTS

Keep updated on the Dairy Cattle Show with real-time results on class winners and champions.

RAILBIRD JUDGING CONTEST

Submit your top four backtag numbers in each Railbird class to see how your placings match up against the official judge!

TRADE SHOW SEARCH & MAPS

Locate companies and products found in the Trade Show using the searchable list feature or with interactive maps.



Search "World Dairy Expo" in Google Play or the App Store to download or scan this QR code.



WORLD DAIRY EXPO 2023 SHOWRING SPONSORS



Accelerating

THE MODERN HERD



The Accelerated Genetics lineup is for the modern dairy producer, offering progressive genetics to create **healthy, efficient** and **adaptable** cows that perform well in every environment.

14H07804 MYLES, 14H07714 HURRICANE and 14H07770 HELIX
third lactation daughter group, Fertile Ridge Dairy LLC,
Mount Horeb, WI. Photo by Jordan.



614.873.4683 | www.accelgen.com

MYLES, HURRICANE and HELIX qualify for semen export to Canada.



The Ritchie Ripple Effect

Every Saved Drop Matters

The benefits of adding a Ritchie to your operation extend far beyond saving you time, money, and water. By choosing Ritchie, you'll conserve water, protect the land, and reduce energy to promote a healthier environment for generations to come. Learn how a more sustainable future starts with a drop of water at ritchiefount.com/sustainability.

**Stop by Ritchie booth #1405-1407
in the Exhibition Hall.**

Ritchie[®]
***Fresh Water
For Life***[™]

YOU CAN EXPECT MORE FROM Y-TEX®.

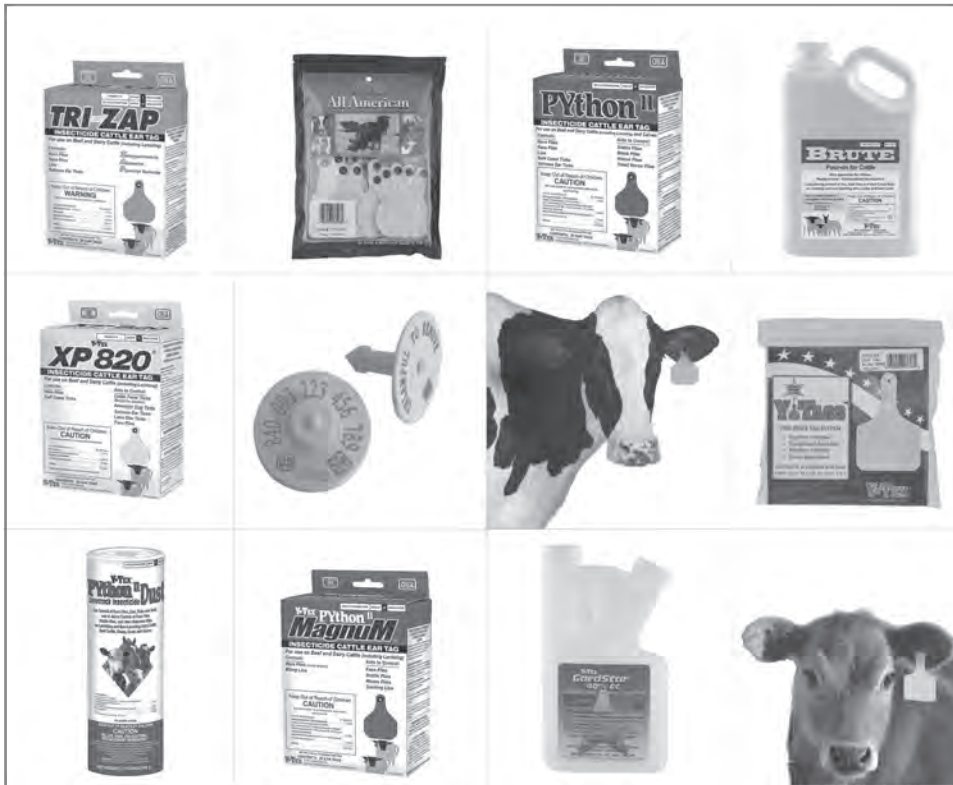

More in the way of the world's finest livestock identification and insecticide ear tags, including our advanced Y-Tags™ one-piece ID tags and TRI-ZAP™ insecticide tags. More livestock pest control options, like our BRUTE® Pour-On for Cattle, SwineGuard® Pour-On for Swine and GARDSTAR® Garden & Poultry Dust. And more quality equine products, like our popular TUTTLE'S® Liquid 747® feed supplement for horses.

Y•TEX®

EXCELLENCE IN ANIMAL HEALTH™

To learn more about Y-TEX products and our outstanding customer service, visit www.y-tex.com or call (888) 600-YTEX.

Y-TEX® is a registered trademark of Y-TEX Corporation. All brands pictured are either trademarks or registered trademarks of Y-TEX Corporation. © 2022 Y-TEX Corporation.

EXPO YOUR WAY

Customize your Expo experience with the WDE mobile event app!

CUSTOM SCHEDULE

CATTLE & EXHIBITOR SEARCH

DAIRY CATTLE SHOW RESULTS

RAILBIRD JUDGING CONTEST

TRADE SHOW SEARCH & MAPS



Search "World Dairy Expo" in Google Play or the App Store to download or scan this QR code.

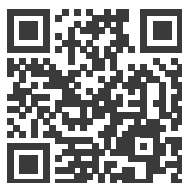

Holstein International

1 YEAR = 26 MAGAZINES!



1 year: **US\$ 88** ~~US\$ 98~~ **-10%**
 2 years: **US\$ 157** ~~US\$ 185~~ **-15%**



Subscribe online

AND USE DISCOUNT CODE: **HOL5WDE23**

www.holsteininternational.com

UDDER TECH



Visit us in the
Exhibition Hall
Booth EH 4412

**NEW
ITEMS!**

VET JACKET

**LONG SHOULDER
GUARD**



**FREE LONG SLEEVE SHIRT
WITH \$50 PURCHASE**

AT THE BOOTH AT WORLD DAIRY EXPO
WHILE SUPPLIES LAST

www.uddertechinc.com

Farmer Owned.
Co-op Crafted.



When the dinner bell rings, enjoy a

GRILLED CHEESE SANDWICH

made with AMPI's Dinner Bell
Creamery butter and cheese.



Learn more about our products and
the dairy farmers behind them at the
AMPI booth, Exhibition Hall #4407.

Scan the QR code for the growing list of
stores carrying Dinner Bell Creamery & learn
how to help add your local stores to this list.

www.dinnerbellcreamery.coop



PRO LAK[®] DAIRY

LACTIVATE[™]

..... TARGETED DAIRY NUTRITION



www.agpacknutrition.com

AND THEN THERE WAS ONE



A revolutionary leap in baler innovation with cutting-edge technology and advanced features. Capture real-time moisture and weight data which can be stored and analyzed through the John Deere Operations Center™, enabling you to make data-driven decisions and better manage your hay operation year after year. Whether you're working with dry hay or silage, the I Series Round Balers are designed to meet the demands of your operation.

Experience the future of baling at the John Deere exhibit.



JOHN DEERE

Extrutech Plastics, Inc.

Your One-Source Dairy Panel Supplier!!

BOOTH
EH 2814
World Dairy
Expo
OCT 3-6
Madison, WI

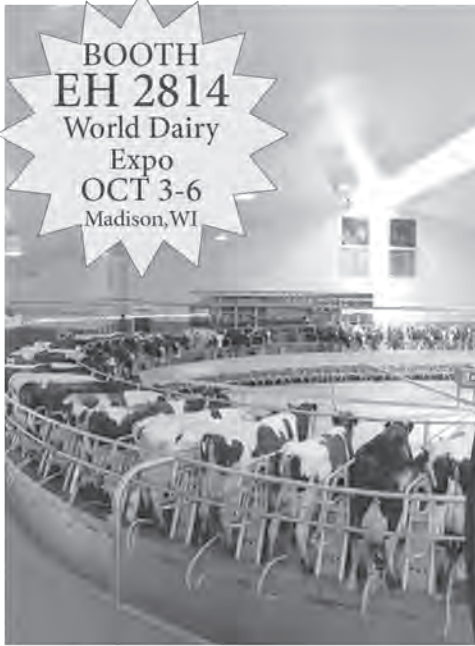

HOLY COW!
Those panels are bright!

P224
Partition
Wall Panels
24" Wide x 2-1/4" Thick

Available in
12", 16" and 24"
widths

ICC
ES
LISTED
ESR 4583

Interlocking
Liner Panels
P1300
P1600
P2400

P624
EXTRUTECH FORM® System
24" wide x 6" thick

EXTRUTECH FORM® System
24" wide x 8" thick

ICC
ES
LISTED
ESR 4250

P824

P1300

Panel colors: blue, yellow,
red, green, white, gray,
beige, and black

Custom sizes available

- Concrete Form System
- Water and corrosion-proof
- Panels will not rust, rot or flake
- Custom cut panel kits to 20 feet
- Cleans easily - low maintenance
- Brightens the interior of any building
- Fewer seams - 2 foot wide panels
- Resists mold, mildew, bacteria growth
- 6" and 8" thick stay-in-place concrete form
- Available in a bright white, high gloss, hard surface
- Low maintenance, easy-to-clean, with water/mild cleaner
- Protective film on both sides keeps panels clean during construction
- Wall and ceiling panels custom made to fit your building



Look for the EPI label on your panel orders. Made in the USA since 1992. That label assures you that, besides being all American made, our building products meet all code requirements and have been evaluated and approved by the International Code Council Evaluation Service (ICC-ES). Liner panels are CLASS-A for fire and smoke. We are committed to providing the best quality and safest building materials possible. ISO 9001:2015 QMS Certified. Panels and forms tested by Intertek testing for superior quality. Twenty year warranty on wall panels.



Visit our web site or give us a call to learn more about our many products shown here and how they will make your next project shine!

1,000s of Happy Customers Nationwide!

Ask for Extrutech and Get the Best Surface, Shine, and Strength in the Industry!



Extrutech Plastics, Inc.

Phone: 888-818-0118

www.epiplastics.com E-mail: info@epiplastics.com





Maximizing milk margins with a comprehensive approach

Exploring new feed technologies with proven results

Addressing profit leaks with on-farm consultation for optimized farm profitability

Solving your biggest challenges, together.

ADM is committed to helping dairy producers maximize milk margins through individualized, innovative nutritional programs specific to their farm. We take a comprehensive approach focusing on optimizing income over feed cost, and providing on-farm consultation to proactively address profit leaks. With advanced research and feed production facilities, ADM offers a comprehensive selection of ingredients, technologies, and services for every stage of the dairy herd.

**Visit us in the Exhibition Hall at World Dairy,
Booth EH 1611-1712**

adm.com/dairysolutions



STOP BY OUR BOOTH TO SEE THE PRODUCT SHOWN

CUSTOMER SERVICE IS OUR GOAL

KLEEN FLO ECO-WAVE AUTOMATIC BULK TANK CONTROLLER



The Eco-Wave Bulk Tank Controller is designed to cool and wash with a wide range for adjustable settings.

COOLING FEATURES

- Cooling cycles are adjustable
- Pre-cool option
- Agitator cycles are adjustable
- High temperature alarm

WASH FEATURES

- Up to six cycles can be programmed
- Unit can control all different types of drain systems (water pressure, electric, etc.)
- Up to three rinse cycles
- Wash cycles are adjustable
- Interface from 120/240 VAC to 24 VAC is available
- Screen shows cycle and time remaining in cycle
- Option to manually advance through program for ease of service
- LED lights indicate which outputs are active

*Partnering with you
in the dairy industry.*



3772 East Newport Rd
Gordonville, PA 17529

888.880.3993

877.204.7628

sales@ezmilking.com

www.EZMILKING.com

CLIPPER PARTS & REPAIR

IF IT CLIPS, WE CAN FIX IT!

AESCULAP



Authorized Aesculap
Distributor & Service Center.

andis



Heiniger
quality + swiss made



Yes we have
**GROUND
DOWN
BLADES**

Oster

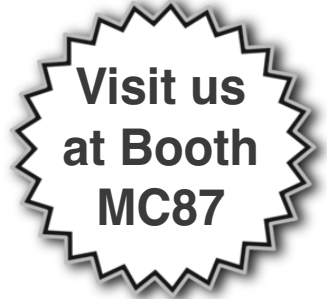

Visit us
at Booth
MC87

*Proud Sponsor of the
Youth Fitting
Contest*

 Find us on
Facebook
Clipper Parts & Repair

**TIM SOLLMAN • 897 1 3/8 STREET • CLAYTON, WI
715-641-1057 • CLIPRFIX@AMERYTEL.NET • WWW.CLIPITALL.NET**

Coburn®

Quality agricultural supplies
and milking equipment
SINCE 1925.



Milking Equipment

Barn Equipment

Cleaning & Sanitizing

Calf Raising

Animal Health

Feeding & Watering

Animal Care

Fencing

Farm & Home

Visit us at **WORLD DAIRY EXPO**

Booths EH 2801-2905 • EH 2703, 2704 • TC 440, 441



Scan to learn
more.



coburn.com



Class **605 Spring Heifer Calf**

Born 03/01/2023 - 05/31/2023

Premiums: \$100, 90, 80, 70, 60, 50, 40, 40, 35, 35, 30, 30, 25, 25, 20, 15, 10

1st Place Award and Bred & Owned Award presented by Red & White Dairy Cattle Association

Junior Premiums: \$25, 20, 20, 15, 15, 15, 10, 10, 10, 10

Junior Award presented by Road View Dairy Holsteins, the Yager Family, Mineral Point, WI

| | | | | |
|-----------------------------------|------------|-----|--|---|
| 2950 Mcgarr-Farms E Rum-Red-ET | 03/26/2023 | B&O | S-Riverdown Unstopabull-Red D-Ms Raps Ruby-Red-ET | Eoghan Daniel Mcgarr King Ferry NY |
| 2951 Intense Alpha Allie | 03/25/2023 | | S-Blondin Alpha D-Ms Apples Uno Acadia | Karnview Farms Woodstock, Ontario ON |
| *2952 Lakeshore Alt Emiri-Red | 03/17/2023 | B&O | S-Farnear Altitude-Red-ET D-Lakeshore Moovin Everest-ET | Taylor, Layla & Kaylyn Powell Tremont IL |
| *2953 Nk-Stef A-Superfreak-Red-ET | 03/15/2023 | | S-Farnear Altitude-Red-ET D-Kamps-Hollow Asenora-Red-ET | Molly Willenborg Vandalia IL |
| 2954 Nk-Stef War Tantrum-Red | 03/14/2023 | B&O | S-Mr Blondin Warrior-Red-ET D-Nk-Stef Unstpb1 Totally-Red | Nikole Steffenhagen Kenosha WI |
| 2955 Burlin A Hot Toddy-Red | 03/10/2023 | B&O | S-Mr Affection Analyst-Red-ET D-White-Light Hotsauce-Red-ET | Rowan Kiser Keymar MD |
| 2956 Thorgy-Way Stars Fire-Red | 03/10/2023 | B&O | S-Siemers Stars-ET D-Windleway Revme Farah-Red | Jackson Thorgerson Gilman WI |
| *2957 Heart-Broke War Astrid-Red | 03/08/2023 | B&O | S-Mr Blondin Warrior-Red-ET D-Cloverhill Viper Avery-Red | Dana & Madison Sickles Marengo IA |
| 2958 Jennings Gap W Amarillo Red | 03/07/2023 | B&O | S-Mr Blondin Warrior-Red-ET D-Jennings Gap Dback Anara | Chris and Jen Hill & Blake And Billie Jo Rhodes Thurmont MD |
| *2959 Siemers Altitud Twix-Red-ET | 03/07/2023 | | S-Farnear Altitude-Red-ET D-Strans-Jen-D Tequila-Red-ET | Chloe & Claire Lamb Oakfield NY |
| *2960 Wsc Warrior M&M-Red-ET | 03/07/2023 | | S-Mr Blondin Warrior-Red-ET D-Wsc Jordy Miss Me-Red-ET | Luke, Henry, Millicent Brasil Clear Spring MD |
| 2961 Betley Lets Get It-Red-ET | 03/06/2023 | | S-Riverdown Unstopabull-Red D-OCD Jo Lionking-Red-ET | L Moser, J Eggink, M Gregory, M Upchurch Hebron IL |
| *2962 Kress-Hill Sammi-Red-ET | 03/06/2023 | | S-Blondin Luxor-Red D-Kress-Hill Sapphire-Red-ET | Hayley Sleik Pickett WI |
| *2963 Betley Lilyana-Red | 03/05/2023 | | S-Farnear Altitude-Red-ET D-OCD Jo Lionking-Red | Evan, Alexa, Rosella, and Willem Brey Sturgeon Bay WI |
| 2964 Kamps-Rx-Db Afterparty-Red | 03/05/2023 | B&O | S-Riverdown Unstopabull-Red D-Kamps-Rx-Db Aftershow-Red | Reggie & Krysty Kamps & Dennis Bowers Darlington WI |
| 2965 Kress-Hill Shook-It-Red-ET | 03/05/2023 | | S-Dinomi Rebel D-Kress-Hill Shimmer-Red-ET | Ryan, Doeberienner, Bowen, Feldman, Cupid Cattle Company Fond Du Lac WI |

| | | | | |
|-----------------------------------|------------|-----|--|--|
| *2966 Hilrose Unstop Adha-Red-ET | 03/04/2023 | B&O | S-Riverdown Unstopabull-Red D-Hilrose Advent Anna-Red-ET | Bentley, Blake, Brodie & Kylie Brantmeier Hilbert WI |
| 2967 Ms-Aol Recut-Red-ET | 03/04/2023 | | S-Riverdown Unstopabull-Red D-Miss Roxys Recovery-Red | James & Janelle Hoffman Slippery Rock PA |
| 2968 Winright Believe Tallahassee | 03/04/2023 | B&O | S-Aija Believe-P-ET D-Milksource Defi Tazu-Red | Brian Joseph Enright and Jaquemet Holsteins Winchester ON |
| *2969 Zehrview Army Sweet Pea-Red | 03/04/2023 | B&O | S-Golden Oaks Srg Army-Red-ET D-Zehrview Rainy Sauve | Rosalee & Wyatt Zehr Graymont IL |
| *2970 Betley Lets Go-Red-ET | 03/03/2023 | | S-Farnear Architect-ET D-OCD Jo Lionking-Red-ET | Megan Moede Algoma WI |
| *2971 Betley Ooh Lala-Red-ET | 03/03/2023 | B&O | S-Farnear Architect-ET D-OCD Jo Lionking | Claire & Jacob Betley Pulaski WI |
| 2972 Egl-Acres War Lovebird-Red | 03/03/2023 | B&O | S-Mr Blondin Warrior-Red-ET D-Egl-Acres Jordy Lovejoy-Red | Emily G Lampson Castile NY |
| *2973 Kress-Hill Snazzy-Red-ET | 03/03/2023 | B&O | S-Farnear Altitude-Red-ET D-Ms Kress-Hil Sapphire-Red-ET | Owen & Kendyll Kress Newton WI |
| 2974 Malic Altitude Ana | 03/03/2023 | B&O | S-Farnear Altitude-Red-ET D-Malic Unstopabull Aya | Ferme Malic Lévis QC |
| 2975 Malic Altitude Anita | 03/03/2023 | B&O | S-Farnear Altitude-Red-ET D-Malic Unstopabull Alicia | Ferme Malic Lévis QC |
| 2976 Malic Altitude Aurelie | 03/03/2023 | B&O | S-Farnear Altitude-Red-ET D-Malic Unstopabull Anne-Laurie | Ferme Malic Lévis QC |
| 2977 Mcwilliams Shakira-Red-ET | 03/03/2023 | | S-Mr Blondin Warrior-Red-ET D-Mcwilliams Captial Z Susan | Madison Fisher & Triple-T Holsteins Frostburg MD |
| *2978 Ms.Phoenix War Paint-Red | 03/03/2023 | B&O | S-Mr Blondin Warrior-Red-ET D-Nic-K Defiant Phoenix | J & B krogman, K Mauer and B Brasch Ashton IA |
| 2979 Rougette Altitude Alexanne | 03/03/2023 | | S-Farnear Altitude-Red-ET D-Frankstyle Mirand Alexia Rae | Royal-Cut Genetics Chowchilla CA |
| 2980 So-Gen Warrior Lainey-Red | 03/03/2023 | B&O | S-Mr Blondin Warrior-Red-ET D-ZBW M Unst Listen Up-Red-ET | Courtney & Duncan Bailey Valley Falls NY |
| 2981 Trinal Unstopabull Topaz | 03/03/2023 | | S-Riverdown Unstopabull-Red D-Trinal Ammo-P Typhoon | London Dairy Farms London ON |
| *2982 Bella-Ridge Wr Madrigal-Red | 03/02/2023 | B&O | S-Mr Blondin Warrior-Red-ET D-Bella-Ridge Majestic Apple | J, L & M Harbaugh and A & A Loehr Eden WI |
| *2983 BFWF-AB Warr Alma-Red-ET | 03/02/2023 | B&O | S-Mr Blondin Warrior-Red-ET D-Ms Apple Andorra-Et Rc | E, I & E Staudinger and L & L Kuester Reedsville WI |
| *2984 Crescentmead Justjoy-Red-ET | 03/02/2023 | B&O | S-Farnear Altitude-Red-ET D-Go-Big Diamond Jus Cuz-Red | Lane Wendorf Ixonix WI |

| | | | | |
|--|------------|-----|---|---|
| *2985 Ka-Brat Unstop Lona-Red | 03/02/2023 | B&O | S-Riverdown Unstopabull-Red D-Magees-Pride Jrdy Lexington | T Bratcher, H & H Spoonamore and A Carrier Stanford KY |
| 2986 MD Hillbrook Inspire-Red-ET | 03/02/2023 | | S-Farnear Altitude-Red-ET D-DJ-Purepride Infra-Red-ET | Brian & Becky Mcgee & Vickie Roudabush Clearfield PA |
| 2987 Red Carpet Intime Maddie-Red-ET | 03/02/2023 | B&O | S-Red Carpet Blizard Intime-ET D-Red Carpet Db Disney-Red-ET | Johnathan Heinsohn, Matt and Molly Sloan Marshall WI |
| 2988 Claquato Apple Martini-Red | 03/01/2023 | | S-Riverdown Unstopabull-Red D-Claquato Apple Blossom-Red | Rick Kaut Winlock WA |
| *2989 Curr-Vale Warr Abby-Red-ET | 03/01/2023 | | S-Mr Blondin Warrior-Red-ET D-Curr-Vale Con Audria-Red-ET | Makayla & Kaleb Osinga Hico TX |
| 2990 Flower-Brook Ginn-Red-ET D-03-03 275 24,658 3.9% 973 3.2%P 796P | 03/01/2023 | B&O | S-Mr Blondin Warrior-Red-ET D-Flower-Brook Alt Gin-Red | Andrew Stuewe Hamburg MN |
| 2991 Lantland El Derado-Red | 03/01/2023 | B&O | S-Ken-Am Hypno Dalton-Red D-Lantland Unstop El Camino-Red | Kirt Menzi Jr. Millport NY |
| *2992 Lick-Spring Bw Heart-Red | 03/01/2023 | | S-Mr Blondin Warrior-Red-ET D-Lick-Spring Awsm Hunter-Red | Elizabeth Sutton Sun City FL |
| 2993 Lonely-Mile Rom Karuba-Red | 03/01/2023 | B&O | S-Trent-Way-Js Rompen-Red-ET D-Lonely-Mile A Latte-Red | Jeff & Jill Pinter Medford WI |
| *2994 Lyons-DI Analyst Rosie-Red D-05-00 305 21,382 4.8% 1,024 3.2%P 677P | 03/01/2023 | B&O | S-Mr Affection Analyst-Red-ET D-Lyons-DI Velvet-Red | Michael D. Lyons Castalia IA |
| *2995 M-Divine W Lady Jane-Red-ET | 03/01/2023 | B&O | S-Golden-Oaks War Chant-ET D-M-Divine Jordy Lulu | Cooper Merrill Fayette NY |
| *2996 Ms Latenite Allie-Red | 03/01/2023 | | S-Avant-Garde-I Latenite-Red-ET D-Jennings-Gap Allie-Red-ET | Brayden Carpio and Kiliana Breuer Kersey CO |
| *2997 Road-View Over Addicted-Red | 03/01/2023 | B&O | S-Jeffrey-Way Symbol-Red D-Road-View Hancock 2062 | Haylee and Grant Yager Mineral Point WI |
| 2998 Stolhaven Jrd Alaina-Red | 03/01/2023 | | S-Cycle McGucci Jordy-Red D-Ms Apple Andringa-Red | Markhill Farms Ltd Ingersoll ON |
| 2999 Synergy Sconnie RED-ET | 03/01/2023 | | S-Mr Affection Analyst-Red-ET D-Synergy Always Smokin-Red | Gary Breitlow Algoma WI |
| *3000 Topp Guns War Happening-Red | 03/01/2023 | | S-Mr Blondin Warrior-Red-ET D-My-Type Jdy Holland-Red-ET | Kale, Kley, Ryan, Logan Beer Berne IN |

Class **606 Winter Heifer Calf**

Born 12/01/2022 - 02/28/2023

Premiums: \$100, 90, 80, 70, 60, 50, 40, 40, 35, 35, 30, 30, 25, 25, 20, 15, 10

1st Place Award presented by MB Lucky Lady Farm, Frank & Diane Borba and Family, Modesto, CA

Bred & Owned Award presented by Red & White Dairy Cattle Association

Junior Premiums: \$25, 20, 20, 15, 15, 15, 10, 10, 10, 10

Junior Award presented by Mead-Manor, Algoma, WI

| | | | | |
|-----------------------------------|------------|-----|--|--|
| 3001 Banowetz Dobber Aspire-Red | 01/11/2023 | B&O | S-Sco-Lo Dice Dobber 2396-ET D-Ms Banowetz Dmnd Apocalypse | Levi, Kailey & Shawn Banowetz Charlotte IA |
| *3002 Kiefland Prodigy-Red | 01/11/2023 | B&O | S-Jacobs Showtime-ET D-Kiefland Pandoras Box | Brea, Ava & Bryson Kieffer Utica MN |
| 3003 Ms Luxor Circus Clown | 01/11/2023 | | S-Blondin Luxor-Red D-Graber Warrior Chilli-Red | Reyncrest Farm and Fly-Higher Holsteins Corfu NY |
| *3004 Quad-R Shwtm Moscato-Red | 01/04/2023 | B&O | S-Jacobs Showtime-ET D-Quad-R Addictn-P Merlot-Red | Ian & Derek Schwartzlow Monroe WI |
| *3005 Dorloy-K Golden Girl-Red-ET | 01/02/2023 | | S-Riverdown Unstopabull-Red D-Ms Trikoebel Glamour-Red-ET | Kenlee Phillips Lingleville TX |
| *3006 Kress-Hill Shazam-Red-ET | 12/31/2022 | B&O | S-Farnear Altitude-Red-ET D-Ms Kress-Hil Sapphire-Red-ET | Owen & Kendyll Kress Newton WI |
| *3007 Hoosier-Star A Ladyluck-Red | 12/20/2022 | | S-Farnear Altitude-Red-ET D-Hoosier-Star Lydia | Jordan Kuhn Wawaka IN |
| *3008 Betley Warrior Lynx-Red | 12/17/2022 | | S-Mr Blondin Warrior-Red-ET D-Betley Lionlike-Red-ET | Kamryn, Kate & Colt Kasbergen Tulare CA |
| 3009 Brook Hollow Spicy Hot-Red | 12/17/2022 | B&O | S-Blondin Cheerful D-Miss Tamales Hot Salsa-ET | Delbert & Heather Yoder West Salem OH |
| *3010 Ms Redeye Afterparty-Red-ET | 12/17/2022 | | S-Vogue Redeye-P-Red D-Milksource Byway Affection | Ava Grace Hebgen and Avery Best Deforest WI |
| *3011 Kress-Hill Shine-Red-ET | 12/16/2022 | | S-Mr Affection Analyst-Red-ET D-Kress-Hill Shimmer-Red-ET | Hayley Sleik Pickett WI |
| 3012 Oakfield Ava Lava-Red-ET | 12/13/2022 | B&O | S-Dymenthalm Mr App Avalanche-TW D-Kevetta Rdbrst Lucious-Red | Chase & Alexis Cashell and Oakfield Corners Dairy Oakfield NY |
| *3013 Betley Lets Party-Red-ET | 12/12/2022 | B&O | S-Riverdown Unstopabull-Red D-OCD Jo Lionking | Claire & Jacob Betley Pulaski WI |
| *3014 Cherry H&S A Rio-Red-ET | 12/12/2022 | | S-Dymenthalm Mr App Avalanche-TW D-Cherry-Lor Ladd Ripple-Red | Luke Tanis Millmont PA |
| 3015 Excelerant Wr Philly-Red-ET | 12/12/2022 | | S-Mr Blondin Warrior-Red-ET D-Windy-Knoll-View Philly-Red | Emma Mulhern Fountain MN |
| *3016 Hilrose Unstop Adela-Red-ET | 12/12/2022 | B&O | S-Riverdown Unstopabull-Red D-Hilrose Advent Anna-Red-ET | Bentley, Blake, Brodie & Kylie Brantmeier Hilbert WI |

| | | | | |
|---|------------|-----|---|--|
| 3017 Riedel-Ridge Party-Red-ET | 12/10/2022 | B&O | S-Riverdown Unstopabull-Red D-Sorg-Land Redneck Party-Red | Taylor & Kelsey Riedel Pardeeville WI |
| *3018 Ms B-J-Grove Alpaca-Red D-02-02 305 21,761 3.8% 828 3.2%P 703P | 12/09/2022 | B&O | S-Blondin Luxor-Red D-Schluter Altitude Ava-ET | Kasey Clanton & Olivia Schluter Mulberry Grove IL |
| 3019 Malic Ponde Dianna-Red | 12/08/2022 | B&O | S-Farnear Altitude-Red-ET D-Malic Ponde Dianna | Ferme Malic Lévis QC |
| 3020 Johnson-Five Al Pipa-Red-ET | 12/07/2022 | | S-Farnear Altitude-Red-ET D-ZBW-Bna War Paint-Red | Benjamin & Jennifer Wallace and Steve Mcdonald Stoughton WI |
| *3021 Kings-Ransom Warr Rosie-Red | 12/07/2022 | B&O | S-Mr Blondin Warrior-Red-ET D-Cookiecutter Rosalie-Red | Hannah King Schuylerville NY |
| *3022 Redcarpet War Cathy-Red-ET | 12/07/2022 | | S-Mr Blondin Warrior-Red-ET D-L-Maples Advent Cait-Red | Weston Taylor Allenwood PA |
| *3023 Wapsi-Ana Warrior Bliss-Red | 12/07/2022 | | S-Mr Blondin Warrior-Red-ET D-Hardwood Agent Breala-Red | Mercedes & Jade Kroll and Alexys Gaedtko Luxemburg WI |
| *3024 Hillrose Unstop Afro-Red-ET | 12/06/2022 | | S-Riverdown Unstopabull-Red D-Hillrose Advent Anna-Red-ET | Katie Osinga Hico TX |
| *3025 Jakks Analyst Comet-Red-ET | 12/06/2022 | | S-Mr Affection Analyst-Red-ET D-Intense Jordy Camille-Red-ET | J D Brown II Gretna VA |
| *3026 Vir-Clar Chardonnay-Red-ET | 12/06/2022 | B&O | S-Mr Blondin Warrior-Red-ET D-Lyn-Vale Cherry Wine-Red-ET | C, K, & G Grinstead G & J Boyke F WI |
| *3027 Vir-Clar W Coco Puff-Red-ET | 12/06/2022 | B&O | S-Mr Blondin Warrior-Red-ET D-Lyn-Vale Cherry Wine-Red-ET | C, K, & G Grinstead G & J Boyke F WI |
| 3028 Blondin Cheerful Lipstick-Red | 12/05/2022 | | S-Blondin Cheerful D-Blondin Avalanche Lovelyn | Makenzie & Callen Ferris Soap Lake OR |
| *3029 Empty-Pockets War Icu-Red | 12/05/2022 | B&O | S-Mr Blondin Warrior-Red-ET D-Empty-Pockets Db Its Me-Red | Elizabeth Thyen Grove City MN |
| *3030 Mcwilliams Reba-Red-ET | 12/05/2022 | | S-Mr Blondin Warrior-Red-ET D-Mcwilliams Captial Z Susan | Adison , Emori, Kaelyn , Kanadie Machado Clear Spring MD |
| *3031 Miller-Farm War Glory-Red | 12/05/2022 | B&O | S-Mr Blondin Warrior-Red-ET D-Dorloy-K Artst Glaxy-Red-ET | Danielle Haley Miller Baltimore OH |
| *3032 Red-Violet W Imma Be-Red-ET | 12/05/2022 | | S-Mr Blondin Warrior-Red-ET D-Pamprd-Acres Ab Ivy-Red | Mallory R Nifong and Jemma Jean Obert Burlington WI |
| 3033 Red-Violet W Ivanka-Red-ET | 12/05/2022 | | S-Mr Blondin Warrior-Red-ET D-Pamprd-Acres Ab Ivy-Red-ET | Johnathan King & Emily Mikel Schuylerville NY |
| 3034 Twist-View Warrior 6089-Red | 12/05/2022 | B&O | S-Mr Blondin Warrior-Red-ET D-Twist-View Diamond Fin-Red | Chris Schulze Holland MN |
| *3035 Cache-Valley Halsey-Red-ET | 12/04/2022 | B&O | S-Mr Blondin Warrior-Red-ET D-Cache-Valley Def Haizly-Red | Xander Harris Richmond UT |

| | | | | |
|-----------------------------------|------------|-----|--|---|
| *3036 Tree-Hayven Secrets Out-Red | 12/04/2022 | | S-Mr Blondin Warrior-Red-ET D-Ms Treehayven Secret-Red-ET | Grace Johnsrud Auburndale WI |
| *3037 Bay-View Doral Arrow-Red | 12/03/2022 | | S-Stgen Doral-Red-ET D-Luck-E Unstpbll Amen-Red-ET | Chloe Lacrosse Forestville WI |
| *3038 Forge Hollow Pixie-Red | 12/03/2022 | | S-Avant-Garde-I-Latenite-Red-ET D-Forge-Hollow Piper-Red | Ben Zeller Richland PA |
| 3039 Gahm-Ozroyal Alt-Tamika-Red | 12/03/2022 | B&O | S-Farnear Altitude-Red-ET D-Golden-Oaks Mv Taiga-Red-ET | Robert Gallivan and Daryld Gahm Dyersville IA |
| 3040 Kamy Alt Adeline-Red-ET | 12/03/2022 | | S-Farnear Altitude-Red-ET D-Hilrose Avalnch Addy-Red-ET | Genetics Link Berlin PA |
| *3041 King-Street Ready2Rumbl-Red | 12/03/2022 | | S-Riverdown Unstopabull-Red D-Ms Wolford D Raspberry-Red | B & C Rupprecht and Cassandra Gebert Wawaka IN |
| 3042 Liddleholme Sunbeam-Red-ET | 12/03/2022 | | S-Farnear Altitude-Red-ET D-Budjon-Vail HP Ab Season-ET | Maple-Downs Farms II and Peter Vail Middleburgh NY |
| *3043 Lyn-Vale Luxor Poppy-Red | 12/03/2022 | | S-Blondin Luxor-Red D-Lyn-Vale Jordy Paprika-Red | Kaleb Osinga & Henry Osinga Hico TX |
| 3044 Ms Latenite Mad Cash-Red-ET | 12/03/2022 | B&O | S-Avant-Garde-I Latenite-Red-ET D-Opsal Mad At Me-Red-ET | Emily Lampson and Dalton Cook Castile NY |
| *3045 Flower-Brook Dimple-Red-ET | 12/02/2022 | | S-Mr Blondin Warrior-Red-ET D-Flower-Brook Diamond-Red-ET | Sophie J & Lexi Schaefer Galesville WI |
| 3046 Jacobs Unstopabull Lisly-Red | 12/02/2022 | B&O | S-Riverdown Unstopabull-Red D-Jacobs Diamondback Lisan | Ferme Jacobs Inc. Cap-Sante QC |
| 3047 Quietcove Alt Mojo-ET | 12/02/2022 | | S-Farnear Altitude-Red Et D-Quietcove-Edge Pop Quiz | Quietcove, Silver-Mist, T Cummings & C Mccumons Wapakoneta OH |
| 3048 Westcoast Red Diamond | 12/02/2022 | B&O | S-Mr D Apple Diamondback D-Westcoast Defiant Addison | Westcoast Holsteins Chilliwack BC |
| 3049 Wilnore Fireball-Red | 12/02/2022 | B&O | S-Mr Blondin Warrior-Red-ET D-Wilnore Diamondback Dasher | Mcnally Farms Milton WI |
| *3050 Zehrview Army Sandi-Red | 12/02/2022 | B&O | S-Golden Oaks Srg Army-Red-ET D-Zehrview Add-P Snowie-Red | Wyatt Zehr Graymont IL |
| 3051 Ak-Philips Tailor-Md-Red-ET | 12/01/2022 | | S-Farnear Altitude-Red-ET D-Ak-Philips Tickle Me Elmo | Kurt Wolf New Bavaria OH |
| *3052 Bella-Ridge Gns Alspice-Red | 12/01/2022 | B&O | S-Mr Blondin Warrior-Red-ET D-Bella-Ridge Gins Addict-ET | J, L & M Harbaugh and A & A Loehr Marion WI |
| *3053 Durkacres Real Jelly-Red | 12/01/2022 | | S-Mr Goldenrose Realritzi-Red D-Durkacres Appl Juice-Red-ET | Wyatt Chambers Tunbridge VT |
| *3054 Hol-Strine Alt Adele-Red-ET | 12/01/2022 | | S-Farnear Altitude-Red-ET D-Schluter Un Ambrosia-Red-ET | Brady Willenborg Vandalia IL |

| | | | | |
|--|------------|-----|--|--|
| *3055 Kamy Alt Anabel-Red-ET | 12/01/2022 | | S-Farnear Altitude-Red-ET D-Hilrose Avalnch Addy-Red-ET | Mercedes & Jade Kroll and Alexys Gaedtk Luxemburg WI |
| *3056 KCKK Luxr Chardonnay-Red-ET | 12/01/2022 | | S-Blondin Luxor-Red D-Golden-Oaks Cherry-Red-ET | Brea, Ava & Bryson Kieffer Utica MN |
| 3057 Muetherthies Debbie-Red-ET | 12/01/2022 | | S-Mr Blondin Warrior-Red-ET D-Red Hot Racht Delight-Red | Dakota Voegeli-Paulson & Suton Paulson Rockford IL |
| 3058 Pineybrook Wchant Foxy-Red | 12/01/2022 | | S-Golden-Oaks War Chant-ET D-Pineybrook Jordy Flare-Red | Jordan London & Lawrence A Tobin Punxsutawney PA |
| *3059 Rock-Edge Wr Rhinestone-Red | 12/01/2022 | B&O | S-Mr Blondin Warrior-Red-ET D-Rock-Edge Jordy Ruby-Red | Nicole Broege Janesville WI |
| *3060 W-Pine-Grove Hypn Rosie-Red | 12/01/2022 | B&O | S-Mr Hotstuffs Hypnotic-ET D-Trent-Way Unstp Reba-Red | Randy, Wesley & Matthew Winch Fennimore WI |
| 3061 Winright Alt Tsunami-Red-ET | 12/01/2022 | | S-Farnear Altitude-Red-ET D-Milksource Defi Tazu-Red-ET | Brian Coyne and Patrick Crave Waterloo WI |
| Class 607 Fall Heifer Calf | | | | |
| Born 09/01/2022 - 11/30/2022 | | | | |
| Premiums: \$100, 90, 80, 70, 60, 50, 40, 40, 35, 35, 30, 30, 25, 25, 20, 15 | | | | |
| 1st Place Award presented by Lyons Holsteins, Doug & Lynnette Lyons and Family, Castalia, IA | | | | |
| Bred & Owned Award presented by Red & White Dairy Cattle Association | | | | |
| Junior Premiums: \$25, 20, 20, 15, 15, 15, 10, 10, 10, 10 | | | | |
| Junior Award presented by Elon Holsteins, the Fossum Family, Lodi, WI | | | | |
| *3062 Mow-Ten-Vue War Eclipse-Red | 11/17/2022 | | S-Mr Blondin Warrior-Red-ET D-Mow-Ten-Vue Rr Electron-Red | Abby Porte Charlo MT |
| 3063 Jacobs Unstopabull Limace-Red | 11/03/2022 | B&O | S-Riverdown Unstopabull-Red D-Jacobs Diamondback Lisan | Ferme Jacobs Inc. Cap-Sante QC |
| | | | D-04-01 305 30,527 3.8% 1,164 3.1%P 944P | |
| 3064 Jacobs Unstopabull Lisa-Red | 10/31/2022 | B&O | S-Riverdown Unstopabull-Red D-Jacobs Diamondback Lisan | Ferme Jacobs Inc. Cap-Sante QC |
| | | | D-04-01 305 30,527 3.8% 1,164 3.1%P 944P | |
| | | | 365 35,565 3.8% 1,340 3.1%P 1,105P | |
| 3065 Maples Miss Monroe-Red | 10/14/2022 | | S-Farnear Altitude-Red-ET D-Blondin Unstopabu Maple-Red | Budjon Farms, Peter Vail, Heartland Dairy and Genosource Lomira WI |
| *3066 Malic Ponde Delicious-Red | 10/01/2022 | | S-Farnear Altitude-Red-ET D-Malic Ponde Debi-Red-ET | Kenlee Philips Lingleville TX |
| 3067 Thorgy-Way Alt Bliss-Red | 09/29/2022 | B&O | S-Farnear Altitude-Red-ET D-Budjon-Vail Warrior Bree | Derek A Thorgerson Gilman WI |
| 3068 Lady Luck Us Fortune-Red | 09/26/2022 | B&O | S-Riverdown Unstopabull-Red D-Uber-Haven Freedom Warr-Red | Vanessa Philson Farmdale OH |
| *3069 Betley Love N War-Red-ET | 09/24/2022 | B&O | S-Mr Blondin Warrior-Red-ET D-OCD Jo Lionking-Red-ET | Claire & Jacob Betley Pulaski WI |

| | | | | |
|--------------------------------------|------------|-----|--|---|
| 3070 Macs-BHF Warrior Dollop-Red | 09/24/2022 | B&O | S-Mr Blondin Warrior-Red-ET D-Macs-Bhf J Dixie-Red | D & H Yoder and S & T McMahan West Salerm OH |
| *3071 Magees-Pride Wr Wynonna-Red | 09/22/2022 | B&O | S-Mr Blondin Warrior-Red-ET D-Magees-Pride Dback Mamba | Brooke Bennett Cynthiana KY |
| 3072 Golden-Oaks Rebekah-Red-ET | 09/17/2022 | B&O | S-Avant-Garde-I Latenight-Red-ET D-Milksource Renaissance-Red | Golden Oaks Farm Wauconda IL |
| *3073 Cherry-Lor War Ricki-Red | 09/15/2022 | | S-Mr Blondin Warrior-Red-ET D-Cherry-Lor Jordy Ripa-Red | Phillip McCormick Muncy PA |
| *3074 Gildale Aval Scarlet-Red-ET | 09/14/2022 | B&O | S-Dymenthalm Mr App Avalanche-TW D-Gildale Aso Atractiv-Red | J Judd, M Deaver, E Gilbertson & J Morrison Hollandale WI |
| *3075 Luck-E Anlst Beautif-Red-ET | 09/14/2022 | | S-Mr Affection Analyst-Red-ET D-Luck-E Doc Bopeep | Emma England Murtaugh ID |
| 3076 Mcgarr-Farms E Royal-Red-ET | 09/14/2022 | | S-Riverdown Unstopabull-Red D-Ms Raps Ruby-Red-ET | Chase & Alexis Cashell and Evan Castrogiovanni Oakfield NY |
| 3077 Ms Warrior Allison-Red-ET | 09/10/2022 | | S-Mr Blondin Warrior-Red-ET D-Apple-Pts Astonish-Red-ET | Makenzie & Callen Ferris Soap Lake OR |
| *3078 Wocc Unstopabull Aubrey-Red | 09/09/2022 | | S-Riverdown Unstopabull-Red D-Kamps-Hollow Affluent-Red | Neil Willenborg Vandalia IL |
| 3079 Banowetz Dobr Monaco-Red-ET | 09/08/2022 | B&O | S-Sco-Lo Dice Dobber 2396-ET D-Ms Banowetz Awsome Minimosa | Levi, Kailey & Shawn Banowetz Charlotte IA |
| *3080 Golden-Oaks Rachel-Red-ET | 09/07/2022 | | S-Mr Blondin Warrior-Red-ET D-Milksource Renaissance-Red | J, L & M Harbaugh and A & A Loehr Marion WI |
| *3081 Sunkist Warrior Lex-Red | 09/07/2022 | | S-Mr Blondin Warrior-Red-ET D-Sunkist Doorman Lennox | Jordyn Dingles Northfield MN |
| *3082 Bierecrest Rdl Crapshoot-Red | 09/06/2022 | | S-Brookview Redlight-Red D-Glaustar Roll A Dice-Red | Delaney,Kalli & Cooper Barber & Sophie Leach Dewitt IA |
| *3083 Bucks-Pride Journey Joy-Red | 09/06/2022 | | S-Cycle Jails Journey-Red-ET D-Bucks-Pride-Redlite Iva-Red | Brady & Bentley Cole Bloomville OH |
| 3084 Milksource Kiwi-Red-ET | 09/06/2022 | B&O | S-Mr Blondin Warrior-Red-ET D-Milksource Absolut Klue-Red | Milk Source Genetics Kaukauna WI |
| *3085 Siemers Warrior Tiara-Red-ET | 09/06/2022 | | S-Mr Blondin Warrior-Red-ET D-Strans-Jen-D Tequila-Red-ET | Colton Uber & Leah Higgenbotham Adamsville PA |
| 3086 Seavalley Ralanes Mia Khalifa | 09/05/2022 | | S-Mr Blondin Warrior-Red-ET D-Clarkvalley Apple Crisp-Red | Tyler Carter, Thorman, Schluter, & Reed Greenville IL |
| 3087 Winright Altitude Taco | 09/05/2022 | B&O | S-Farnear Altitude-Red-ET D-Milksource Defi Tazu-Red | Brian Joseph Enright and Jaquemet Holsteins Winchester ON |
| *3088 Riverdown Thats Naughty-Red-ET | 09/04/2022 | | S-Mr Blondin Warrior-Red-ET D-Cherry Crest Thats Neat | Wyatt Chambers Tunbridge VT |

| | | | | |
|-------------------------------------|------------|-----|---|--|
| *3089 Royal-Cut Arst Monroe-Red | 09/04/2022 | | S-Luck-E Arisocrat-Red D-Royal-Cut Unst Julie-Red-ET | Logan & Lauren Silveira Chowchilla CA |
| *3090 Wocc Warrior Edith-Red | 09/04/2022 | | S-Mr Blondin Warrior-Red-ET D-Merriwin Jordy-Ethel-Red | J L & M Harbaugh and D & C Ryan Marion WI |
| *3091 Cherry-Lor Robin P-Red | 09/03/2022 | | S-Cycle Jails Journey-Red-ET D-Cherry-Lor Dbk Robin-Red-ET | Bethany Eberlin Muncy PA |
| 3092 Extramile Cp A Wedding Vow | 09/03/2022 | B&O | S-Mr Blondin Warrior-Red-ET D-Westcoast Crown Asparagus P | Extramile Farm Keene ON |
| 3093 Garay-Md-Wvg Bria-Red-ET | 09/03/2022 | | S-Mr Affection Analyst-Red-ET D-Willowhaven Goldwyn Bliss-ET | Andrew Reynolds and Whitney Kugler Corfu NY |
| *3094 Ms Wocc Warrior Regina-Red | 09/03/2022 | | S-Mr Blondin Warrior-Red-ET D-Ms Revive Reggae-Red-ET | Hailey Abraham Harvard IL |
| *3095 Oakfield Elusive-Red-ET | 09/03/2022 | | S-Riverdown Unstopabull-Red D-Oakfield Addictio Emoji-Red | Rachel Van Buren Lowville NY |
| 3096 Clarkvalley Warrior Lucky Rose | 09/02/2022 | | S-Mr Blondin Warrior-Red-ET D-London Dairy Lolli-Red | William H Schilling Woodville ON |
| 3097 Malic Ponde Diana | 09/02/2022 | B&O | S-Mr Blondin Warrior-Red-ET D-Malic Ponde Dana-Red | Ferme Malic Lévis QC |
| 3098 Miley Warrior Galore-Red | 09/02/2022 | | S-Mr Blondin Warrior-Red-ET D-Miley Addiction Gladi-Red-ET | Jesse Lee Muse Etoile KY |
| *3099 Ms Giltex Alt Pansy-Red-ET | 09/02/2022 | B&O | S-Farneck Altitude-Red-ET D-Agresti Absolute Pure | Jon & Chloe Chapman and Alexis & Nichole Teixeira Turlock CA |
| *3100 Ms Revive Recharge Red-ET | 09/02/2022 | | S-Kck Amaretto-Red D-Ms-Aol Cntndr Resvive-Red-ET | Carter Kruse Dyersville IA |
| *3101 Ms-Aol Redesign-Red-ET | 09/02/2022 | | S-Jacobs Showtime-ET D-Miss Roxys Recovery-Red | J D Brown II Gretna VA |
| 3102 Robdot WI Warrior Satin | 09/02/2022 | | S-Mr Blondin Warrior-Red-ET D-Kingsway Altitude Shaniqua | Brian Joseph Enright Winchester ON |
| 3103 Roput Ron Bur-Red Sage-Red | 09/02/2022 | B&O | S-Cycle Ron Burgundy-Red-ET D-Roput Aristocrat Sage-Red | James R. Putman Heuvelton NY |
| 3104 Siemers Al Hot 39046-Red-ET | 09/02/2022 | | S-Farneck Altitude-Red-ET D-Heatherstone Redhot-Red | Wadeland-Jh Dyersville IA |
| *3105 Brigeen A Breanna-Red | 09/01/2022 | | S-Brabantdale Allegiant-P-ET D-Brigeen Flamingo Breanna | Sydney Bullard Turner ME |
| 3106 Carpsview Mvn Hollaback-Red | 09/01/2022 | B&O | S-Lindenright Moovin-ET D-Ms Carpsview Jr Holland-Red | Mckenzie & Briar Carpenter Sutton VT |
| 3107 Hodglynn Warrior Mariah | 09/01/2022 | | S-Mr Blondin Warrior-Red-ET D-Kawartha Armani Memory | Karnview Farms, Anthony Peatling Woodstock, Ontario ON |

| | | | | |
|--|------------|-----|---|---|
| 3108 Kamps-Rx Apb Arieja-Red-ET | 09/01/2022 | B&O | S-Aija Believe-P-ET D-KHW Regment Apple B-Red-ETN | Reggie & Krysty Kamps & Dennis Bowers Darlington WI |
| *3109 Lyons-DI Acat Magella-Red | 09/01/2022 | B&O | S-Luck-E Arisotcrat-Red D-Lyons-DI Amaretta Maren-Red | Michael D. Lyons Castalia IA |
| *3110 Tigerlea Rag Reflection-Red | 09/01/2022 | B&O | S-Cherry-Lor Unst Riptide-Red D-Tiger-Lily Jo Ragan-Red-ET | Lily Marshman Oxford NY |
| Class 608 Summer Yearling Heifer | | | | |
| Born 06/01/2022 - 08/31/2022 | | | | |
| Premiums: \$100, 90, 80, 70, 60, 50, 40, 40, 35, 35, 30, 30, 25, 25, 20 | | | | |
| 1st Place Award presented by International Protein Sires, Rock Springs, WI | | | | |
| Bred & Owned Award presented by Red & White Dairy Cattle Association | | | | |
| Junior Premiums: \$25, 20, 20, 15, 15, 15, 10 | | | | |
| Junior Award presented by Mystic Valley Dairy, LLC, Sauk City, WI | | | | |
| 3111 Karnview Warrior Lassi-Red | 07/17/2022 | B&O | S-Mr Blondin Warrior-Red-ET D-Chakelburg Jordy Lasso | Karnview Farms Woodstock, Ontario ON |
| *3112 Martin-Place War Tribe-Red | 07/09/2022 | | S-Mr Blondin Warrior-Red-ET D-Martin-Place Rlight Tiktok | Jaydn & Kennedy Kimball Windham ME |
| 3113 Karnview Warrior Snappy-Red | 07/08/2022 | | S-Mr Blondin Warrior-Red-ET D-J-Star Calaway Apple Snapple | Caden Finley & J Dowsell Farms Ltd. Woodville ON |
| 3114 Sunnybend After Me-Red-TW | 07/05/2022 | B&O | S-Cycle McGucci Jordy-Red D-Opstal Dfnt Adore Me-Red-ET | Jacalyn Bortner York PA |
| 3115 Miley Warrior Gentle-Red | 06/23/2022 | B&O | S-Mr Blondin Warrior-Red-ET D-Miley Jordy Gretta-Red | Miley Holstein Farms West Salem OH |
| *3116 Kara-Kesh-RK War Satine-Red | 06/21/2022 | B&O | S-Mr Blondin Warrior-Red-ET D-Kara-Kesh-RK Jacot Selene | Curtis, Evelyn & Agnes Griffin Thief River Falls MN |
| 3117 Kingsway Road Warrior | 06/18/2022 | | S-Mr Blondin Warrior-Red-ET D-Apple-Pts Aysha-Red-ET | Jamie Judd and Mike Deaver LaValle WI |
| *3118 Cherry-Lily Alt Silk-Red-ET | 06/16/2022 | B&O | S-Farnear Altitude-Red-ET D-Long-Brook RI Sweetie Pi-Red | Lily Marshman Oxford NY |
| 3119 Hilrose Altude Abner-Red | 06/15/2022 | B&O | S-Farnear Altitude-Red-ET D-Hilrose Advent Anna-Red-ET | Joseph Brantmeier Hilbert WI |
| *3120 Milksource Adios-Red-ET | 06/15/2022 | B&O | S-Riverdown Unstopabull-Red D-Milksource Attica-Red | Tristen Hans Ostrom Kaukauna WI |
| *3121 Thorgy-Way R Cherry-Red | 06/15/2022 | B&O | S-Heatherstone Ralph-Red-ET D-Thorgy-Way Acrat Charlie | Jenna Thorgerson Gilman WI |
| *3122 Kress-Hill Shy-Red-ET | 06/14/2022 | B&O | S-Farnear Altitude-Red-ET D-Ms Kress-Hil Sapphire-Red-ET | Owen & Kendyll Kress Newton WI |
| 3123 Miley Warrior Graceful-Red | 06/14/2022 | | S-Mr Blondin Warrior-Red-ET D-Miley Advent Att Gracie-Red | Plainfield Farms, B Hart, J Ackley, J Spreng East Liberty OH |

| | | | | |
|--|------------|-----|---|---|
| *3124 Bella-Ridge Loveshack-Red | 06/11/2022 | B&O | S-Farnear Altitude-Red-ET D-Bella-View Love and War-Red | J, L & M Harbaugh and A & A Loehr Marion WI |
| *3125 Ar-Line Moovin Whit-Red | 06/10/2022 | | S-Lindenright Moovin-ET D-Ar-Line Jdy Wisteria-Red-ET | Dana Johnson Tomah WI |
| *3126 Milksource Trip-Red-TW-ET | 06/09/2022 | | S-Cycle McGucci Jordy-Red D-Strans-Jen-D Tequila-Red-ET | M,A & H Van Exel, J,R & R Zonnevelds, B & S Dongelmans Lodi CA |
| 3127 Hodglynn Revere Pomella | 06/07/2022 | | S-Raspberry Revere-Red D-Intense Devour Pomlisa | William H Schilling Woodville ON |
| *3128 Miller-Farm Alt Febe-Red | 06/06/2022 | B&O | S-Farnear Altitude-Red-ET D-Heart & Soul Warrior Farah-Red | Danielle Haley Miller Baltimore OH |
| 3129 Sco-Lo Dc Rogue2470-Red-ET | 06/06/2022 | B&O | S-Loh Dice-Red-ET D-Sco-Lo Aval Rosario 2358-ET | Doeberienier, Bowen, Conroy and Cannon West Salem OH |
| 3130 Flower-Brook Helcarmina-Red D-08-00 305 30,887 4.6% 1,410 3.3%P 1,023P 338 34,019 4.6% 1,565 3.4%P 1,141P | 06/04/2022 | B&O | S-Cookiecutter D Helmsman-ET D-Flower-Brook Armani Carmani | Andrew Stuewe Hamburg MN |
| *3131 Synergy Love Stitch-Red-ET | 06/03/2022 | | S-Mr Blondin Warrior-Red-ET D-Synergy Always Smokin-Red | Kailey M Guilette & Whitney Handschke New Franken WI |
| *3132 Boardwalk Wr Sparkle-Red-ET | 06/02/2022 | | S-Mr Blondin Warrior-Red-ET D-Oakfield Lo Scarlett-Red-ET | L,e,a,e,r&l Coon Red Hook NY |
| *3133 BFWF-AB Anona-Red-ET | 06/02/2022 | | S-Avant-Garde-I Latenite-Red-ET D-Ms Apple Andorra-ET | Kyla and Ally Sickafoose Albion IN |
| *3134 Cherry-Lor W Ravish-Red-ET | 06/02/2022 | | S-Mr Blondin Warrior-Red-ET D-Cherry-Lor Dback Raven | Phillip Mccormick Muncy PA |
| 3135 Heatherstone Ruffian-Red D-01-11 305 23,931 4.3% 1,038 3.2%P 768P | 06/02/2022 | B&O | S-Cycle Jails Journey-Red-ET D-Milksource Rhapsody-ET | Heatherstone Enterprises, Inc. Baraboo WI |
| 3136 Milksource Rlight Antsy-Red | 06/02/2022 | | S-Brookview Redlight-Red D-Milksource Attica-Red | Richard Breunig, Robin Krohlow & Cupid Cattle Company Marshall WI |
| *3137 Silver-Elite Wr Ruby-Red-ET | 06/02/2022 | B&O | S-Mr Blondin Warrior-Red-ET D-Ms-Aol Aristocrat Rista-Red | Logan & Lauren Silveira Chowchilla CA |
| *3138 Vir-Clar Cherrybomb-Red-ET | 06/02/2022 | B&O | S-Lindenright Moovin-ET D-Lyn-Vale Cherry Wine-Red-ET | C, K, & G Grinstead G & J Boyke F WI |
| 3139 Exceleant Phoenix-Red-ET | 06/01/2022 | | S-Mr Blondin Warrior-Red-ET D-Windy-Knoll-View Phirey-Red | Westcoast Holsteins Chilliwack BC |
| *3140 Ms King-Street War Riot-Red | 06/01/2022 | B&O | S-Mr Blondin Warrior-Red-ET D-King-Street Dback Riptide | B & C Rupprecht and Cassandra Gebert Wawaka IN |
| *3141 Synergy Summerfest-Red-ET | 06/01/2022 | | S-Mr Blondin Warrior-Red-ET D-Synergy Always Smokin-Red | Jazmyn & Chase Heeg Colby WI |

Class **609 Spring Yearling Heifer**

Born 03/01/2022 - 05/31/2022

Premiums: \$100, 90, 80, 70, 60, 50, 40, 40, 35, 35, 30, 30, 25, 25, 20

1st Place Award presented by International Protein Sires, Rock Springs, WI

Bred & Owned Award presented by Red & White Dairy Cattle Association

Junior Premiums: \$25, 20, 20, 15, 15, 15, 10

Junior Award presented by Matt & Tracy Brandel Family, Lake Mills, WI

| | | | | |
|---|------------|-----|--|---|
| *3142 Karnview Dc Usb Atlanta-Red-ET | 04/10/2022 | | S-Riverdown Unstopabull-Red D-Ty-D Archival Azuli | Makayla & Kaleb Osinga Hico TX |
| *3143 Bella-View Wr Carnation-Red | 04/06/2022 | B&O | S-Mr Blondin Warrior-Red-ET D-Mik-Nels A Caramac-Red-ET | J, L & M Harbaugh and A & A Loehr Marion WI |
| 3144 Andrew Analyst Cardi-B-Red D-01-09 305 24,507 4.6% 1,052 3.4%P 785P | 04/01/2022 | B&O | S-Mr Affection Analyst-Red-ET D-Andrew Warrior Corona-Red | Tanner Rohner Pennock MN |
| 3145 Cashells Jor Cruella-Red | 03/26/2022 | B&O | S-Cycle McGucci Jordy-Red D-Cashells Un Cabernet-Red-ET | Ben & Liz Cashell, and Theo Goldenberg Towanda PA |
| *3146 Stjor Altitude Raven-Red-ET | 03/20/2022 | | S-Farnear Altitude-Red-ET D-Rosedale Lucky-Rose-Red | Dakota Brown and Ellie Larson Evansville WI |
| *3147 Jacher-Quietcove W Luna-Red | 03/17/2022 | | S-Mr Blondin Warrior-Red-ET D-Rosedale J Lovie-Red-ET | Kelly & Kendall O'Connor Arrowsmith IL |
| 3148 Lake-Effect Just Cherry-Red | 03/14/2022 | | S-Mr Blondin Warrior-Red-ET D-Lake-Effect Justright-Red | T&E Uber, Luncrest Farm LLC, J&A London Adamsville PA |
| 3149 Golden-Oaks War Tiktok-Red | 03/13/2022 | | S-Mr Blondin Warrior-Red-ET D-Milksource Tinder-Red-ET | Lindsey Borst, Nathan Donnay, Mike Donnelly Rochester MN |
| 3150 Stjor Analyst River-Red-ET | 03/11/2022 | | S-Mr Affection Analyst-Red-ET D-Rosedale Lucky-Rose-Red | Blackjack Holsteins and T&L Cattle Wykoff MN |
| 3151 Ms MD-HB I'm All That-Red | 03/09/2022 | | S-Riverdown Unstopabull-Red D-Mdhillbrook Indablue-Red-ET | Austin Trbovich Waynesburg OH |
| *3152 Firstglance Starstruck-Red | 03/06/2022 | B&O | S-Cycle McGucci Jordy-Red D-Firstglance Star Warrior | Sophie J & Lexi Schaefer Galesville WI |
| *3153 Quietcove Firecracker-Red | 03/06/2022 | | S-Farnear Altitude-Red Et D-Quietcove Avalanche Funny | Lilly Elsass Wapakoneta OH |
| *3154 Hilrose Alltde Adore-Red-ET | 03/05/2022 | B&O | S-Farnear Altitude-Red-ET D-Hilrose Avalnch Adel-Red-ET | Bentley, Blake, Brodie & Kylie Brantmeier Hilbert WI |
| *3155 Kozy-Kountry Un Firefly-Red | 03/05/2022 | B&O | S-Riverdown Unstopabull-Red D-Oakfield-Bro Firefx-Red-ET | Victoria Clark Springville PA |
| *3156 Cookiecutter Riddle-Red-ET | 03/04/2022 | | S-Mr Blondin Warrior-Red-ET D-Parkvue Absolute Rap-Red-ET | Chloe & Claire Lamb Oakfield NY |
| 3157 Hamming Jordy Monae | 03/03/2022 | | S-Cycle McGucci Jordy-Red D-Hamming Army Monae | London Dairy Farms London ON |

| | | | | |
|-------------------------------------|------------|-----|---|--|
| 3158 Synergy Jordy Smile-Red-ET | 03/03/2022 | | S-Cycle McGucci Jordy-Red D-Synergy Always Smokin-Red | Taylor Jerde Northfield MN |
| 3159 Elmbridge Mirand Lupa | 03/02/2022 | | S-Coomboona Zipit Mirand-ET D-Elmbridge Addiction Lazy Red | Keaton Phoenix and Stanhow Holsteins Uxbridge ON |
| 3160 HC14829031 Born From The Ashes | 03/02/2022 | B&O | S-Mr Blondin Warrior-Red-ET D-Deslacs Avalanche Ashillia Red | Christie Prins Flood Wooler ON |
| 3161 Reyncrest Hot Topic-Red | 03/02/2022 | B&O | S-Avant-Garde-I Latenite-Red-ET D-Aot Avalanche Hot Shot | Reyncrest Farm Corfu NY |
| 3162 Virhada War Whistful-Res | 03/02/2022 | B&O | S-Mr Blondin Warrior-Red-ET D-Virhada Jordy Wibble | Virhada Holsteins LLC Mt. Horeb WI |
| *3163 Canary Analyst Naomi-Red | 03/01/2022 | B&O | S-Mr Affection Analyst-Red-ET D-Bronhom Jordy Nancy-Red | Ava M Canary Fort Plain NY |
| *3164 Forest-Ridge Rdlt Mambo-Red | 03/01/2022 | B&O | S-Brookview Redlight-Red D-Forest-Ridge Gold Mambo-ET | J, L & M Harbaugh and A & A Loehr Marion WI |
| *3165 JG-Springs Unstop Lowen-Red | 03/01/2022 | B&O | S-Riverdown Unstopabull-Red D-Blondin Jordy Loanne-Red-ET | Emily Goode Liberty KY |
| 3166 Mi-Ko Warrior Velma Rae-Red | 03/01/2022 | | S-Mr Blondin Warrior-Red-ET D-Redridge Art Velvet-Rae-Red | Robin Krohlow Sheboygan WI |
| *3167 Miller-Farm Ferrari-Red | 03/01/2022 | B&O | S-Farnear Altitude-Red-ET D-Heart & Soul Rv Fiesta-Red | Danielle Haley Miller Baltimore OH |
| 3168 Ms-Aol Camaro-Red | 03/01/2022 | | S-Mr Affection Analyst-Red-ET D-Ms-Aol Warrior Cora | Merrillea Holsteins Fayette NY |
| *3169 Nabholz Unst Skittles-Red | 03/01/2022 | | S-Riverdown Unstopabull-Red D-Willow-Marsh Sundance-Red | Dakota Sawyer Marshalltown IA |
| *3170 Vale-O-Skene Para Sherryl-Red | 03/01/2022 | | S-Sunnypoint Paradise-ET D-Vale-O-Skene Armani Storm-Red | Gabriel, Keyanna, Rylen & Titus Mentink Oostburg WI |

Class 610 Winter Yearling Heifer

Born 12/01/2021 - 02/28/2022

Heifer not in milk.

Premiums: \$100, 90, 80, 70, 60, 50, 40, 40, 35, 35, 30, 30

1st Place Award presented by International Protein Sires, Rock Springs, WI

Bred & Owned Award presented by Red & White Dairy Cattle Association

Junior Premiums: \$25, 20, 20, 15, 15

Junior Award presented by Brian Stump, Kimmell, IN

| | | | | |
|--------------------------------|------------|-----|--|-----------------------------------|
| *3171 Brigeen-Redeye Rainn-Red | 01/21/2022 | B&O | S-Vogue Redeye-P-Red D-Brigeen Sidekick I Rolande | Sydney Bullard Turner ME |
| 3172 Md Analyst Bottoms Up-Red | 01/11/2022 | | S-Mr Affection Analyst-Red-ET D-Miss Tatoo Biscuit-ET | Sam McWilliams Somerset PA |
| 3173 Sugar-C Ln Elude-Red | 12/28/2021 | | S-Avant-Garde-I Latenite-Red-ET D-Sugar-C Exceed-ET | Beckridge Holsteins Keswick ON |

| | | | | |
|--|------------|----------------|--|--|
| 3174 Seimers W Hot 36873-Red-ET | 12/26/2021 | | S-Mr Blondin Warrior-Red-ET D-Heatherstone Redhot-Red | James Niple & Krist Ackley East Liberty OH |
| 3175 Kings Ransom L Sybil-Red-ET | 12/19/2021 | | S-Avant-Garde-I Latenite-Red-ET D-Petitclerc Avalanche Syrah-ET | Chris & Jen Hill and Diamond Valley Dairy Thurmont MD |
| *3176 Cross Town Capt America D-04-08 305 22,299 3.9% 904 | 12/12/2021 | 3.1%P 723P | S-Coomboona Zipit Mirand-ET D-Cross-Town Hpntc Winnie | Derek, Landon & Lane Vandyk New Richmond WI |
| 3177 Gro209 Late Nite Snack-P | 12/11/2021 | | S-Avant-Garde-I Latenite-Red-ET D-Groves-Vu Doc Cambridge | London Dairy Farms London ON |
| *3178 Nise-N-Fancy War Claire-Red D-02-03 304 26,630 3.8% 785 | 12/08/2021 | B&O 3.1%P 741P | S-Mr Blondin Warrior-Red-ET D-Nise-N-Fancy Jrdy Casper-TW | Oliver, Owen & Addison Nisen Leesburg IN |
| *3179 JG-Springs Warr Talia-Red | 12/05/2021 | B&O | S-Mr Blondin Warrior-Red-ET D-Milksource Defint Taylor-ET | Emily Goode Liberty KY |
| *3180 Riverdown Thats Snappy-Red-ET | 12/05/2021 | | S-Coomboona Zipit Mirand-ET D-Riverdown Av Thats Snazzy-ET | Hailey Abraham Harvard IL |
| *3181 Bucks-Pride Journey Amy-Red | 12/02/2021 | | S-Cycle Jails Journey-Red-ET D-Bucks-Pride Defiant Suz-Red | Brady & Bentley Cole Bloomville OH |
| 3182 Liberty-Gen Jordy Lapdance | 12/02/2021 | | S-Cycle McGucci Jordy-Red D-Liberty-Gen Defiant Licorice | Brian Joseph Enright, Dandyland Farms & Jaquemet Holsteins Winchester ON |
| 3183 Riverdown U Asparkle-Red-ET | 12/02/2021 | | S-Riverdown Unstopabull-Red D-Westcoast Crown Asparagus-Red | Jim Butler Chebanse IL |
| 3184 Belmoral War Lorde | 12/01/2021 | B&O | S-Mr Blondin Warrior-Red-ET D-Blondin Armani Lara | Mitchell Kieffer Teeswater ON |
| *3185 Betley Lightsout-Red-ET | 12/01/2021 | B&O | S-Riverdown Unstopabull-Red D-OCD Jo Lionking-Red-ET | Claire & Jacob Betley Pulaski WI |
| 3186 Bhhd Moovin Fiji-Red-ET | 12/01/2021 | | S-Lindenright Moovin-ET D-Rosedale Prettyfancy In-Red | Makenzie & Callen Ferris Soap Lake OR |
| *3187 Flannery-Vu Amazing-Red-ET | 12/01/2021 | | S-Mr Blondin Warrior-Red-ET D-Sherona-Hill Jct Annie-Red | Natalie A, Paige L, & Neil R. Haase Parker SD |
| *3188 Flower-Brook A Gilda-Red-ET | 12/01/2021 | | S-Farnear Altitude-Red-ET D-Flower-Brook Gianne-Red-ET | C, K, & G Grinstead G & J Boyke F WI |
| 3189 Ms-Aol Ready To Roll | 12/01/2021 | | S-Mr Blondin Warrior-Red-ET D-Miss Roxys Recovery-Red | Reyncrest Farm and Fly-Higher Holsteins Corfu NY |
| 3190 Rocky-Run Mv Arcadia-Red-ET | 12/01/2021 | | S-Lindenright Moovin-ET D-Apple-Pts Aleesa-Red-ET | Golden Oaks Farm Wauconda IL |
| 3191 Spungold-G Allit Spice-Red | 12/01/2021 | B&O | S-Farnear Altitude-Red-ET D-Soungold-G Jordy Sassy-Red | Dale & Deanna Bendig Gettysburg PA |
| *3192 Wil-San Warrior Jammin-Red | 12/01/2021 | | S-Mr Blondin Warrior-Red-ET D-Wil-San Diamondback Doll | Audrey Sidle Smithville OH |

Class 611 Fall Yearling Heifer

Born 09/01/2021 - 11/30/2021

Heifer not in milk.

Premiums: \$100, 90, 80, 70, 60, 50, 40, 40, 35, 35

1st Place Award presented by Stro-Lane Dairy, Henderson, MN

Bred & Owned Award presented by Red & White Dairy Cattle Association

Junior Premiums: \$25, 20, 20

Junior Award presented by International Protein Sires, Rock Springs, WI

| | | | | | |
|-------|--|------------|-----|---|---|
| *3193 | Dynasty Woodcreek Bontia-Red D-01-09 305 22,399 4.1% 924 6.5%P 774P | 09/30/2021 | B&O | S-Mr Blondin Warrior-Red-ET D-Fraeland Altitude Bodacious-ET | Kenlee Philips Lingleville TX |
| 3194 | Beckridge Warrior-Red Bermuda | 09/22/2021 | B&O | S-Mr Blondin Warrior-Red-ET D-Dreamcrest Lotus Brittany | Beckridge Holsteins Keswick ON |
| 3195 | Lyn-Vale Rumchata-Red-ET | 09/16/2021 | | S-Mr Blondin Warrior-Red-ET D-Lyn-Vale Raina-Red-ET | Reyncrest Farm and Fly-Higher Holsteins Corfu NY |
| 3196 | Mcgarr-Farms E Rumor-Red-ET | 09/12/2021 | | S-Avant-Garde-I Latenite-Red-ET D-Ms Raps Ruby-Red-ET | Elmvue Farm Johnstown NY |
| 3197 | Siemers A Hot 36141-Red | 09/12/2021 | | S-Farnear Altitude-Red-ET D-Heatherstone Redhot-Red | Darlington Ridge Farms LLC Darlington WI |
| 3198 | Mcgarr-Farms E Rebel-Red-ET | 09/11/2021 | B&O | S-Avant-Garde-I Latenite-Red-ET D-Ms Raps Ruby-Red-ET | Eoghan Daniel Mcgarr King Ferry NY |
| *3199 | JG-Springs Warr Taya-Red-ET | 09/05/2021 | B&O | S-Mr Blondin Warrior-Red-ET D-Golden-Oaks Topprize-Red-ET | Emily Goode Liberty KY |
| *3200 | Bella-Ridge Daydreamer-Red | 09/03/2021 | B&O | S-Mr Blondin Warrior-Red-ET D-Bella-Ridge Ammo-P Defiant | J, L & M Harbaugh and A & A Loehr Marion WI |
| 3201 | Kamps-Rx Ab Attatown-Red-ET | 09/03/2021 | B&O | S-Avant-Garde-I Latenite-Red-ET D-KHW Regiment Apple B-Red-ETN | Reggie & Krysty Kamps Darlington WI |
| 3202 | Bell-Vf Unstop Sweetie-Red | 09/02/2021 | B&O | S-Riverdown Unstopabull-Red D-Bell-Vf Corvette Sassafras | Brian, Traci & Landon Neely Utica PA |
| *3203 | Redcarpet War 4 Mars-Red-ET | 09/01/2021 | | S-Mr Blondin Warrior-Red-ET D-Jg-Rg Advent Earlene-Red-ET | J, L & M Harbaugh and A & A Loehr Marion WI |

Class 613 Junior Champion Bred & Owned of the Junior Show

Award and Rosette presented by Betley Family Farms, Pulaski, WI

Class 614 Junior Champion Bred & Owned

Award and Rosette presented by Betley Family Farms, Pulaski, WI

Class 615 Junior Champion Female of the Junior Show

Award presented by Sellcrest Farm, the Sell Family, Watertown, WI
 \$250 Junior Champion of the Junior Show Cash Award presented by Misty Meadow Dairy, the Hogan family, Tillamook, OR
 Champion Banner presented by Select Sires, Inc., Plain City, OH
 Rosette presented by Doug & Linda Hodorff, Eden, WI
 Award courtesy of Red & White Dairy Cattle Association

Class 616 Reserve Junior Champion Female of the Junior Show

Award presented by Red & White Dairy Cattle Association
 Reserve Champion Banner presented by Select Sires, Inc., Plain City, OH
 Rosette presented by St. Jacobs ABC, DeForest, WI

Class 617 Junior Champion Female

Norman E. Magnussen Memorial Trophy presented by E-Zee Milking Equipment, LLC, McFarland, WI
 \$500 Junior Champion Cash Award presented by Cargill Animal Nutrition, Watertown, WI
 Champion Banner presented by Select Sires, Inc., Plain City, OH
 Rosette presented by GenOvations, Lodi, WI
 Award courtesy of Red & White Dairy Cattle Association

Class 618 Reserve Junior Champion Female

Award presented by St-Yle Holsteins, Belmont, WI
 Reserve Champion Banner presented by Select Sires, Inc., Plain City, OH
 Rosette presented by Phibro Animal Health Corp., Quincy, IL

Class 619 Junior Best Three Females

Fall Yearling (not in milk) and under. All animals must be bred with same prefix by exhibitor with at least one owned by exhibitor.
 Premiums: \$75, 65, 55
 1st Place Award presented by Red & White Dairy Cattle Association

3204 Andrew Stuewe
 Hamburg MN

3205 Brian Joseph Enright
 Winchester ON

3206 Claire & Jacob Betley
 Pulaski WI

3207 Emily Thorgerson
 Gilman WI

3208 Eoghan Daniel McGarr
 King Ferry NY

3209 Ferme Jacobs Inc.
 Cap-Sante QC

3210 Ferme Malic
 Lévis QC

3211 J, L & M Harbaugh and A & A Loehr
 Marion WI

3212 Jeff Brantmeier
 Hilbert WI

3213 Miley Holstein Farms
 West Salem OH

3214 Oakfield Corners Dairy
Oakfield NY

3215 Owen & Kendyll Kress
Newton WI

3216 Reggie & Krysty Kamps
Darlington WI

3217 Synergy Dairy LLC
Pulaski WI

Class **621 Premier Breeder of Heifer Show**
Royal Banner presented by Agpro, Inc., Paris, TX

Class **622 Premier Exhibitor of Heifer Show**
Royal Banner presented by Agpro, Inc., Paris, TX

Class **623 Premier Sire of the Heifer Show**
Royal Banner presented by St. Jacobs ABC, DeForest, WI

Class **625 Yearling Heifer in Milk**
Born 09/01/2021 - 12/31/2021
Cow must have freshened and in milking form.
Premiums: \$150, 135, 120, 100, 90, 80, 70, 60, 50, 40
1st Place Award and Bred & Owned Award presented by Red & White Dairy Cattle Association
Best Udder Rosette presented by Holstein International and Cattle Connection, Stiens, The Netherlands
Junior Premiums: \$50, 40
Junior Award presented by Mead-Manor, Algoma, WI

| | | | |
|--|----------------|---|---|
| 3218 Kozak Warrior Red Blaze D-07-11 305 23,052 2.9% 670 3.1%P 655P | 12/01/2021 | S-Mr Blondin Warrior-Red-ET D-Kozak Colt Brittney Red | R&F Livestock Inc. Cudworth SK |
| *3219 Ms E-Skin Ava Finale-Red-ET | 09/18/2021 | S-Dymenthalm Mr App Avalanche-TW D-Ms E-Skinner Abso Fresh-Red | Lily Marshman Oxford NY |
| *3220 Forward Dehliia-Red-ET | 09/17/2021 B&O | S-Val-Bisson Doorman-ET D-Jas-J Guthrie Tart-Red-ET | Emma, Sara, Wyatt & Claire Dorshorst Marshfield WI |
| *3221 Siemers A Hot 36152-Red-ET | 09/14/2021 | S-Farneck Altitude-Red-ET D-Heatherstone Redhot-Red | Katelyn Klipp Hanover KS |
| *3222 Ms Kings-Ransom Dice-Red-ET | 09/08/2021 B&O | S-Farneck Altitude-Red-ET D-Ms D Apple Danielle-Red-ET | Lauren & Nathaniel King Schuylerville NY |
| *3223 Flower-Brook Del Rio-Red-ET | 09/06/2021 | S-Mr Blondin Warrior-Red-ET D-Flower-Brook Dbk Deloria-ET | Madison, Atlee & Henry Van Exel Lodi CA |
| *3224 Schluter Altud Amber-Red-ET | 09/06/2021 | S-Farneck Altitude-Red-ET D-Hillrose Db Allie-Red-ET | Claire & Jacob Betley Pulaski WI |
| *3225 Rollingriver Empress-Red | 09/05/2021 B&O | S-Mr Blondin Warrior-Red-ET D-Ms Rollingriver Km Ellie-Red | Kamrie Mauer Brownton MN |
| 3226 Kress-Hill Snooky-Red | 09/04/2021 | S-Mr Affection Analyst-Red-ET D-Ms Kress-HI Sapphire-Red | Michael & Jessica Oliver Lomira WI |

| | | | | | | |
|-------|-----------------------------|-----|------------|------|---|--|
| 3227 | Kress-Hill Sparkle-Red-ET | | 09/04/2021 | | S-Mr Affection Analyst-Red-ET D-Ms Kress-Hil Sapphire-Red-ET | Westcoast Holsteins Chilliwick BC |
| 3228 | Gahm-Ozroyal Moov Alana-Red | | 09/03/2021 | | S-Lindenright Moovin-ET D-Luck-E Doc Azacazam-ET | Scott Culbertson and T&L Cattle Company Elgin MN |
| | D-01-11 | 305 | 21,890 | 4.2% | 919 | 3.3%P 717P |
| | | 365 | 25,070 | 4.3% | 1,076 | 3.4%P 840P |
| *3229 | Kara-Kesh-RK Swirl-Red-ET | | 09/03/2021 | B&O | S-Luck-E Awesome-Red D-Kara-Kesh-RK Solstis-Red-ET | Curtis, Evelyn & Agnes Griffin Thief River Falls MN |
| | 01-09 | 24 | 1,217 | 3.6% | 44 | 3.7%P 45P |
| 3230 | Riedel-Ridge Apple-Pie-Red | | 09/03/2021 | B&O | S-Mr Affection Analyst-Red-ET D-Riedel-Ridge Dback Amor-Red | Taylor & Kelsey Riedel Pardeeville WI |
| 3231 | Fantasy-Found Destiny-Red | | 09/02/2021 | | S-Farneck Altitude-Red-ET D-Ranway Incred Dancer139-Red | Maple-Downs Farms II and Peter Vail Middleburgh NY |
| | 01-10 | 36 | 2,401 | 4.3% | 103 | 2.8%P 68P |
| 3232 | W-Brook Hottest-Red | | 09/02/2021 | | S-Mr Affection Analyst-Red-ET D-Hs-Hotstuff Hotter-Red | R&F Livestock Inc. Cudworth SK |
| | 01-08 | 55 | 7,392 | 4.0% | 293 | 3.1%P 230P |
| 3233 | Andrew Unstop Spritzer-Red | | 09/01/2021 | B&O | S-Riverdown Unstopabull-Red D-Lone-Oak Gold Chip Sophia | Tanner Rohner Pennock MN |
| | 01-09 | 56 | 4,086 | 3.7% | 151 | 2.5%P 101P |
| *3234 | Cookiecutter Remedy-Red-ET | | 09/01/2021 | | S-Cycle McGucci Jordy-Red D-Parkvue Absolute Rap-Red-ET | Caroline Egolf & Ellianna Cummings North Lewisburg OH |
| | 01-09 | 30 | 1,824 | 3.8% | 70 | 3.2%P 58P |
| *3235 | Grace Leigh Shelby-Red-ET | | 09/01/2021 | | S-Mr D Apple Diamondback D-Redtag Destry Sneezy-Red-ET | Hailey Abraham Harvard IL |
| 3236 | Schluter Applespice-Red-ET | | 09/01/2021 | | S-Mr Blondin Warrior-Red-ET D-Apple-Pts Ainsa-Red-ET | Allyn, Hovden and Gibbs Canaan CT |
| | D-02-02 | 305 | 24,430 | 4.6% | 1,113 | 3.4%P 823P |
| 3237 | Siemers Tequila 033-Red | | 09/01/2021 | | S-Farneck Altitude-Red-ET D-Strans-Jen-D Tequila Red | Ben & Jennifer Wallace & Steve McDonald Lomira WI |
| 3238 | Synergy Sugarland RED-ET | | 09/01/2021 | | S-Brookview Redlight-Red D-Synergy Always Smokin-Red | Gary Breitlow Algoma WI |

Class 627 Summer Junior Two-Year-Old Cow

Born 06/01/2021 - 08/31/2021

Cow must have freshened and in milking form.

Premiums: \$150, 135, 120, 100, 90, 80, 70, 60, 50, 40

1st Place Award presented by Road View Dairy Holsteins, the Yager Family, Mineral Point, WI

Bred & Owned Award presented by Red & White Dairy Cattle Association

Best Udder Rosette presented by Holstein International and Cattle Connection, Stiens, The Netherlands

Junior Premiums: \$50, 40, 30

Junior Award presented by SilverStone Farm, Chad & Marla Stone and Family, Greenfield, IN

| | | | | | | |
|-------|--------------------------------|-----|------------|------|---|--------------------------------------|
| *3239 | Four-Hills Analst 69057-Red | | 08/18/2021 | B&O | S-Mr Affection Analyst-Red-ET D-Four-Hills Crown 67041 | Sarah Hill Bristol VT |
| | D-02-10 | 305 | 27,500 | 3.7% | 965 | 3.1%P 820P |
| 3240 | Glaustar Ilstr Masterpiece-Red | | 08/02/2021 | B&O | S-Vogue Illustrator-P D-Chanmar Integral Marcy | Glaustar Compton QC |
| | D-05-02 | 305 | 34,185 | 4.5% | 1,550 | 3.1%P 1,069P |
| | | 365 | 39,915 | 4.6% | 1,834 | 3.2%P 1,265P |
| *3241 | Siemers A Rhot 35895-Red-ET | | 08/02/2021 | | S-Farneck Altitude-Red-ET D-Heatherstone-Redhot-Red | Kyra and Kenzie Danz Watertown WI |
| | 01-10 | 34 | 2,866 | 4.2% | 120 | 2.8%P 81P |

| | | | | |
|---|------------|-----|--|---|
| 3242 Sunnybend Seduction-Red | 07/28/2021 | B&O | S-Mr Affection Analyst-Red-ET D-Ms Shanas Shimmer-Red-ET | Jacalyn & Brooke Bortner York PA |
| *3243 Erbacres Abrylyn-Red-ET | 07/25/2021 | | S-Mr Blondin Warrior-Red-ET D-Apple-Pts Abrianna-Red-ET | Lauren D L'amoreaux Louisville OH |
| 3244 Forge Hollow Baylor-Red | 07/02/2021 | B&O | S-Mr Affection Analyst-Red-ET D-Old-Bankston Blaze-Red-ET | Lynette J. Gelsing Womelsdorf PA |
| 3245 Danhof Analyst Starry-Red | 07/01/2021 | | S-Mr Affection Analyst-Red-ET D-Danhof J Star-Red-ET | Bradley Kerndt Lansing IA |
| 3246 Flower-Brook Jrdy Heide-Red 02-01 11 648 4.3% 28 3.4%P 22P | 06/28/2021 | B&O | S-Cycle McGucci Jordy-Red D-Flower-Brook Heroine-Red | Andrew Stuewe Hamburg MN |
| 3247 Danhof J Shakira-Red-ET 01-09 106 13,356 4.5% 601 2.6%P 347P | 06/26/2021 | B&O | S-Cycle Jails Journey-Red-ET D-Milksource Ld Shania-Red-ET | Jason & Sheri Danhof Waukon IA |
| 3248 Mead-Manor Warr Ads-Red-ET | 06/24/2021 | | S-Mr Blondin Warrior-Red-ET D-Mead-Manor Def Adeline-Red | Sarah Fitzgerald Belvidere IL |
| 3249 Kamps-Rx Aplb Archer-Red-ET 01-11 78 6,688 4.1% 273 3.1%P 205P | 06/20/2021 | B&O | S-Loh Dice-Red-ET D-KHW Regiment Apple B-Red-ETN | Reggie & Krysty Kamps and Joe Casper Darlington WI |
| 3250 Scenic-Edge Jaynay-Red | 06/20/2021 | B&O | S-Mr Blondin Warrior-Red-ET D-Scenic-Edge Jacie-Red-ET | Yvonne E Preder and Rodney Bohnhoff Plymouth WI |
| 3251 Londondale Lyst Scarlet-Red | 06/18/2021 | B&O | S-Mr Affection Analyst-Red-ET D-Londondale Awsme Sadie-Red | Jordan A. London Punxsutawney PA |
| 3252 Cashells R Caliente-Red-ET 02-00 62 3,834 3.7% 141 2.6%P 99P | 06/15/2021 | | S-KW-BHL Remy-Red-ET D-Cashells Un Cabernet-Red-ET | Elmvue Farm Johnstown NY |
| 3253 Krull Hot Charolette-Red 01-11 74 4,959 3.6% 181 2.6%P 131P | 06/12/2021 | B&O | S-Mr Leverage Hot Daddy-Red-ET D-Krull Cammo Toe | Carley Krull Lake Mills WI |
| 3254 Triple-T-Mph Anlt Rosay-Red | 06/09/2021 | | S-Mr Affection Analyst-Red-ET D-Wil-O-Mar Diamndbk Rose-Red | London Dairy Farms London ON |
| 3255 Blondin Believe Lychee-Red | 06/06/2021 | | S-Aija Believe-P-ET D-Greenlane Unstopabull Lantana | Jim Butler Chebanse IL |
| 3256 Flower-Brook Gracin-Red 02-01 19 1,005 4.8% 48 3.4%P 34P | 06/03/2021 | B&O | S-Farnear Altitude-Red-ET D-Flower-Brook Gracious-Red | Andrew Stuewe Hamburg MN |
| *3257 Flower-Brook Genobly-Red-ET | 06/02/2021 | | S-Mr Affection Analyst-Red-ET D-Flower-Brook Geno-Red | Hailey Abraham Harvard IL |
| 3258 Ratliff Ms Freaky Girl-Red D-04-08 305 29,844 4.3% 1,285 3.1%P 938P | 06/01/2021 | B&O | S-KW-BHL Remy-Red-ET D-Ratliff App-4 Fiesta-Red-ET | Ronald L. & Christine A Ratliff Trust Garnett KS |
| 3259 Siemers Great 35511-Red-ET 02-03 120 10,380 4.4% 303 2.6%P 273P | 06/01/2021 | | S-Mr Affection Analyst-Red-ET D-Siemers Awesome Great-Red | Royal Vista Holsteins Pickett WI |
| 3260 Siemers Taya-Red-ET | 06/01/2021 | | S-Mr Blondin Warrior-Red-ET D-Strans-Jen-D Tequila-Red-ET | William Taylor and Beth Roberts Oldwick NJ |

Class **628 Junior Two-Year-Old Cow**

Born 03/01/2021 - 05/31/2021

Cow must have freshened and in milking form.

Premiums: \$150, 135, 120, 100, 90, 80, 70, 60, 50, 40

1st Place Award presented by Kamps Rx Genetics, Darlington, WI

Bred & Owned Award presented by Red & White Dairy Cattle Association

Best Udder Rosette presented by Holstein International and Cattle Connection, Stiens, The Netherlands

Junior Premiums: \$50, 40, 30

Junior Award presented by Beekman Holsteins, Jay & Jasmine Beekman, Huntington, IN

| | | | | | |
|-------|-----------------------------|------------|------------|---|---|
| *3261 | Road-View Reeves Remedy-Red | 05/28/2021 | B&O | S-Mr Stone-Front Reeve-Red-ET D-Road-View Reg Attempt-Red | Haylee Yager Mineral Point WI |
| 3262 | Arcroix Devour Reanna | 05/03/2021 | B&O | S-Mr Danielle Devour-ET | Pierre Boulet, Ferme Arthur Lacroix & Letarte Holstein |
| | D-01-11 | 305 23,331 | 4.4% 1,025 | 3.2%P 743P | D-Pierstein Avalanche Rebekka |
| | | 365 26,374 | 4.5% 1,188 | 3.3%P 866P | Montmagny QC |
| 3263 | Sco-Lo Dice Assassin-Red-ET | 04/30/2021 | | S-Loh Dice-Red-ET D-Sco-Lo Daniel Acura 2311-ET | Zachary, Collin J, and Maddy Costello Watertown WI |
| | 02-02 | 25 1 | 1.0% 1 | 1.0%P 1P | |
| *3264 | Four-Hills A Vegas68625-Red | 04/09/2021 | B&O | S-Mr Affection Analyst-Red-ET D-Four-Hills Doppler66718-Red | Sarah Hill Bristol VT |
| | 01-09 | 213 20,900 | 2.8% 592 | 2.6%P 556P | |
| *3265 | Miss Aristocrat Kandi-Red | 04/07/2021 | | S-Luck-E Arisotcrat-Red D-Fox-Valley Diamond Katie-P | Aries Derby Memphis MO |
| 3266 | Kamps-Rx Apb Aprada-Red-ET | 04/01/2021 | B&O | S-Macs-Acres Ava Blizzard D-KHW Regment Apple B-Red-ETN | Reggie & Krysty Kamps Darlington WI |
| | 02-01 | 90 7,836 | 3.6% 279 | 3.0%P 233P | |
| 3267 | Ms Warrior Abby-Red-ET | 03/26/2021 | | S-Mr Blondin Warrior-Red-ET D-Apple-Pts Astonish-Red-ET | Makenzie & Callen Ferris Soap Lake OR |
| | 02-06 | 4 300 | 3.8% 11 | 3.6%P 10P | |
| *3268 | Ovaltop Unst Roseana-Red | 03/23/2021 | B&O | S-Riverdown Unstopabull-Red D-Ovaltop Rlty Roselea-Red | Justin M. Wolfe Richfield Springs NY |
| | 02-00 | 135 9,982 | 3.8% 383 | 3.1%P 308P | |
| 3269 | Scenic Edge Jadene-Red-ET | 03/18/2021 | | S-Mr Blondin Warrior-Red-ET D-Scenic-Edge Jasmine-Red | Luke Alsleben and Tony Kohls Glencoe MN |
| *3270 | Kress-Hill Sci-Fi-Red-ET | 03/16/2021 | B&O | S-Farnear Altitude-Red-ET D-Ms Kress-Hil Sapphire-Red-ET | Owen & Kendyll Kress Newton WI |
| | 02-00 | 128 11,266 | 4.2% 475 | 2.8%P 318P | |
| 3271 | Holzer Warrior Princess | 03/12/2021 | | S-Mr Blondin Warrior-Red-ET D-Holzer At Dixes Acme | Westcoast Holsteins Chilliwack BC |
| 3272 | Reyncrest Ucallme Maybe-Red | 03/10/2021 | B&O | S-Riverdown Unstopabull-Red D-Reyncrest Diamndbk Cici-Red | Tyler & Kelly Reynolds Corfu NY |
| 3273 | Milksource Tora-Red-ET | 03/05/2021 | | S-Dymenthalm Mr App Avalanche-TW D-Strans-Jen-D Tequila-Red-ET | Makenzie & Callen Ferris Soap Lake OR |
| | 02-05 | 57 4,374 | 3.8% 166 | 3.2%P 139P | |
| 3274 | Kuperus Altitud Ruby-Red-ET | 03/02/2021 | B&O | S-Farnear Altitude-Red-ET D-Interflame Flame Defi Lulu | Luncrest Farm and Matthew Kuperus Granville NY |
| | 02-09 | 97 7,760 | 3.1% 241 | 2.9%P 225P | |
| 3275 | Luck-E Devour Akooza-Red-ET | 03/02/2021 | | S-Mr Danielle Devour-ET D-Luck-E Mcgucci Afro-Red-ET | Golden Oaks Farm Wauconda IL |

| | | | |
|---|----------------|---|---|
| *3276 Ms Libation-Red | 03/02/2021 | S-Mr Blondin Warrior-Red-ET D-Blondin Jordy Lakesha-Red-ET | Hayden Weaver Ephrata PA |
| 3277 Darcroft Jc Unstop Alabama | 03/01/2021 | S-Riverdown Unstopabull-Red D-Ty-D Archival Azuli | William H Schilling Woodville ON |
| 3278 Kamps-Rx Altd Arbormist-Red 02-06 31 2,015 3.8% 78 3.1%P 62P | 03/01/2021 | S-Farnear Altitude-Red-ET D-Kamps-Rx Appleb Amaretto-ET | Justine Kelsey Canastota NY |
| 3279 Kamps-Rx-Db Aftershow-Red 02-00 167 14,261 4.6% 654 3.0%P 421P | 03/01/2021 B&O | S-Farnear Altitude-Red-ET D-Kamps-Rx Appleb America-ET | Reggie & Krysty Kamps & Dennis Bowers Darlington WI |
| *3280 Ms Mauk-E-Way Remington-Red 02-00 166 12,759 4.1% 522 2.9%P 374P | 03/01/2021 B&O | S-Lindenright Moovin-ET D-Ms Mauk-E-Way Remi-Red-ET | Natalie, Braxton & Jayden Mauk Plymouth WI |
| Class 629 Senior Two-Year-Old Cow | | | |
| Born 09/01/2020 - 02/28/2021 | | | |
| Cow must have freshened and in milking form. | | | |
| Premiums: \$150, 135, 120, 100, 90, 80, 70, 60, 50, 40 | | | |
| 1st Place Award presented by Wisconsin Red & White Dairy Cattle Association | | | |
| Bred & Owned Award presented by Red & White Dairy Cattle Association | | | |
| Production Rosette presented by Case IH, Racine, WI | | | |
| Best Udder Rosette presented by Holstein International and Cattle Connection, Stiens, The Netherlands | | | |
| Junior Premiums: \$50, 40, 30, 20 | | | |
| Junior Award presented by Agromatic - Kurt Loehr, Eden, WI | | | |
| *3281 Ruann Moo Shar-11679-Red-ET 01-11 250 22,310 3.6% 807 2.9%P 650P | 01/11/2021 | S-Lindenright Moovin-ET D-Ruann D-B Shar-60985-Red-ET | Greyden Maddox Riverdale CA |
| *3282 Stjor Unst Rose 8504-Red-ET 02-03 109 10,539 3.4% 353 2.6%P 278P | 12/18/2020 | S-Riverdown Unstopabull-Red D-Rosedale Lucky-Rose-Red | Matthew and Elizabeth Gunst Hartford WI |
| 3283 Rokeyroad Moovin Artist-Red 02-00 242 14,135 4.5% 631 3.1%P 441P | 12/13/2020 | S-Lindenright Moovin-ET D-Rokeyroad Dback Auburn-Red | Elmvue Farm Johnstown NY |
| 3284 Oakfield US Bamboo-Red-ET 02-02 203 18,350 3.7% 674 2.9%P 540P | 12/01/2020 B&O | S-Riverdown Unstopabull-Red D-Underground Bccas Blair-Red | Oakfield Corners Dairy Oakfield NY |
| 3285 Wildweed Warrior Maui-Red 02-02 184 10,709 3.7% 399 3.1%P 331P | 12/01/2020 B&O | S-Mr Blondin Warrior-Red-ET D-Wildweed L Martini-Red-TW | Frank Behling Fox Lake WI |
| 3286 Flower-Brook Camo-Red 01-10 255 13,629 4.6% 648 3.5%P 482P | 10/19/2020 | S-Farnear Altitude-Red-ET D-Flower-Brook Absolute Cami | Rick Kaut Winlock WA |
| *3287 Ms-Aol Unstop Claudia-Red 02-07 46 3,738 4.1% 152 3.0%P 111P | 10/10/2020 | S-Riverdown Unstopabull-Red D-Ms-Aol Contenders Cassandra | Madelyn Beyer Columbus IN |
| *3288 Glaustar Roll A Dice-Red | 09/18/2020 | S-Loh Dice-Red-ET D-Glaustar Calif All Out-Red-ET | Delaney,Kalli & Cooper Barber & Sophie Leach Dewitt IA |
| 3289 Ruann War Apple-1017-Red 02-05 200 17,370 3.0% 515 2.9%P 509P | 09/16/2020 B&O | S-Mr Blondin Warrior-Red-ET D-Ruann Doc Apple-80503-ET | Stephen & Patrick Maddox Riverdale CA |
| 3290 Oneeda Warrior Lana | 09/12/2020 B&O | S-Mr Blondin Warrior-Red-ET D-Oneeda Alacazam Livid | Lookwell Farm and Oneeda Farm Elkhart IN |

| | | | |
|--------------------------------------|----------------|--------------------------------|---|
| *3291 Ms Ky-Blue Felicity-Red-ET | 09/11/2020 | S-Mr Blondin Warrior-Red-ET | Emmett Vannoy, Tre Wright, Charlie Elmore |
| 01-11 305 21,364 2.8% 601 3.0%P 634P | | D-Entourage-Lc Felicia-Red-ET | Eminence KY |
| 333 23,255 2.8% 659 3.0%P 696P | | | |
| 3292 Kozak Warrior Bombshell-Red | 09/10/2020 | S-Mr Blondin Warrior-Red-ET | R& F Livestock and Bill Schilling |
| 01-10 304 19,930 4.5% 902 3.9%P 769P | | D-Kozak Colt Brittney-Red | Cudworth SK |
| 3293 Ms Revive Rexha-Red-ET | 09/06/2020 | S-Riverdown Unstopabull-Red | Genetic Link |
| | | D-Ms-Aol Cntndr Revive-Red-ET | Somerset PA |
| *3294 Cherry-Lor Us Robust-Red-ET | 09/05/2020 | S-Riverdown Unstopabull-Red | Luke Tanis |
| 01-09 305 21,802 4.2% 909 3.3%P 721P | | D-Cherry-Lor Dbk Robin-Red-ET | Millmont PA |
| *3295 Kara-Kesh-RK Garnet-Red-ET | 09/05/2020 B&O | S-Loh Dice-Red-ET | Curtis, Evelyn & Agnes Griffin |
| 01-09 305 15,878 4.0% 627 3.5%P 547P | | D-Kara-Kesh-RK Our Gem-Red-ET | Thief River Falls MN |
| 365 19,457 4.0% 773 3.5%P 677P | | | |
| 3296 Ourway Moo-Lawn Aspire-Red | 09/04/2020 B&O | S-Cycle Dback Jackson-Red-TW | Lindsey Lepke and Ourway Cattle Co. |
| 02-03 144 12,990 3.3% 431 3.9%P 373P | | D-Moo-Lawn Lever Action-Red | Brooklyn WI |
| 3297 Miss Unstop Imallin-Red-ET | 09/03/2020 | S-Riverdown Unstopabull-Red | Eric Enright |
| | | D-Dj-Purepride Infra-Red-ET | Cascade WI |
| 3298 Sonnenbrook Ashanti-Red-ET | 09/03/2020 B&O | S-Farnear Altitude-Red-ET | Ryan Sonnenburg |
| | | D-Kamps-Js Dman Applepie-ET | Belleville WI |
| *3299 Kiko Awesred Marve 1858-Red | 09/02/2020 B&O | S-Luck-E Awesome-Red | Elizabeth Kiko |
| | | D-Kiko Hypnotic Maris | Salem OH |
| 3300 Winterfield Wr Luscious-Red | 09/02/2020 | S-Mr Blondin Warrior-Red-ET | William H Schilling |
| 02-06 83 7,314 3.5% 257 2.9%P 215P | | D-Winterfield J Next Love Red | Dectur MI |
| *3301 Briccows Wr Allstar-Red-ET | 09/01/2020 | S-Mr Blondin Warrior-Red-ET | Hailey Abraham |
| | | D-Ms Roll-N-View Althea-Red-ET | Harvard IL |

Class 632 Junior Three-Year-Old Cow

Born 03/01/2020 - 08/31/2020

Premiums: \$150, 135, 120, 100, 90, 80, 70, 60, 50, 40

1st Place Award presented by Starlight Acres, Karla Smieja, Little Falls, MN

Bred & Owned Award presented by Red & White Dairy Cattle Association

Production Rosette presented by Case IH, Racine, WI

Best Udder Rosette presented by Holstein International and Cattle Connection, Stiens, The Netherlands

Junior Premiums: \$50, 40, 30, 20

Junior Award presented by Lyons Holsteins, Doug & Lynnette Lyons and Family, Castalia, IA

| | | | |
|--------------------------------------|----------------|--------------------------------|--------------------------------|
| *3302 Kara-Kesh-RK Dfnt Sassy-Red | 07/30/2020 B&O | S-Scientific B Defiant-ET | Curtis, Evelyn & Agnes Griffin |
| 01-10 305 14,130 3.5% 488 3.1%P 431P | | D-Kara-Kesh-RK Ustbl Sage-Red | Thief River Falls MN |
| 344 15,662 3.5% 543 3.1%P 484P | | | |
| 3303 MS T-Triple-T TL Fame-Red | 07/18/2020 | S-Riverdown Unstopabull-Red | Oakfield Corners Dairy |
| 01-10 243 22,250 4.0% 897 3.2%P 707P | | D-Meadow Green Ferocity-Red-ET | Oakfield NY |
| 3304 Milksource Torrent-Red-ET | 07/17/2020 B&O | S-Farnear Altitude-Red-ET | Milk Source Genetics |
| 01-11 259 20,430 4.0% 808 3.1%P 627P | | D-Strans-Jen-D Tequila-Red | Kaukauna WI |
| 3305 Flower-Brook Giggles-Red | 06/30/2020 B&O | S-Lindenright Moovin-ET | Andrew Stuewe |
| 02-11 60 5,896 3.5% 205 3.0%P 177P | | D-Flower-Brook Gigi-Red-ET | Hamburg MN |

| | | | | | | | | | |
|-------|--|------------|-----|--|--|--|--|--------------------------------|--|
| *3306 | Kerndt Stump-R Stella-Red | 06/20/2020 | | | | | | S-Mr Blondin Warrior-Red-ET | Sarah Hill |
| | 02-00 286 22,870 6.1% 1,440 3.2%P 754P | | | | | | | D-Kerndt Star Stump-Red | Bristol VT |
| *3307 | Cherry-Lor Warrior Lime-Red | 06/14/2020 | | | | | | S-Mr Blondin Warrior-Red-ET | Phillip McCormick |
| | 02-00 300 22,887 3.4% 768 3.1%P 698P | | | | | | | D-Cherry-Lor Malone Lilac-Red | Millmont PA |
| *3308 | Opsahls Af Scarlet-Red-ET | 06/13/2020 | | | | | | S-St Gen Rr Applefree-Red-ET | Jessica & Cassey Hinsch |
| | 03-00 305 27,907 4.4% 1,223 2.8%P 785P | | | | | | | D-Opsahls Polo P Janna-Red | Goodhue MN |
| | 360 31,115 4.3% 1,376 2.6%P 897P | | | | | | | | |
| 3309 | Pineybrook Wrrior Chessi-Red | 06/06/2020 | | | | | | S-Mr Blondin Warrior-Red-ET | Brooklyn, Bryce & Blakely Kohls |
| | | | | | | | | D-Pineybrook C9 Crimson-Red | Arlington MN |
| *3310 | Quad-R Uns Helena-Red | 06/06/2020 | B&O | | | | | S-Riverdown Unstopabull-Red | Ian & Derek Schwartzlow |
| | | | | | | | | D-Arb-Flo-Spr Drg Heloise-Red | Monroe WI |
| 3311 | Wrightvale Jackson Love-Red | 06/05/2020 | | | | | | S-Cycle Dback Jackson-Red-TW | Blackjack Holsteins, MB Luckylady and T&L Cattle |
| | | | | | | | | D-Wrightvale Doorman Livvy | Wykoff MN |
| 3312 | Kozak Awesome Bianca-Red | 06/02/2020 | | | | | | S-Luck-E Awesome-Red | Westcoast Holsteins |
| | | | | | | | | D-Kozak Diamondback Red Brandy | Chilliwack BC |
| 3313 | Aot Rubels Hollie-Red-ET | 06/01/2020 | | | | | | S-Hoogerhorst Dg Oh Rubels-Red | Anthony and Kennedy Liddle |
| | | | | | | | | D-Aot Hawai Holly-ET | Argyle NY |
| *3314 | Dream-On Hotoffthepress-Red | 06/01/2020 | | | | | | S-Mr Blondin Warrior-Red-ET | Caleb, Josiah, Helena, Adrian, Ella Olson |
| | | | | | | | | D-Dream-On Db Hot Mess-Red | Lena WI |
| 3315 | Milksource Sephora-Red | 04/22/2020 | | | | | | S-FG Jacot-Red-ET | New Direction Ira |
| | | | | | | | | D-Miss Apple Snapple-Red | Lomira WI |
| 3316 | Rka-Lett Jrdy Annabelle-Red | 04/18/2020 | | | | | | S-Cycle McGucci Jordy-Red | Golden Oaks Farm |
| | | | | | | | | D-Rjohn Prestige Annie | Wauconda IL |
| 3317 | Glaustar Majestic Altitude-Red | 04/10/2020 | B&O | | | | | S-Farnear Altitude-Red-ET | Glaustar |
| | 01-11 305 21,224 3.8% 798 3.2%P 683P | | | | | | | D-Glaustar Jacot Majesty | Compton QC |
| | 362 24,476 3.8% 935 3.3%P 811P | | | | | | | | |
| 3318 | Cresti-Leigh Alicia P-Red | 03/19/2020 | | | | | | S-Luck-E Awesome-Red | R&F Livestock Inc. |
| | 03-01 86 8,530 3.1% 256 2.8%P 236P | | | | | | | D-Maple-Downs Andriana | Cudworth SK |
| 3319 | Apple-Pts Cranapple-Red-ET | 03/11/2020 | | | | | | S-Mr Blondin Warrior-Red-ET | Travis & Megan Schafer and Colganados Genetics |
| | 01-11 305 21,590 4.0% 868 3.1%P 667P | | | | | | | D-KHW Regiment Apple-Red-ET | Wisconsin Rapids WI |
| | 365 25,201 4.1% 1,024 3.1%P 790P | | | | | | | | |
| 3320 | Maple-Edge Calendr Girl-Red | 03/03/2020 | | | | | | S-Cycle McGucci Jordy-Red | Yvonne Preder |
| | 02-03 305 19,977 4.4% 880 3.2%P 644P | | | | | | | D-Budjon-Vail A Cover Girl-ET | Plymouth WI |
| | 340 21,560 4.4% 957 3.2%P 700P | | | | | | | | |
| *3321 | Schluter Atlanta-Red-ET | 03/02/2020 | | | | | | S-Farnear Altitude-Red-ET | Matthew and Elizabeth Gunst And Evan Hathaway |
| | 03-02 56 5,031 5.1% 255 3.0%P 152P | | | | | | | D-Hilrose Db Allie-Red-ET | Hartford WI |
| | 365 27,725 3.5% 973 3.0%P 827P | | | | | | | | |

| | | | | | |
|---|--|------------|-----|---------------------------------|--|
| 3322 | Air-Osa E-M Lovely27747-Red | 03/01/2020 | B&O | S-Cycle McGucci Jordy-Red | Duckett Holsteins, H & C Van Exel and Airosa Dairy |
| | 03-02 111 8,898 3.7% 325 2.6%P 232P | | | D-Ms Air-Osa Love 24242-Red-ET | Rudolph WI |
| 3323 | Cow-Palace Doppler 4123-Red | 03/01/2020 | | S-Scientific Doppler | Heatherstone Enterprises, Inc. |
| | 02-00 305 22,268 3.4% 760 3.1%P 706P | | | D-Thunder-Struck Dinkydo-Red | Baraboo WI |
| *3324 | Hilrose Altitude Audi-Red-ET | 03/01/2020 | B&O | S-Farnear Altitude-Red-ET | Bentley, Blake, Brodie & Kylie Brantmeier |
| | | | | D-Hilrose Advent Anna-Red-ET | Hilbert WI |
| Class 633 Senior Three-Year-Old | | | | | |
| Born 09/01/2019 - 02/29/2020 | | | | | |
| Premiums: \$150, 135, 120, 100, 90, 80, 70, 60, 50, 40 | | | | | |
| 1st Place Award presented by Jefe Nutrition, Inc., St-Hyacinthe, QC, Canada | | | | | |
| Bred & Owned Award presented by Red & White Dairy Cattle Association | | | | | |
| Production Rosette presented by Case IH, Racine, WI | | | | | |
| Best Udder Rosette presented by Holstein International and Cattle Connection, Stiens, The Netherlands | | | | | |
| Junior Premiums: \$50, 40, 30 | | | | | |
| Junior Award presented by Troy's Transport, Troy & Sarah Wendorf, Ixonia, WI | | | | | |
| 3325 | Ronleen Warrior Veronica | 01/10/2020 | | S-Mr Blondin Warrior-Red-ET | Robella & T&L |
| | 01-11 305 20,635 3.0% 619 3.2%P 650P | | | D-Willows-Edge-I Defiant Velour | Balgonie SK |
| 3326 | Culler Splendid Gift-Red | 12/23/2019 | B&O | S-Pine-Tree Splendid-P-ET | Jay R Ackley, Ken Janes, Culler Farms, LLC |
| | 02-02 305 24,686 3.4% 909 3.0%P 750P | | | D-Culler Santana 1226 | East Liberty OH |
| 3327 | Pottsdale Alti Tana-Red-ET | 12/19/2019 | | S-Farnear Altitude-Red-ET | Elmvue Farm |
| | 03-05 60 7,319 9.9% 786 2.7%P 195P | | | D-Ms Pottsdale Tangelo-Red-ET | Johnstown NY |
| 3328 | Willye Srdntous Legacy-Red | 12/10/2019 | | S-Mr Blondin Warrior-Red-ET | Oakfield Corners Dairy |
| | 03-03 150 100 3.5% 3 3.2%P 3P | | | D-Willye Arvis Sparkle-Red | Oakfield NY |
| 3329 | Crescentmead Jaurora-Red-ET | 12/04/2019 | | S-Cycle McGucci Jordy-Red | Brooklyn, Bryce & Blakely Kohls |
| | | | | D-Westphalia Ss Amaryllis-Red | Arlington MN |
| 3330 | Duckett Th Boomer-Rang-Red | 12/04/2019 | | S-Farnear Altitude-Red-ET | Heatherstone Enterprises, Inc. |
| | 02-01 305 21,340 4.0% 858 3.4%P 729P | | | D-Duckett Doorman Becca | Baraboo WI |
| 3331 | Oakfield US Cheerful-Red-ET | 12/04/2019 | B&O | S-Riverdown Unstopabull-Red | Jonathan & Alicia Lamb |
| | 02-03 305 28,690 3.8% 1,077 3.1%P 902P | | | D-Oakfield Abs Candy-Red | Oakfield NY |
| | 357 33,050 3.8% 1,266 3.2%P 1,057P | | | | |
| 3332 | Golden-Oaks Temptres-Red-ET | 12/03/2019 | | S-Riverdown Unstopabull-Red | Milk Source, Fischer, Steincrest & Crescentmead |
| | | | | D-Miss Pottsdale Dfi Tang-Red | Kaukauna WI |
| 3333 | Nrmcgk Jrdy Arabella-Red-TW | 12/02/2019 | | S-Cycle McGucci Jordy-Red | Chris & Jennifer Hill & Ackley Holsteins |
| | 03-04 159 19,443 4.1% 805 3.1%P 595P | | | D-Ms Apple Aupperie-Red-ET | East Liberty OH |
| *3334 | Egl-Acres Jordy Lovejoy-Red | 12/01/2019 | | S-Cycle McGucci Jordy-Red | Isaac Folts |
| | 03-03 154 25,979 4.2% 1,077 2.8%P 782P | | | D-Milksource Lovebug-Red | North Collins NY |
| 3335 | Londan Dairy Bjangle-Red-ET | 12/01/2019 | | S-Luck-E Awesome-Red | Doeberiener, Bowen and Schilling |
| | | | | D-Roll-N-View Def Bojangles | West Salem OH |
| 3336 | Apple-Pts Addie-Red-ET | 10/02/2019 | | S-Mr Blondin Warrior-Red-ET | Jamie Judd and Mike Deaver |
| | 03-07 117 11,234 4.4% 501 3.1%P 357P | | | D-KHW Regiment Apple-Red-ET | LaValle WI |

| | | | | |
|-------|---|------------|-------------------------------|--|
| *3337 | Ronleen Jordy Evangelina | 09/22/2019 | S-Cycle McGucci Jordy-Red | Cale Baker and Regan Pries |
| | 03-03 210 25,223 4.1% 1,024 2.9%P 731P | | D-Ronleen Redneck Estelle | Maynard IA |
| *3338 | Silver-Mist Malena-Red-ET | 09/10/2019 | S-Cycle MCGucci Jordy-Red | Lilly Elsass |
| | 02-06 305 20,375 3.5% 710 3.2%P 654P | | D-Greenlea Bw Mar-Red-ET | Wapakoneta OH |
| *3339 | Trav-Annah Fantasy-Red-ET | 09/03/2019 | S-Cycle McGucci Jordy-Red | Megan Moede & Logan Guillette |
| | | | D-Oakfield-Bro Fritz-Red-ET | Algoma WI |
| 3340 | Ms Raps Jordy Ridley-Red-ET | 09/02/2019 | S-Cycle McGucci Jordy-Red | Bridgerland Holsteins & Delon Mortimer |
| | | | D-Parkvue Absolute Rap-ET | Newton UT |
| 3341 | Oakfield Sandstorm-Red-ET | 09/01/2019 | B&O S-Mr D Apple Diamondback | Jonathan & Alicia Lamb |
| | 02-00 305 19,110 3.6% 687 2.9%P 562P | | D-Stony-Pillar Sharmaine-Red | Oakfield NY |
| | 365 22,270 3.7% 827 3.0%P 679P | | | |
| Class | 634 Intermediate Champion Female of the Junior Show | | | |
| | Award presented by Double S Liquid Feed Services, Inc., Danville, IL | | | |
| | Champion Banner presented by St. Jacobs ABC, DeForest, WI | | | |
| | Rosette presented by Doug & Linda Hodorff, Eden, WI | | | |
| Class | 635 Reserve Intermediate Champion Female of the Junior Show | | | |
| | Award presented by St-Yle Holsteins, Belmont, WI | | | |
| | Reserve Champion Banner and Rosette presented by St. Jacobs ABC, DeForest, WI | | | |
| Class | 636 Intermediate Champion Female | | | |
| | Eugene Nelson Intermediate Champion Award presented by Luck-E Holsteins, Hampshire, IL | | | |
| | Champion Banner presented by Semex/Boviteq, Madison, WI | | | |
| | Rosette presented by GenOvations, Lodi, WI | | | |
| Class | 637 Reserve Intermediate Champion Female | | | |
| | Award presented by Luck-E Holsteins, Hampshire, IL | | | |
| | Reserve Champion Banner presented by Semex/Boviteq, Madison, WI | | | |
| | Rosette presented by Phibro Animal Health Corp., Quincy, IL | | | |
| Class | 638 Four-Year-Old Cow | | | |
| | Born 09/01/2018 - 08/31/2019 | | | |
| | Premiums: \$150, 135, 120, 100, 90, 80, 70, 60, 50, 40 | | | |
| | 1st Place Award presented by Cowsmopolitan Dairy Magazine, Hammond, WI | | | |
| | Bred & Owned Award presented by Red & White Dairy Cattle Association | | | |
| | Production Rosette presented by Case IH, Racine, WI | | | |
| | Best Udder Rosette presented by Holstein International and Cattle Connection, Stiens, The Netherlands | | | |
| | Junior Premiums: \$50, 40, 30 | | | |
| | Junior Award presented by Apple Partners, LLC, Lanark, IL | | | |
| *3342 | Synergy Spikes Sequel-Red | 08/07/2019 | S-Farnear Altitude-Red-ET | Jacob & Claire Betley & Evan Jauquet |
| | | | D-Synergy Jordys Spike-Red-ET | Pulaski WI |
| 3343 | Ruann Alt Shar-93679-ET | 06/24/2019 | B&O S-Farnear Altitude-Red-ET | Stephen & Patrick Maddox |
| | 02-11 305 32,470 4.3% 1,395 3.2%P 1,038P | | D-Ruann D-B Shar-60985-Red-ET | Riverdale CA |
| | 317 33,330 4.3% 1,433 3.2%P 1,069P | | | |
| *3344 | Cache-Valley Def Haizly-Red | 06/14/2019 | S-Scientific B Defiant-ET | Xander Harris |
| | | | D-Cache-Valley Ladybug-Red-ET | Richmond UT |
| 3345 | Ziems-Drns A Amazing-Red-ET | 06/11/2019 | S-Farnear Altitude-Red-ET | Andy Stuewe and Corey Feltmann |
| | 03-07 207 20,671 3.7% 771 3.1%P 631P | | D-Greenlea Ad Ace-Red-ET | Hamburg MN |

| | | | |
|---|----------------|--|--|
| 3346 Spungold-Hc Jordy Rose-Red 02-00 305 22,483 3.8% 853 3.1%P 703P | 06/06/2019 B&O | S-Cycle McGucci Jordy-Red D-Spungold-Hc Rosie-Red | Dale & Deanna Bendig Gettysburg PA |
| 3347 Apple-Pts Cirio Anna-Red-ET 02-01 305 19,594 5.4% 1,051 3.5%P 593P 365 22,179 5.4% 1,187 3.6%P 790P | 06/01/2019 | S-Lookout P Redburst-Red-ET D-KHW Regiment Apple-Red-ET | Paolo Grendene Cavaglia Biella Italy |
| *3348 Ranway Russ Disco 215-Red 02-02 305 29,210 3.6% 1,055 3.0%P 874P 365 34,980 3.6% 1,242 3.0%P 1,047P | 06/01/2019 | S-Wormont Russ PP-Red-ET D-Ranway California DJ 8-Red | Chloe & Claire Lamb Oakfield NY |
| 3349 Cashells Un Cutie-Red-ET 04-02 76 9,545 3.2% 309 2.7%P 261P | 03/16/2019 | S-Riverdown Unstopabull-Red D-Oakland-View H Champ-Red-ET | Elmvue Farm Johnstown NY |
| 3350 Macs-Bhf Disorderly-Red 03/05/2019 B&O | | S-Luck-E Awesome-Red D-Macs-Acres Dy 523 | D & H Yoder and S & T McMahan West Salerm OH |
| 3351 Premium Apple Crisp Lilly-Red 04-01 120 17,704 3.3% 584 2.7%P 480P | 03/02/2019 | S-Seimers Oct Apple Crisp D-Premium Lotus Star | Juniper Farm Gray ME |
| 3352 Milksource Tantrum-Red-ET 03-03 305 34,011 4.3% 1,468 2.9%P 997P | 12/18/2018 B&O | S-Riverdown Unstopabull-Red D-Strans-Jen-D Tequila-Red-ET | Milk Source Genetics Kaukauna WI |
| 3353 Shanalta Unstopabull Reanna-Red 04-06 60 6,462 4.1% 266 2.5%P 159P | 12/17/2018 | S-Riverdown Unstopabull-Red D-Shanalta Advantage Reanna | Elmvue Farm Johnstown NY |
| 3354 Reyncrest Diamndbk Cici-Red 12/07/2018 B&O | | S-Mr D Apple Diamondback D-Reyncrest Gc Cabo-ET | Tyler & Kelly Reynolds Corfu NY |
| 3355 Ms Raps Ustp Rummy-Red-ET 03-04 305 36,009 4.5% 1,634 3.2%P 1,151P | 12/06/2018 | S-Riverdown Unstopabull-Red D-Parkvue Absolute Rap-Red-ET | Michael Maier Stitzer WI |
| *3356 Plum-Line Chili Pepper-Red 12/06/2018 B&O | | S-Mr D Apple Diamondback D-Plum-Line Absolute Calypso | Brooke Carey Titusville PA |
| *3357 Wsc Jordy Miss Me-Red-ET 09/23/2018 B&O | | S-Cycle McGucci Jordy-Red D-Greenlea Gw Milly-Red-ET | Hayden Weaver Ephrata PA |
| *3358 Holbric Ammo Chills-Red 02-08 305 23,623 3.8% 898 3.1%P 731P 365 26,385 3.8% 1,032 3.1%P 826P | 09/23/2018 B&O | S-Mr Leaninghouse Ammo-P-ET D-Holbric Action Chill-Red | Peyton B, Elena E & Bria Olbrich Harvard IL |
| *3359 Silver-Mist My Lady-Red-ET 03-08 305 27,166 3.2% 838 3.0%P 814P | 09/11/2018 | S-Dymentholm Mr App Avalanche-TW D-Greenlea Bw Mar-Red-ET | Lilly Elsass Wapakoneta OH |
| *3360 Gaedtke Jordy Edna-Red-ET 03-02 305 26,456 4.4% 1,168 3.3%P 894P | 09/08/2018 B&O | S-Cycle McGucci Jordy-Red D-Gaedtke Absolute Ellie-Red | Mercedes & Jade Kroll and Alexys Gaedtke Luxemburg WI |
| *3361 Net-A-Way Salvtr Marsha-Red 03-02 305 35,010 3.3% 1,168 3.3%P 1,139P | 09/02/2018 | S-Mr Salvatore RC-ET D-Net-A-Way Rager Margie-Red | Kasey Clanton & Mackenzie Krausz Mulberry Grove IL |
| *3362 Kara-Kesh-RK Ustbl Sage-Red 04-00 295 31,653 3.1% 978 3.1%P 970P | 09/01/2018 B&O | S-Riverdown Unstopabull-Red D-Kara-Kesh-RK Sparrow-Red | Curtis, Evelyn & Agnes Griffin Thief River Falls MN |

Class 639 Five-Year-Old Cow

Born 09/01/2017 - 08/31/2018

Premiums: \$150, 135, 120, 100, 90, 80, 70, 60, 50, 40

1st Place Award presented by Ja-Bob Holsteins, Eaton, OH

Bred & Owned Award presented by Red & White Dairy Cattle Association

Production Rosette presented by Case IH, Racine, WI

Best Udder Rosette presented by Holstein International and Cattle Connection, Stiens, The Netherlands

Junior Premiums: \$50, 40, 30

Junior Award presented by International Protein Sires, Rock Springs, WI

| | | | | | |
|-------|--|------------|-----|---|---|
| 3363 | Doublew-Pc Goldwyn Rosy-Red | 08/16/2018 | | S-D&D Deb Goldwyn-P-Red-ET D-Doublew-Pc Altatitleist 291 | Sarah Hill Bristol VT |
| 3364 | Ruann Jordy Shar-80698-Red 03-04 305 31,430 3.4% 1,078 2.8%P 893P 313 32,070 3.4% 1,096 2.8%P 914P | 08/05/2018 | B&O | S-Cycle McGucci Jordy-Red D-Ruann Diamond Shar-64938-ET | Stephen & Patrick Maddox Riverdale CA |
| 3365 | Ransom-Rail Beth-Red 04-01 305 34,120 3.9% 1,323 3.1%P 1,064P | 06/01/2018 | B&O | S-Riverdown Unstopabull-Red D-Ms Absolute Bliss-Red-ET | Milk Source, Ransom-Rail and Fischer Kaukauna WI |
| 3366 | Sunny-Valley Freckles-Red 04-01 305 27,727 4.8% 1,318 3.2%P 890P 333 30,443 4.7% 1,431 3.2%P 983P | 06/01/2018 | B&O | S-Mr Hotstuffs Hypnotic-ET D-Sunny-Valley Dbk Flash-Red | Wayne Debuhr Sun Prairie WI |
| 3367 | Milksource Renaissance-Red | 03/20/2018 | | S-Cycle McGucci Jordy-Red D-Milksource Wire Racket-Red | Golden Oaks Farm Wauconda IL |
| 3368 | Miss Pretty Playful-Red-ET 04-07 305 29,830 3.0% 881 3.3%P 984P 319 29,830 3.0% 881 3.3%P 984P | 03/04/2018 | | S-Dymenthalm Mr App Avalanche-TW D-Robin-Hood Pretty In-Red | Maple-Downs Farms II and Peter Vail Middleburgh NY |
| 3369 | Savage-Leigh Selser-Red-ET | 12/09/2017 | | S-Mr D Apple Diamondback D-Redtag Destry Sneezzy | Westcoast Holsteins Chilliwick BC |
| 3370 | Micheret Tallfy Barbican-Red 05-06 57 6,689 3.7% 247 2.8%P 187P | 12/08/2017 | | S-Drakkar Barbican-ET D-Micheret Firstall Nutella | Elmvue Farm Johnstown NY |
| 3371 | Mosnang Ammo Whisky 7-Red-ET 04-02 305 38,577 3.7% 1,417 3.1%P 1,197P 365 43,584 3.8% 1,656 3.2%P 1,378P | 12/05/2017 | | S-Mr Leaninghouse Ammo-P-ET D-Mosnang Destry Whiskey-Red-ET | Andy Stuewe and Corey Feltmann Hamburg MN |
| 3372 | Star-Ky-Blue Adelaide-Red-ET | 12/04/2017 | | S-FG Jacot-Red-ET D-KHW Regiment Apple 2-Red-ETN | Golden Oaks Farm Wauconda IL |
| *3373 | Luck-E Jordy Kayla-Red-ET 05-01 231 21,264 4.3% 920 3.0%P 631P | 10/21/2017 | | S-Cycle McGucci Jordy-Red D-Luck-E Advent Kandie-Red-ET | M & E Gunst, and L, H & B Smith Watertown WI |
| 3374 | Juniper Dback Missy-Red-ET 04-03 305 35,292 3.5% 1,229 3.0%P 1,060P | 10/11/2017 | B&O | S-Mr D Apple Diamondback D-Jon Lu Picolo Missy | Juniper Farm Gray ME |
| *3375 | Hardwood Agent Breala-Red 05-11 305 30,357 4.6% 1,395 3.1%P 946P | 09/21/2017 | | S-Siemers Agent-Red-ET D-Hardwood I Bricole | Abby Fairbanks Anamosa IA |
| 3376 | Heatherstone Regal-Red 04-08 305 30,453 4.6% 1,404 3.1%P 945P 365 34,179 4.6% 1,582 3.1%P 1,075P | 09/14/2017 | B&O | S-Dymenthalm Mr App Avalanche-TW D-Heatherstone Rhinestone-Red | Heatherstone Enterprises, Inc. Baraboo WI |

| | | | | |
|---|--|----------------|----------------------------------|---|
| *3377 | Apple-Pts Abrianna-Red-ET | 09/12/2017 | S-Lookout P Redburst-Red-ET | Nevin F T Erbsen |
| | 03-11 305 25,326 4.6% 1,161 3.3%P 838P | | D-KHW Regiment Apple-Red-ET | Lanark IL |
| | 365 28,517 4.6% 1,298 3.3%P 953P | | | |
| *3378 | Windy-Knoll-View Phirey-Red | 09/08/2017 | S-Scientific B Defiant-ET | Caleb, Josiah, Helena, Adrian, Ella Olson |
| | | | D-Windy-Knoll-View Patient | Lena WI |
| *3379 | Garay Red Diamond-Red-ET | 09/02/2017 | S-Mr D Apple Diamondback | Landree & Dakota Fraley |
| | 05-00 277 30,818 4.1% 1,252 3.1%P 941P | | D-Willowhaven Goldwyn Bliss-ET | Millmont PA |
| *3380 | Digangi Defiant Lucky-Red | 09/01/2017 B&O | S-Scientific B Defiant-ET | Mya Digangi |
| | 05-05 162 12,836 3.9% 507 2.8%P 357P | | D-Sunny-Views Luau-Red | Watertown WI |
| 3381 | I-Rainbow Dubday Karat | 09/01/2017 B&O | S-Bacon-Hill Dubday 2929-Red | Rainbow Dairy LLC |
| | 04-10 287 26,924 3.8% 1,029 2.9%P 793P | | D-I-Rainbow Ducati-Redoak-Red | Richland Center WI |
| Class 640 Aged Cow, Six-Year-Old & Older | | | | |
| Born before 08/31/2017 | | | | |
| Premiums: \$150, 135, 120, 100, 90, 75, 70 | | | | |
| 1st Place Award presented by Bella-View Holsteins, Lynn & Sara Harbaugh, Marion, WI | | | | |
| Bred & Owned Award presented by Red & White Dairy Cattle Association | | | | |
| Production Rosette presented by Case IH, Racine, WI | | | | |
| Best Udder Rosette presented by Holstein International and Cattle Connection, Stiens, The Netherlands | | | | |
| Junior Premiums: \$50 | | | | |
| Junior Award presented by Mystic Valley Dairy, LLC, Sauk City, WI | | | | |
| 3382 | Glaustar Calif All Out-Red-ET | 08/02/2017 | S-EK-STJ California-Red-ET | Jay Ackley and Donald E Simpson |
| | 05-07 207 22,085 3.6% 791 2.8%P 624P | | D-Lookout Olympian Alstar-Red-ET | East Liberty OH |
| 3383 | Apple-Pts Astonish-Red-ET | 03/27/2017 | S-Scientific B Defiant-ET | Makenzie & Callen Ferris |
| | 05-02 305 32,526 3.8% 1,235 3.4%P 1,105P | | D-KHW Regiment Apple-Red-ET | Soap Lake OR |
| 3384 | Vogue Loyola Macy Pp-Red-ET | 01/02/2017 | S-Zimmerview Wonka Loyola-P | Showbox Sires and Alh Genetics |
| | 04-09 305 31,536 4.7% 2,295 3.5%P 1,738P | | D-Calbrett Kingboy Miranda P-ET | Rudolph WI |
| 3385 | Wil-O-Mar Diamndbk Rose-Red | 12/16/2016 | S-Mr D Apple Diamondback | Elmvue Farm |
| | 04-06 257 9,409 3.1% 293 3.1%P 292P | | D-Wil-O-Mar Moses Rachel | Johnstown NY |
| 3386 | Sunrose Jet-Red-ET | 07/01/2016 B&O | S-Scientific B Defiant-ET | Bryce & Brant Gingerich |
| | 04-08 305 26,580 4.0% 1,057 3.2%P 854P | | D-Sunrose Jess | Millersburg IN |
| | 365 29,747 4.1% 1,215 3.3%P 981P | | | |
| 3387 | Oakfield Addictio Emoji-Red | 06/01/2016 B&O | S-Mr Ansly Addiction-P-Red-ET | Jonathan & Alicia Lamb |
| | 05-01 305 31,730 4.3% 1,351 3.4%P 1,082P | | D-Oakfield Absol Emma-Red-ET | Oakfield NY |
| | 365 44,470 4.1% 1,834 3.3%P 1,470P | | | |
| *3388 | Luck-E Diamond Tonto-Red | 03/28/2016 | S-Mr D Apple Diamondback | Jacob Menzi |
| | 05-10 305 22,216 4.4% 980 3.4%P 757P | | D-Luck-E Ability Tonto | Millport NY |
| | 360 24,662 4.4% 1,079 3.4%P 843P | | | |
| 3389 | Sellcrest D Cheeto-Red | 03/01/2016 | S-She-Ken Bw Dunkin-Red-ET | Coltan & Eastan Brown |
| | 07-03 48 5,437 3.4% 184 3.0%P 162P | | D-Sellcrest Cathy-Red | Strum WI |
| *3390 | Schluter Shelby Lee-Red-ET | 12/04/2015 | S-Luck-E Awesome-Red | Caleb, Josiah, Helena, Adrian, Ella Olson |
| | | | D-Helmcrest Destry Sarha Lee-Red | Lena WI |

| | | | | | |
|---|------------------------------|------------|------------|--------------------------------|--|
| 3391 | Macland Awe Juliet-Red-ET | 10/01/2015 | B&O | S-Luck-E Awesome-Red | Scott Culbertson and James McFarland |
| | 05-08 | 305 22,220 | 4.5% 994 | 3.6%P 789P | D-Macland Advent Juliet-Red |
| | | 365 25,470 | 4.6% 1,168 | 3.6%P 928P | Elgin MN |
| 3392 | Westcoast Defiant Addison | 12/11/2014 | B&O | S-Scientific B Defiant-ET | Westcoast Holsteins |
| | | | | D-KHW Regiment Apple 3-Red-ETN | Chilliwack BC |
| 3393 | Colganados D Avianca-Red-ET | 08/03/2013 | | S-Scientific Destry-ET | Jonathan & Alicia Lamb |
| | 08-09 | 305 39,920 | 4.1% 1,624 | 3.1%P 1,230P | D-KHW Regmnt Apple A1-Red-ETN |
| | | 365 46,580 | 4.1% 1,894 | 3.1%P 1,463P | Oakfield NY |
| Class 641 125,000 lb. Production Cow | | | | | |
| Born before 08/31/2018 | | | | | |
| Lifetime milk production over 125,000 lb. milk. Official milk production sheets are required. | | | | | |
| Premiums: \$150, 135, 120, 100, 90 | | | | | |
| 1st Place Award presented by Road View Dairy Holsteins, the Yager Family, Mineral Point, WI | | | | | |
| Bred & Owned Award presented by Red & White Dairy Cattle Association | | | | | |
| Production Rosette presented by Case IH, Racine, WI | | | | | |
| Best Udder Rosette presented by Holstein International and Cattle Connection, Stiens, The Netherlands | | | | | |
| Junior Premiums: \$50 | | | | | |
| Junior Award presented by Heart & Soul Holsteins, Millmont, PA | | | | | |
| *3394 | Hardwood Agent Breala-Red | 09/21/2017 | | S-Siemers Agent-Red-ET | Abby Fairbanks |
| | 05-11 | 305 30,357 | 4.6% 1,395 | 3.1%P 946P | D-Hardwood I Bricole |
| | | | | | Anamosa IA |
| *3395 | ZBW-Ziems Listen To Me-Red | 09/10/2015 | B&O | S-Mr Apples Armani-ET | Mason Ziemba |
| | 03-02 | 305 34,208 | 4.1% 1,412 | 3.2%P 1,110P | D-Ziems Reality Lol-Red |
| | | 316 35,070 | 4.1% 1,455 | 3.2%P 1,139P | Durhamville NY |
| 3396 | Rosedale Pretty Fancy In-Red | 09/02/2015 | | S-Mr Apples Armani-ET | Ballweg Hickory Hills |
| | 03-09 | 305 34,257 | 4.6% 1,591 | 3.8%P 1,299P | D-Rosedale Perfect In-Red-ET |
| | | 365 39,889 | 4.7% 1,891 | 3.8%P 1,534P | Dane WI |
| *3397 | Holbric Spa Chisel-Red | 06/10/2015 | B&O | S-Holbric-MI Spa-ET | Peyton B, Elena E & Bria Olbrich |
| | 06-00 | 305 33,089 | 4.9% 1,606 | 3.1%P 1,010P | D-Holbric Advent Chili |
| | | 365 39,140 | 4.9% 1,891 | 3.1%P 1,223P | Harvard IL |
| 3398 | Cherry-Lor Ladd Ripple-Red | 03/01/2014 | B&O | S-Tiger-Lily Ladd P-Red-ET | Douglas R Boop & Cael Hembury |
| | 07-03 | 305 31,228 | 4.1% 1,285 | 3.3%P 1,022P | D-Tiger-Lily Aaron Sheila-Red |
| | | 365 37,370 | 4.1% 1,545 | 3.3%P 1,235P | Millmont PA |
| 3399 | Highcroft Absolute Lily-Red | 10/28/2013 | | S-Apples Absolute-Red-ET | Glamourview-lager & Walton and Eaton Holsteins |
| | 09-09 | 305 32,740 | 4.8% 1,533 | 3.4%P 1,128P | D-Imperial-Ridge Lil-Red |
| | | 365 45,830 | 4.4% 1,938 | 3.3%P 1,430P | Marietta NY |
| 3400 | Pamprd-Acres Ab Ivy-Red-ET | 09/14/2013 | | S-Apples Absolute-Red-ET | Johnathan Heinsohn and Timothy Ziemba |
| | 09-05 | 163 20,244 | 4.0% 799 | 3.1%P 636P | D-Greenlea-Tm Real Ab-Red-ET |
| | | 365 34,227 | 3.7% 1,263 | 3.3%P 1,112P | Watertown WI |

Class 642 Holstein Marketplace Sires International Type & Production Award

Award presented by Holstein Marketplace Sires, Brattleboro, VT

Class 643 Senior Best Three Females

All animals, Yearling in Milk and older, must be bred with same prefix by exhibitor with at least one owned by exhibitor.

Premiums: \$75, 65, 50

1st Place Award presented by Oakfield Corners Dairy, Jonathan & Alicia Lamb, Oakfield, NY

- 3401 Andrew Stuewe
Hamburg MN
- 3402 Apple Partners LLC
Lanark IL
- 3403 Cael Hembury
Millmont PA
- 3404 Glaustar
Compton QC
- 3405 Oakfield Corners Dairy
Oakfield NY
- 3406 Owen & Kendyll Kress
Newton WI
- 3407 Reggie & Krysty Kamps
Darlington WI
- 3408 Ryan Griffin
Thief River Falls MN

Class 644 Produce of Dam

Two animals, any age, produce of one cow. Dam must be named. Animals need not be owned by one exhibitor.

Premiums: \$75, 65, 50

1st Place Award presented by Red & White Dairy Cattle Association

- 3409 Brian Joseph Enright
Winchester ON
D-Milksource Defi Tazu-Red
- 3410 C, K, & G Grinstead G & J Boyke
F WI
D-Lyn-Vale Cherry Wine-Red-ET
- 3411 Claire & Jacob Betley
Pulaski WI
D-OCD Lionking
- 3412 Karnview Farms
Woodstock, Ontario ON
D-Ty-D Archival Azuli
- 3413 Lilly Elsass
Wapakoneta OH
D-Greenlea Bw Mar-Red-ET
- 3414 Nevin F T Erbsen
Lanark IL
D-Khw Regiment Apple-Red-ET
- 3415 Owen & Kendyll Kress
Newton WI
D-Ms Kress-Hil Sapphire-Red-ET
- 3416 Owen & Kendyll Kress
Newton WI
D-Ms Kress-Hil Sapphire-Red-ET

3417 Stephen & Patrick Maddox
Riverdale CA D-Ruann D-B Shar-60985-Red-ET

Class 645 Dam and Daughter

Two animals, a dam and daughter. Dam must be named. Animals need not be owned by one exhibitor.
Premiums: \$75, 65, 50
1st Place Award presented by Crescentmead, Ixonia, WI

3418 Ackley, Plainfield, Biershank
East Liberty OH D-Glaustar Calif All Out-Red-ET

3419 Jay Ackley
East Liberty OH D-Glaustar Calif All Out-Red-ET

3420 Ryan Griffin
Thief River Falls MN D-Kara-Kesh-Rk Ustbl Sage-Red

Class 646 Champion Bred & Owned of the Junior Show

All first place animals from each of the milking classes, bred and owned by a junior exhibitor (as defined by the Red & White Dairy Cattle Association's Junior Bred & Owned definition), are eligible.
Award presented by Crescentmead, Ixonia, WI
Rosette presented by Red & White Dairy Cattle Association

Class 647 Champion Bred & Owned

All first place animals from each of the milking classes, bred and owned by exhibitor, are eligible.
Premiums: \$240
Award presented by Luck-E Holsteins, Hampshire, IL
Champion Rosette presented by Red & White Dairy Cattle Association

Class 648 Senior Champion Female of the Junior Show

Award presented by Crescentmead, Ixonia, WI
Champion Banner presented by GenOvations, Lodi, WI
Rosette presented by Doug & Linda Hodorff, Eden, WI

Class 649 Reserve Senior Champion Female of the Junior Show

Award presented by Forest Ridge Holsteins, Eden, WI
Reserve Champion Banner presented by GenOvations, Lodi, WI
Rosette presented by St. Jacobs ABC, DeForest, WI

Class 650 Grand Champion Female of the Junior Show

Lillian & Keith King and Jim King Grand Champion of the Junior Show Award presented by Kingsdale Farms, Victoria, IL
\$500 Udder Comfort Grand Champion Award presented by Udder Comfort Inc., Williamsburg, ON, Canada
Grand Champion Trophy presented by World Dairy Expo
Champion Banner presented by Select Sires, Inc., Plain City, OH
Rosette presented by Doug & Linda Hodorff, Eden, WI
Award courtesy of Red & White Dairy Cattle Association

Class 651 Reserve Grand Champion Female of the Junior Show

Award presented by Oakfield Corners Dairy, Jonathan & Alicia Lamb, Oakfield, NY
Lillian & Keith King and Jim King Reserve Grand Champion of the Junior Show Award presented by Kingsdale Farms, Victoria, IL
Reserve Champion Banner presented by Select Sires, Inc., Plain City, OH
Rosette presented by St. Jacobs ABC, DeForest, WI

Class 666 Senior Champion Female

James Crowley, Sr. Senior Champion Award presented by Stone Oak Genetics, Courtney & Duncan Bailey, Valley Falls, NY
Champion Banner and Rosette presented by GenOvations, Lodi, WI

Class 667 Reserve Senior Champion Female

Award presented by EskDale Dairy, John Conrad, Eskdale, UT
Reserve Champion Banner presented by GenOvations, Lodi, WI
Rosette presented by Phibro Animal Health Corp., Quincy, IL

Class 668 Grand Champion Female

Allen Hetts Grand Champion Trophy presented by World Dairy Expo
\$1,000 Udder Comfort Grand Champion Award presented by Udder Comfort Inc., Williamsburg, ON, Canada
Champion Banner presented by Select Sires, Inc., Plain City, OH
Rosette presented by GenOvations, Lodi, WI
Award courtesy of Red & White Dairy Cattle Association

Class 669 Reserve Grand Champion Female

Award presented by Double S Liquid Feed Services, Inc., Danville, IL
Reserve Champion Banner presented by Select Sires, Inc., Plain City, OH
Rosette presented by Phibro Animal Health Corp., Quincy, IL

Class 670 Best Uddered Cow

Award presented by Tim Baumgartner, Tulare, CA

Class 691 Premier Breeder

Royal Banner presented by Agpro, Inc., Paris, TX

Class 692 Premier Exhibitor

Royal Banner presented by Select Sires, Inc., Plain City, OH

Class 693 Premier Sire

Ted Kreuger Premier Sire Royal Banner presented by Five-G Consulting, Reno, TX

List of Exhibitors - Red White

| ID | Name | Farm Name | State |
|-------|---|---------------------------|-------|
| 12203 | Aries Derby | 3-D Farm | MO |
| 11324 | Jay Ackley | Ack-Lee Reg Holsteins | OH |
| 13066 | Kenlee Philips | Ak-Philips | TX |
| 12265 | Allyn, Hovden and Gibbs | Allyndale Holsteins | CT |
| 4304 | Apple Partners LLC | Apple Partners | IL |
| 12441 | Genetics Link | Ashley Kaufman | PA |
| 10003 | Ballweg Hickory Hills | Ballweg Hickory Hills | WI |
| 14119 | Levi, Kailey & Shawn Banowetz | Banowetz Genetics | IA |
| 13761 | Beckridge Holsteins | Beckridge Holsteins | ON |
| 13517 | Jaydn & Kennedy Kimball | Beech Haven Ladies | ME |
| 13465 | Kale, Kley, Ryan, Logan Beer | Beer Cattle Co. | IN |
| 10211 | Brian, Traci & Landon Neely | Bell Valley Farm | PA |
| 11603 | J, L & M Harbaugh and A & A Loehr | Bella-Ridge | WI |
| 11577 | J L & M Harbaugh and D & C Ryan | Bella-View Holsteins | WI |
| 5512 | J, L & M Harbaugh and A & A Loehr | Bella-View Holsteins | WI |
| 13461 | Mitchell Kieffer | Belmoral Farms | ON |
| 11709 | Claire & Jacob Betley | Betley Farms | WI |
| 13541 | Jacob & Claire Betley & Evan Jauquet | Betley Farms | WI |
| 9897 | Kasey Clanton | B-J-Grove Holsteins | IL |
| 13505 | Kyla and Ally Sickafoose | Black N Crimson Holsteins | IN |
| 11752 | Blackjack Holsteins | Blackjack Holsteins | MN |
| 11129 | Blackstone Genetics-Zachary Damrow Family | Blackstone Genetics | ID |
| 11966 | E, I & E Staudinger and L & L Kuester | Blue Royal Dairy LLC | WI |
| 11939 | Kelly & Kendall O'Connor | Bluff-Ridge | IL |
| 12137 | Gabriel, Keyanna, Rylen & Titus Mentink | Bovisync | WI |
| 13311 | Evan, Alexa, Rosella, and Willem Brey | Brey Cycle Farm LLC | WI |
| 12469 | Brigeen Farms, Inc. | Brigeen Farms, Inc. | ME |
| 5579 | Jesse Lee Muse | Bringem Out Ayrshires | KY |
| 1086 | Delbert & Heather Yoder | Brook Hollow Farm | OH |
| 11123 | Colt & Luke Buckley | Buckmeadow Farms | KY |
| 11726 | Budjon Farms | Budjon Farms | WI |
| 12294 | Jim Butler | Butlerview | IL |
| 3079 | Dylan Reed | B-Willenborg Farms Inc. | IL |
| 10229 | Ava M Canary | Canary Dairy | NY |
| 11459 | Tyler Carter | Carters Corner | IL |
| 14009 | Ben & Liz Cashell, and Theo Goldenberg | Cashells | PA |
| 12139 | Phillip McCormick | Cherry-Lor | PA |
| 13483 | Bethany Eberlin | Cherry-Lor Holsteins | PA |
| 11022 | Clarkvalley | Clarkvalley Holsteins | ON |
| 13427 | Lane Wendorf | Crescentmead | WI |
| 10174 | Natalie A, Paige L, & Neil R. Haase | Dabru Dairy | SD |
| 12507 | Jason & Sheri Danhof | Danhof Holsteins | IA |
| 10960 | Brian & Becky Mcgee & Vickie Roudabush | Dayspring Holsteins | PA |
| 13678 | Hayley Sleik | Deerview Meadows Farm | WI |
| 1837 | Discovery Genetics | Discovery Genetics | WI |
| 12791 | Brooklyn, Bryce & Blakely Kohls | Do-N-Joy Genetics | MN |

List of Exhibitors - Red White

| ID | Name | Farm Name | State |
|-------|---|-----------------------------------|-------|
| 13902 | L Moser, J Eggink, M Gregory, M Upchurch | Dream Chaser Genetics | IL |
| 12207 | Coltan & Eastan Brown | East-Colt Dairy | WI |
| 10492 | Emily G Lampson | Egl-Acres | NY |
| 11064 | Emily Lampson and Dalton Cook | Egl-Acres | NY |
| 13772 | Ava Grace Hebgen and Avery Best | Ela May Genetics | WI |
| 14047 | Elmvue Farm | Elmvue Farm | NY |
| 6066 | Elizabeth Thyen | Empty-Pockets | MN |
| 1378 | Nevin F T Erbsen | Erbacres | IL |
| 12394 | Travis & Megan Schafer | Erbacres Holsteins | WI |
| 13748 | Caleb,Josiah,Helena,Adrian,Ella Olson | Excelerant Genetics | WI |
| 13924 | M,A & H Van Exel, J,R & R Zonnevelds, B & S Dongelmans | Exels Holsteins & Jerseys | CA |
| 13950 | Madison, Atlee & Henry Van Exel | Exels Holsteins & Jerseys | CA |
| 13660 | Jordyn Dingles | Faye Acres | MN |
| 10753 | Taylor Jerde | Faye Acres | MN |
| 10177 | Ferme Jacobs Inc. | Ferme Jacobs Inc. | QC |
| 13430 | Ferme Malic | Ferme Malic | QC |
| 1006 | Pierre Boulet | Ferme Pierre Boulet | QC |
| 12241 | Sophie J & Lexi Schaefer | First Glance | WI |
| 12536 | Andrew Stuewe | Flower-Brook Registered Holsteins | MN |
| 8054 | Isaac Folts | Folts Farms, LLC. | NY |
| 8616 | Emma, Sara, Wyatt & Claire Dorshorst | Forward Genetics | WI |
| 13576 | Katelyn Klipp | Four Streams | KS |
| 12359 | Sarah Hill | Four-Hills Farm | VT |
| 11309 | Robert Gallivan and Daryld Gahm | Generation Next Boarding | IA |
| 11957 | M, E, N, J & B Gilbertson | Gildale Holsteins | WI |
| 12937 | Glaustar | Glaustar Holsteins and Jerseys | QC |
| 14146 | J & B krogman, K Mauer and B Brasch | Hawkeye-Jk | IA |
| 14175 | Dakota Sawyer | Hazelbrush Farms | IA |
| 8236 | Cael Hembury | Heart & Soul Holsteins | PA |
| 7159 | Douglas R. Boop | Heart & Soul Holsteins | PA |
| 939 | Heatherstone Enterprises, Inc. | Heatherstone Enterprises, Inc. | WI |
| 13686 | L,e,a,e,r&l Coon | Hill-N-Hollow Farm, LLC | NY |
| 13992 | Bentley, Blake, Brodie & Kylie Brantmeier | Hilrose Dairy, LLC | WI |
| 11230 | Jeff Brantmeier | Hilrose Holsteins | WI |
| 13619 | Jessica & Cassey Hensch | Hinsch's Holstein's | MN |
| 11547 | Peyton B, Elena E & Bria Olbrich | Holbric Holsteins | IL |
| 13320 | Brayden Carpio | Horizon-Vue Dairy | CO |
| 7442 | Matt Hawbaker | Interstate Heifer Care | MD |
| 8964 | Delaney,Kalli & Cooper Barber & Sophie Leach | Irish Hill | IA |
| 13316 | Dakota Brown and Ellie Larson | Jadeview Genetics LLC | WI |
| 13949 | Kailey M Guilette & Whitney Handschke | Jauquet Holsteins | WI |
| 6884 | Emily Goode | J-G Springs Dairy | KY |
| 5395 | Jamie Judd and Mike Deaver | Juddale Holsteins | WI |
| 12627 | Reggie & Krysty Kamps | Kamps Rx Genetics | WI |
| 1609 | Ryan Griffin | Kara-Kesh Holsteins | MN |

List of Exhibitors - Red White

| ID | Name | Farm Name | State |
|-------|---|------------------------------------|-------|
| 13476 | Karnview Farms | Karnview Farms | ON |
| 12178 | Carter Kruse | Kcck Genetics | IA |
| 14203 | Keaton Phoenix and Stanhow Holsteins | Keaton Phoenix & Stanhow Holsteins | ON |
| 13758 | Bradley Kerndt | Kerndt Farms | IA |
| 11499 | Brea, Ava & Bryson Kieffer | Kiefland Holsteins | MN |
| 11502 | Brea, Ava & Bryson Kieffer | Kiefland Holsteins | MN |
| 10423 | Hannah King | Kings-Ransom Farm | NY |
| 13707 | Johnathan King & Emily Mikel | Kings-Ransom Farm | NY |
| 10333 | Kings-Ransom Farm | Kings-Ransom Farm | NY |
| 7485 | Victoria Clark | Kozy Kountry Farm | PA |
| 11462 | Owen & Kendyll Kress | Kress-Hill Dairy LLC | WI |
| 14066 | Carley Krull | Krull Farms | WI |
| 13723 | Emmett Vannoy, Tre Wright, Charlie Elmore | Ky Bluegrassgenetics | KY |
| 12147 | Vanessa Philson | Lady Luck Holsteins | OH |
| 8162 | Kirt Menzi Jr. | Lantland Farm | NY |
| 8163 | Jacob Menzi | Lantland Farms | NY |
| 14196 | Emma England | Lasue Farms | ID |
| 12138 | Lauren D L'amoreaux | Laurind Swiss | OH |
| 1768 | Michael Maier | Lazy M Farm | WI |
| 14044 | Anthony and Kennedy Liddle | Liddleholme Holsteins | NY |
| 12063 | London Dairy Farms | London Dairy Farm | ON |
| 10816 | Jordan A. London | Londondale | PA |
| 2824 | Lonely-Mile Holsteins | Lonely-Mile Holsteins | WI |
| 12598 | Lookwell Farm and Oneeda Farm | Lookwell Farm | IN |
| 14232 | Luncrest Farm and Matthew Kuperus | Luncrest Farm | NY |
| 1218 | Doug & Lynnette Lyons Family | Lyons Holsteins | IA |
| 4240 | Scott Culbertson and James McFarland | Macland | MN |
| 6642 | Scott Culbertson and T&L Cattle Company | Macland | MN |
| 12262 | Maple Downs Farms II | Maple-Downs Farm | NY |
| 13417 | Robin Krohlow | Maple-Home Boarding | WI |
| 13561 | Markhill Farms Ltd | Markhill Farms Ltd | ON |
| 12706 | Lily Marshman | Marshman Farms LLC | NY |
| 11908 | N, B & J Mauk | Mauk-E-Way Farm | WI |
| 13742 | Mcnally Farms | Mcnally Farms | WI |
| 12894 | Genetic Link | Mcwilliams | PA |
| 9862 | Sam Mcwilliams | Mcwilliams Farm | PA |
| 254 | Chris & Jennifer Hill | MD-Hillbrook | MD |
| 14262 | Chris and Jen Hill & Blake And Billie Jo Rhodes | Md-Hillbrook | MD |
| 11221 | Megan Moede | Mead-Manor | WI |
| 13493 | Megan Moede & Logan Guillette | Mead-Manor | WI |
| 13392 | Cooper Merrill | Merrillea Holsteins | NY |
| 8326 | Merrillea Holsteins | Merrillea Holsteins | NY |
| 13945 | Miley Holstein Farms | Miley Holstein Farms | OH |
| 10222 | Milk Source Genetics | Milk Source | WI |
| 11130 | Milk Source, Fischer, Steincrest & Crescentmead | Milk Source | WI |
| 10226 | Milk Source, Ransom-Rail and Fischer | Milk Source | WI |

List of Exhibitors - Red White

| ID | Name | Farm Name | State |
|-------|---|---|-------|
| 10216 | Tristen Hans Ostrom | Milk Source | WI |
| 2997 | Justine Kelsey | Monanfran Farms | NY |
| 13068 | Bridgerland Holsteins & Delon Mortimer | Mortimer Jerseys and Bridgerland Holsteins | UT |
| 12691 | John & Connor Erbsen | Ms D Angel Devika-Red-Et | IL |
| 13480 | Rick Kaut | Mt View Meadows | WA |
| 14169 | Emma Mulhern | Mulhern Dairy | MN |
| 11257 | Oliver, Owen & Addison Nisen | Nise-N-Fancy | IN |
| 12869 | Wyatt Chambers | North Side Farm | VT |
| 13920 | Chase & Alexis Cashell and Evan Castrogiovanni | Oakfield Corners Dairy | NY |
| 13915 | Chase & Alexis Cashell and Oakfield Corners Dairy | Oakfield Corners Dairy | NY |
| 11154 | Chloe & Claire Lamb | Oakfield Corners Dairy | NY |
| 11153 | Jonathan & Alicia Lamb | Oakfield Corners Dairy | NY |
| 11156 | Oakfield Corners Dairy | Oakfield Corners Dairy | NY |
| 12878 | Mallory R Nifong and Jemma Jean Obert | Obee-Jay Holsteins | WI |
| 258 | Ourway Cattle Co | Ourway Cattle Co | WI |
| 12129 | Justin M. Wolfe | Ovaltop Holsteins | NY |
| 9120 | Makayla & Kaleb Osinga | Overside | TX |
| 11647 | Kaleb Osinga & Henry Osinga | Overside Farms | TX |
| 13614 | Katie Osinga | Overside Holsteins | TX |
| 1713 | Suton Paulson | Paule-View | IL |
| 8062 | Brooke Carey | Plum-Line Holsteins | PA |
| 14074 | Christie Prins Flood | Pryme Farms Inc. | ON |
| 10512 | Ian & Derek Schwartzlow | Quad-R Holsteins | WI |
| 8119 | Lilly Elsass | Quietcove Holsteins | OH |
| 13558 | Quietcove, Silver-Mist, T Cummings & C Mccumons | Quietcove Holsteins | OH |
| 12327 | R&F Livestock Inc. | R&F Livestock Inc | SK |
| 12570 | Elizabeth Kiko | R&P Kiko Farms | OH |
| 14199 | Rowan Kiser | Radley Bend Farm | MD |
| 12932 | Rainbow Dairy LLC | Rainbow Dairy LLC | WI |
| 328 | Ron & Christy Ratliff | Ratliff Farms | KS |
| 9291 | Reyncrest Farm | Reyncrest Farm | NY |
| 10136 | Taylor & Kelsey Riedel | Riedel-Ridge | WI |
| 12977 | Haylee and Grant Yager | Road-View Dairy Holsteins | WI |
| 14124 | Haylee Yager | Road-View Dairy Holsteins | WI |
| 13021 | Robella & T&I | Robella | SK |
| 10744 | Mercedes & Jade Kroll and Alexys Gaedtke | Rolling Hills Dairy Farm LLC | WI |
| 13757 | Kamrie Mauer | Rollingriver | MN |
| 14198 | James R. Putman | Roput Farm | NY |
| 11539 | Royal Vista Holsteins | Royal Vista Holsteins | WI |
| 11672 | Stephen & Patrick Maddox | Ruann Genetics | CA |
| 13749 | Sarah Fitzgerald | Sarah Fitzgerald | IL |
| 12273 | Yvonne E Preder and Rodney Bohnhoff | Scenic-Edge | WI |
| 13262 | Yvonne Preder | Scenic-Edge Holsteins | WI |
| 4817 | Kurt Wolf | Shadow-W Holsteins | OH |
| 12320 | Logan & Lauren Silveira | Silveira Dairy | CA |

List of Exhibitors - Red White

| ID | Name | Farm Name | State |
|-------|--|--|-------|
| 12314 | Royal-Cut Genetics | Silveira Dairy | CA |
| 4285 | Ryan Sonnenburg | Sonnenbrook Holsteins | WI |
| 10967 | Weston Taylor | South Creek Acres | PA |
| 1313 | Dale & Deanna Bendig | Spungold | PA |
| 10998 | Courtney & Duncan Bailey | Stone Oak Genetics | NY |
| 12538 | Andy Stuewe and Corey Feltmann | Stu-Felt Holsteins | MN |
| 13840 | Jacalyn & Brooke Bortner | Sunnybend Farm | PA |
| 13836 | Jacalyn Bortner | Sunnybend Farm | PA |
| 914 | Wayne Debuhr | Sunny-Valley Holsteins | WI |
| 13948 | Gary Breitlow | Synergy Dairy LLC | WI |
| 1247 | Synergy Dairy LLC | Synergy Dairy LLC | WI |
| 3705 | Emily Thorgerson | Thorgy-Way | WI |
| 13951 | Grace Johnsrud | Tree-Hayven Holsteins | WI |
| 1307 | Triple-T Holsteins | Triple-T Holsteins | OH |
| 737 | James & Janelle Hoffman | Tumbling Run Holsteins and Heatherstone Enterprises Inc | PA |
| 10489 | Thomas & Erin Uber | Ubercrest | PA |
| 1096 | Karsen Haag | Virhada Holstein | WI |
| 13706 | Wadeland-Jh | Wadeland Dairy LLC | IA |
| 14011 | Abby Fairbanks | Wapsi-Ana | IA |
| 14089 | Hayden Weaver | Weaver Show Cattle | PA |
| 6721 | Westcoast Holsteins | Westcoast Holsteins | BC |
| 11524 | Derek, Landon & Lane Vandyk | Westcroix | WI |
| 14164 | Frank Behling | Wildweed Holsteins and Jerseys | WI |
| 13640 | Randy, Wesley & Matthew Winch | Winch's Pine Grove Farms | WI |
| 9294 | Brian Joseph Enright | Winright Holsteins | ON |
| 1136 | World Classic Sale | World Classic | WI |
| 11203 | Rosalee Zehr | Zehrview Inc | IL |
| 11204 | Wyatt Zehr | Zehrview Inc | IL |
| 14076 | Ben Zeller | Zell-Mill-Acres | PA |
| 5417 | Mason Ziemba | Ziembarbway | NY |
| 14211 | Ackley, Plainfield, Biershank | | OH |
| 14048 | Audrey Sidle | | OH |
| 11345 | Austin Trbovich | | OH |
| 12580 | B & C Rupprecht and Cassandra Gebert | | IN |
| 12826 | Benjamin & Jennifer Wallace and Steve Mcdonald | | WI |
| 12941 | Brady & Bentley Cole | | OH |
| 13548 | Brian Coyne and Patrick Crave | | WI |
| 12868 | Bruce R Gingerich | | IN |
| 13966 | C, K, & G Grinstead G & J Boyke | | WI |
| 14068 | Caden Finley & J Dowswell Farms Ltd. | | ON |
| 11530 | Cale Baker and Regan Pries | | IA |
| 13357 | Chloe Lacrosse | | WI |
| 10644 | Dana & Madison Sickles | | IA |
| 12554 | Dana Johnson | | WI |
| 12159 | Danielle Haley Miller | | OH |

List of Exhibitors - Red White

| ID | Name | Farm Name | State |
|-------|---|-----------|-------|
| 4920 | Doeberiner, Bowen and Schilling | | OH |
| 13750 | Doeberiner, Bowen, Conroy and Cannon | | OH |
| 12653 | Duckett Holsteins, H & C Van Exel and Airosa Dairy | | WI |
| 13831 | Elizabeth Sutton | | FL |
| 10959 | Eoghan Daniel McGarr | | NY |
| 11306 | Eric Enright | | WI |
| 13724 | Extramile Farm | | ON |
| 7352 | Glamourview-lager & Walton and Eaton Holsteins | | NY |
| 11089 | Golden Oaks Farm | | IL |
| 13361 | Hailey Abraham | | IL |
| 13762 | J D Brown II | | VA |
| 11302 | Jazmyn & Chase Heeg | | WI |
| 13469 | Johnathan Heinsohn and Timothy Ziemba | | WI |
| 14060 | Johnathan Heinsohn, Matt and Molly Sloan | | WI |
| 12581 | Jordan Kuhn | | IN |
| 12352 | Juniper Farm | | ME |
| 2847 | Justin Powell | | IL |
| 11918 | Kamryn Kasbergen | | CA |
| 13533 | Karnview Farms, Anthony Peatling | | ON |
| 8905 | Kenlee Philips | | TX |
| 13471 | Kyra and Kenzie Danz | | WI |
| 14213 | Lindsey Borst, Nathan Donnay, Mike Donnelly | | MN |
| 13975 | Luke Alsleben and Tony Kohls | | MN |
| 13131 | Lynette J. Gelsinger | | PA |
| 13466 | M & E Gunst, and L, H & B Smith | | WI |
| 14069 | Madison Fisher & Triple-T Holsteins | | MD |
| 12551 | Makenzie & Callen Ferris | | OR |
| 13468 | Matthew and Elizabeth Gunst | | WI |
| 13470 | Matthew and Elizabeth Gunst And Evan Hathaway | | WI |
| 13537 | Mckenzie & Briar Carpenter | | VT |
| 13473 | Mya Digangi | | WI |
| 10347 | Nicole Broege | | WI |
| 11040 | Nikole Steffenhagen | | WI |
| 13424 | Rachel Van Buren | | NY |
| 14184 | Richard Breunig, Robin Krohlow & Cupid Cattle Company | | WI |
| 5812 | Robert & Kate Teixeira | | CA |
| 13821 | Ryan, Doeberiner, Bowen, Feldman, Cupid Cattle Company | | WI |
| 13583 | Showbox Sires and Alh Genetics | | WI |
| 12829 | Tanner Rohner | | MN |
| 13879 | William H Schilling | | MI |
| 8880 | William Taylor and Beth Roberts | | NJ |
| 13472 | Zachary, Collin J, and Maddy Costello | | WI |

SEPARATING THE INNOVATORS FROM THE IMITATORS.

**BOVALTA™ BMR IS THE NEWEST ADDITION TO A
PROVEN LINE OF HIGH-PERFORMANCE SILAGE.**

THE GOLD STANDARD IN SILAGE JUST GOT BETTER.



NEW! BREVANT® BRAND BOVALTA™ BMR PRODUCTS.

Taking BMR to new levels of digestibility, tonnage, starch and agronomics.

Bovalta™
BMR



BREVANT BRAND UNIFIED™ PRODUCTS.

Proven increased starch digestibility to reduce ensiling times and increase feed efficiency.

unified™
CORN SILAGE with SilaSoft™
TECHNOLOGY



BREVANT BRAND FORAGE QUALITY (FQ) PRODUCTS.

New silage offering brings confidence and flexibility for silage or grain. Superior silage tonnage and quality characteristics in top-grain-producing hybrids. FQ products meet the same standards and level of quality as traditional Brevant brand TMF products.

FQ



BREVANT BRAND TMF PRODUCTS.

Built to maximize performance on a silage specific acre. Combines industry leading tonnage and agronomic strengths with high fiber and starch digestibility.

**STOP BY THE BREVANT® SEEDS BOOTH (598,599,638,639) TO LEARN
MORE ABOUT OUR FULL LINEUP OF SILAGE PRODUCTS.**

DEFINED BY

YOU



A true partner is defined by those they support. That's why at Compeer Financial we're defined by you — your hopes for the future as well as what you need today. As a member-owned cooperative, our clients help shape the direction we go and how we serve them. And as agriculture continues to evolve, so will we, together. So whether you need an experienced lender, a trusted advisor or a friend you can count on, we're ready.

DEFINE YOUR SUCCESS WITH US AT [COMPEER.COM/YOU](https://www.compeer.com/you) OR CALL (844) 426-6733

Dairy Processing | Cold Storage | Loans & Leases | Business Services | And More

Compeer Financial can provide assistance with finances based on historical data and industry expertise. Compeer does not provide legal, tax or investment advice. Compeer Financial, ACA is an Equal Credit Opportunity Lender and Equal Opportunity Provider and Employer. © 2023 All rights reserved. NMLS #619731



SHOW YOUR COWS THAT YOU CARE



Our Barn-Grooving Solutions Keep Your Cows in Good Standing

Slippery barn floors are a common cause of injuries to cows, and can create big problems for dairy farmers. You can avoid this problem by grooving their floors to create traction. SMITH's FS351 DCS self-propelled heavy-duty scarifier is the perfect tool for creating these grooves.

It is capable of removing a path up to 16 inches wide, and can be equipped with a wide variety of cutters to create nearly any groove pattern or surface profile. The FS351 DCS also features SMITH's exclusive electronic DCS Depth Control System, which allows users to precisely adjust the cutter depth without stopping production.

- *Self-propelled with easy speed adjustment*
- *Side plate for faster drum changes*
- *Vacuum ports for dust collection*
- *Available in gasoline, electric, and propane-powered versions*

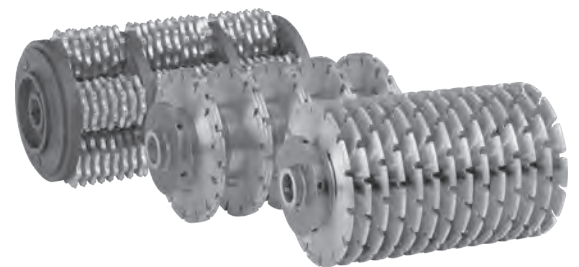
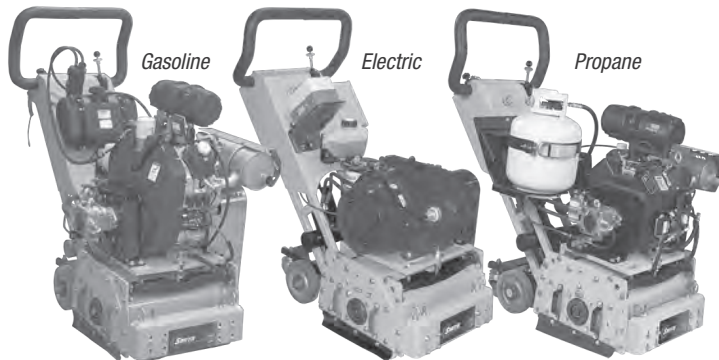
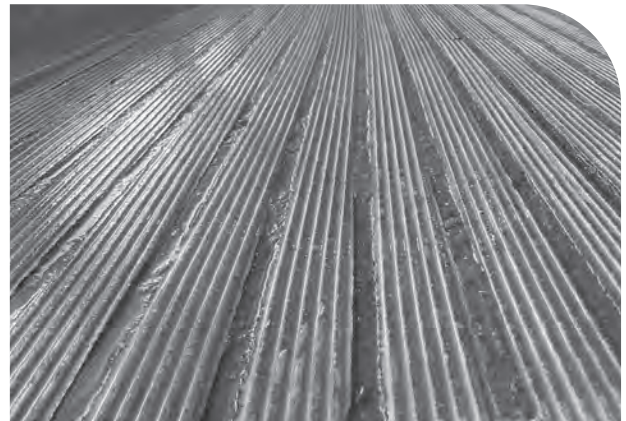

CONTACT US ABOUT OUR BARN-GROOVING SOLUTIONS TODAY!



**See us at World Dairy Expo booth TC 603/604
or visit us online at www.smithmfg.com**

**HEALTHY ANIMALS.
HEALTHY FOOD.
HEALTHY WORLD.®**



We know a healthy herd is a productive one. Our comprehensive portfolio of dairy offerings includes proven and effective solutions that help you address important challenges and optimize the opportunity to support the health and productivity of your cows.

Stop By and Visit With Us At
#EH4516 & #TM FF

Phibro
ANIMAL HEALTH CORPORATION **TM**

AB20

Animate

cellerate
YEAST SOLUTIONS®

OmniGen

Hy•D



BouMatic 

For the life of your dairy™

SHIELD HER FROM THE COLD

BouMatic's Arctic Shield +Plus is a premium three-way protection skin conditioning package in a post dip that helps prevent frostbite. The high level of conditioning helps shield teat skin against cracking and chapping in cold harsh conditions while providing germicidal protection to help prevent mastitis.

Protect and insulate your herd when the temperature dramatically drops. Maintains its effectiveness even in subzero °F conditions.

Effective but gentle, Arctic Shield +Plus is necessary for the upcoming cold weather season.

Learn more at BouMatic.com/ArcticShield



CUT. RAKE. BALE. REPEAT.™



From first cut to last bale, New Holland hay and forage equipment helps you make top-quality hay and make it more productively — day in and day out. That's the advantage of our over 125 years of invention and innovation. New Holland haytools save you time and money, all while maximizing quality and feed value. You'll also work more confidently, knowing your local New Holland dealer is there with unparalleled service and support when it matters most. Cut, rake, bale, repeat — no one does hay better.

Stop by Trade Mall C to learn how New Holland equipment can help your dairy operation. Or, visit newholland.com





REGISTER TODAY



to receive critical business information to help you thrive in a constantly changing economic environment.

milkbusinessconference.com

Agenda topics include:

- How to Find, Retain and Develop the Best Farm Employees
- The Biggest Challenges Ahead for Animal Agriculture
- From Good to Great — Producers Share Their Recipe for Success
- How Can Beef on Dairy Make You Even More Money

PLUS: Jeff Civilico, Las Vegas Headline, Host Personality, Philanthropist, will speak on “Work That Matters”



COMMITTED TO
WORLD DAIRY EXPO
COMMITTED TO
SILAGE

**VISIT US IN THE TRADE CENTER TO LEARN MORE ABOUT OUR WORLD
CLASS SILAGE HYBRIDS.**



MASTERSCHOICE
SEEDCORN.COM

your **CALVES** *deserve*
the **BEST COLOSTRUM**



Not all colostrum management systems are created equally. Golden Calf Company's Calf Hero™ colostrum pasteurizers and bags are field-tested to withstand the daily use of the largest dairies in America and our snap-in single-use tube feeder revolutionizes the hygiene of colostrum feeding. The benefits our customers praise most often are healthy calves and consistency of protocols. We are proud that all of our products are both designed and manufactured in the heart of America's dairyland.

Calf Hero™ colostrum bags are fully compatible with other systems in the market. Give us a call at 715.318.0897 or stop by our booth to get a competitive quote.

bigger than ever

GOLDEN CALF COMPANY
booth EH 3016 - 3318

www.GoldenCalfCompany.com 715.318.0897

-Notes-

REDPINK VRC

MAIN CONCOURSE,
 BOOTH MC67



REDPINK VRC

SABBIONA REDPINK VRC CF TY TV TL R
 IT098990870073 - 198HO02315
 CHAMPION RED X RIVETING X IMAX

ONE OF THE BEST RED VARIANT SIRES IN THE WORLD

- ✓ BULL WITH THE VRC (DOMINANT RED) GENE: 50% OF OFFSPRING WILL BE BORN RED, REGARDLESS OF MATERNAL LINE.
- ✓ HE COMES FROM AN EXCEPTIONAL SABBIONA HOLSTEIN COW FAMILY: HIS DAM IS VG89 AND HIS GRANDDAM EX93.
- ✓ NICE COMBINATION OF LOW SOMATIC CELL COUNT AND POSITIVE MILKING SPEED.
- ✓ HIGH PRODUCTION INDEX, GOOD TYPE AND OUTSTANDING UDDERS.
- ✓ EASY CALVING

| | | | |
|-----------|-------|---------------|-------|
| GPFT | +4525 | REAR LEG SET | -0.12 |
| MILK | +1557 | SCS | 114 |
| PROTEIN | 56 Kg | LONGEVITY | 118 |
| PROTEIN % | +0.04 | HEAT TOL. | 104 |
| FAT | 61 Kg | MILKING SPEED | 105 |
| FAT % | +0.03 | GTPI* | +2757 |

ANAFI 08/2023

*CDCB 08/2023

At your side since 1974.

Intermizoo[®]

MOTHERS *Matter*

Maternal lines have always been critically important when sourcing the right sires for our Showcase listing. History has shown that maternal lines anchor the success of Showcase sires. These influential mothers are the backbone of our lineup and should be credited for the massive success that their lineage achieves in the showing and beyond.



 **SHOWCASE™**

L-R: S-S-I Doc Have Not 8784-ET (EX-96-EX-MS),
Townlineacre King Doc Lena (EX-92-EX-MS),
Siemers Lstr Hanan 33317-ET (VG-89-EX-MS)

S-S-I Doc Have Not 8784-ET (EX-96-EX-MS)

Have Not is making history not only for her record-breaking sale price, but because of her ability to create progeny that will influence the breed for decades. She is the dam of 7H016791 HOMER and 7H016295 HAS IT ALL.

Townlineacre King Doc Lena (EX-92-EX-MS)

Lena is a newcomer to the exclusive club of influential mothers. Tracing through the Goldwyn Locket branch of the Roxy maternal line, she already has two sons available: 7H016491 LEGENDAIRY and 250H016490 LOMBARDI.

Siemers Lstr Hanan 33317-ET (VG-89-EX-MS)

The Hanker branch of the Dellia family has been a highlight of Showcase for several years, but 33317 levels up by adding traits like red factor and polled. Her sons 250H016498 HULU and 7H016493 HAKAN-P are carriers for these highly sought-after traits.



YOUR SUCCESS *Our Passion.*

(614) 873-4683 ♦ www.selectsires.com