

56<sup>th</sup> World Dairy Expo / Madison, WI, USA

# BROWN SWISS CATTLE LOG



**Cutting Edge Thunder Faye**

*2022 International Brown Swiss Show Grand Champion*

**OCTOBER 3 - 4, 2023**

Dairy Cattle Show & Sales

| Trade Show

| Education

| Networking

| Youth Contests

# TAKE THE MOMENT HOME

*FROM THE COLORED SHAVINGS TO EDUCATION*



photo credit: Cowsmo.

**THE**  
**DAIRY**  
**SHOW**



The Dairy Show, Expo's podcast, connects listeners to dairy producers and industry experts from around the globe to talk cows, cutting edge technology and the colored shavings. New episodes are available on the 2<sup>nd</sup> and 4<sup>th</sup> Tuesday of each month. Find The Dairy Show on Spotify, Apple Podcasts, Google Podcasts or at [www.worlddairyexpo.com](http://www.worlddairyexpo.com).

Relive every moment of Showring action all year with ExpoTV.

Available at [www.worlddairyexpo.com](http://www.worlddairyexpo.com), ExpoTV captures highlights of each breed show class and complete livestreams of all six days of competition. Also available are recordings of Expo Seminars, Virtual Farm Tours, Dairy Forage Seminars and Expo en Español.



**WORLD DAIRY EXPO® | OCT. 1-6, 2023 | MADISON, WI, USA** |       



# International Brown Swiss Show

3:00 p.m. Tuesday, October 3 (Heifers)

7:00 a.m. Wednesday, October 4 (Cows and Groups)

## Dairy Cattle Exhibitor Committee

### Chair

Tom Morris, Amery, WI

### Vice-Chair

Bryan Voegeli, Monticello, WI

### Overall Dairy Cattle Show Superintendent

Dave Bollig, Belleville, WI

### Assistant Overall Dairy Cattle

### Superintendent

Jon Rasmussen, Fond du Lac, WI

### Ethics Coordinator

David Jeans, DVM, Evansville, WI

Katie Agnew, Oconomowoc, WI

Lucas Clanton, Mulberry Grove, IL

Evan Creek, Hagerstown, MD

Ted deMent, Kenney, IL

Brian Dinderman, Orangeville, IL

Erica Enright, Winchester, ON

Tom Foss, Cambridge, MN

Corey Geiger, Beaver Dam, WI

Lynn Harbaugh, Marion, WI

Emily Hartmann, Mulberry Grove, IL

Matt Hawbaker, Clear Spring, MD

Matt Henkes, Luana, IA

Jennifer Hill, Thurmont, MD

Christopher Lang, Big Prairie, OH

Steve Maddox, Riverdale, CA

Sheila McGuirk, DVM, Dodgeville, WI

Donna Mertz, DVM, Blair, NE

Terri Packard, Boonsboro, MD

Joe Rocha, Tillamook, OR

Chad Ryan, Fond du Lac, WI

Dusty Schirm, Ashville, OH

Kevin Stoltzfus, East Earl, PA

Eric Topp, Wapakoneta, OH

Roger Turner, Watertown, WI

Mark Valentine, Thurmont, MD

Bonnie Van Dyk, New Richmond, WI

Andrew Vander Meulen, Brighton, ON

Sarah Wendorf, Ixonia, WI

TJ Wingert, Kent, IL

## World Dairy Expo Board of Directors

### President

\*\*Bill Hageman, At-Large Representative

### Vice-President

\*\*Tom Morris, WDE Dairy Cattle Exhibitor Committee Chair

### Secretary/Treasurer

\*\*Bob Hagenow, At-Large Representative

Bill Barlass, Director Emeritus

\*\*Dave Bollig, Overall Dairy Cattle Show Superintendent

Scott Culbertson, Purebred Breeders of World Dairy Expo

Jason Danhof, Purebred Breeders of World Dairy Expo

Alan Deming, Director Emeritus

Kami Dorn, Wisconsin Guernsey Breeders Association

Glen Easter, Dairy Farmers of America

Dr. Paul Fricke, UW-Madison CALS

Corey Geiger, Holstein Association USA, Inc.

Calvin Graber, Associated Milk Producers, Inc.

Keith Heikes, URUS

Dean Hermsdorf, ABS Global, Inc.

\*\*Laura Herschleb, World Dairy Expo General Manager

\*\*Josh Hushon, At-Large Representative

\*\*Kevin Jorgensen, Select Sires, Inc.

Ernie Kueffner, At-Large Representative

Dave Kyle, Foremost Farms USA

\*\*Joan Lau, At-Large Representative

Jeff Lyon, At-Large Representative

Annie McCullough, Farm Journal Media, Official Program Publisher

Jennifer Meyer, Purebred Breeders of World Dairy Expo

Joseph Opsal, Dane County Holstein Breeders

Randy Romanski, Wisconsin Department of Agriculture,

Trade & Consumer Protection

Chad Ryan, Purebred Breeders of World Dairy Expo

Jeannette Sheehan, Purebred Breeders of World Dairy Expo

Jim Sipiorski, CentralStar Cooperative, Inc.

Brooke Trustem, BouMatic

\*\*Bryan Voegeli, Purebred Breeders of World Dairy Expo

Ryan Weigel, Wisconsin Holstein Association

\*\*Doug Williams, WDE Commercial Exhibitor Committee Chair

Emily Yeiser Stepp, National Milk Producers Federation

**\*\*Denotes Member of Executive Committee**

## Dynasty in Dairy



2023

Official Judge  
Chris Lahmers  
Marysville, Ohio

Associate Judge  
Richard "RT" Thompson  
Darlington, Wisconsin

Superintendent  
Dave Bollig  
Belleville, Wisconsin

World Premier Brown Swiss  
Sale

Wednesday, October 4

Social: 2:00 p.m.

Sale: 3:00 p.m.

Sale Pavilion

# World Dairy Expo

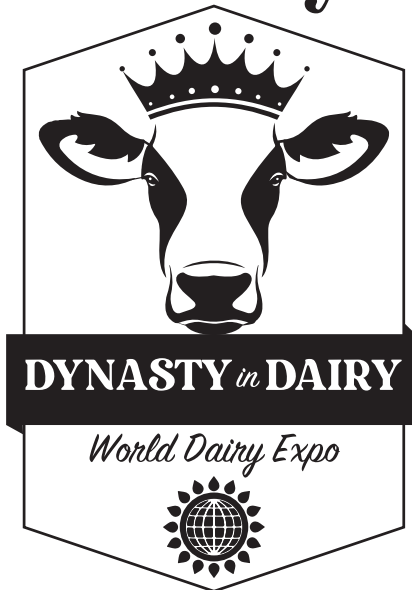

Please see the World Dairy Expo Premium Book for additional Dairy Cattle Show award sponsors.



## World Dairy Expo, Inc.

3310 Latham Drive

Madison, Wisconsin 53713 USA

Phone: 608-224-6455

[worlddairyexpo.com](http://worlddairyexpo.com) • [wde@wdexpo.com](mailto:wde@wdexpo.com)

[facebook.com/worlddairyexpo](https://facebook.com/worlddairyexpo) • [twitter.com/wdexpo](https://twitter.com/wdexpo)

[instagram.com/wdexpo](https://instagram.com/wdexpo) • [linkedin.com/company/world-dairy-expo/](https://linkedin.com/company/world-dairy-expo/)

[spotify: spoti.fi/2XxFtdx](https://spotify.com/spoti.fi/2XxFtdx) • [youtube.com/worlddairyexpo](https://youtube.com/worlddairyexpo)

ExpoFM: 95.7 FM

## Staff

Laura Herschleb, General Manager

Laurie Breuch, Dairy Systems Manager

Lexa Miller, Cattle Show & Contests Coordinator

Jenifer Dobbs, Sponsorship Manager

Lisa Behnke, Communications Manager

Jenna Langrehr, Communications Specialist

Brian Paul, Trade Show Manager

Dawn Dommissie, Administrative Services Manager

Cassi Miller, Attendee Programs Manager

Michele Elliott, Staff Accountant

Kim Erb, Purple Cow Gift Shop Manager

Joan Judd, Office Assistant

## A special "Thank You" to all Dairy Cattle Show sponsors including:

Supreme Champion:

The Gregory Blaska Memorial Trophy: World Dairy Expo

Supreme Champion Cash Award: BouMatic

Supreme Champion Royal Blanket: Agro, Inc.

Reserve Supreme Champion Cash Award: Trans Ova Genetics

Reserve Supreme Champion Royal Blanket: E-Zee Milking Equipment, LLC

Supreme Champion of the Heifer Show:

The W. Terry Howard Memorial Trophy: World Dairy Expo

Supreme Champion of the Heifer Show Cash Award:  
Trans Ova Genetics

Supreme Champion of the Heifer Show Royal Banner:  
Trans Ova Genetics

Reserve Supreme Champion of the Heifer Show Cash Award:  
Golden Calf Company

Reserve Supreme Champion of the Heifer Show Royal Banner:  
Golden Calf Company

Grand Champion Sashes: Dynasty Genetics

Grand Champion Cash Awards: Udder Comfort Inc.

Junior Champion Sashes: In memory of Verlo DeWall by the DeWall Family

Junior Champion Cash Awards: Cargill Animal Nutrition

Sunday Morning Coffee & Donuts: Hellenbrand Lasting Legacy Award

Morning Coffee Cart: ABS Global and St. Jacobs ABC

Dairy Cattle Exhibitor Appreciation Picnic: Destination Madison

Jim Crowley Jr. Overall Herdsmanship Award:  
Chairs provided by Select Sires, Inc.

Semen Tank provided by MVE Biological Solutions

Herdsmanship Award Jackets: Select Sires, Inc.

Milking Parlor Equipment & Supplies: BouMatic

Exhibitor Welcome Bags: Extrutech Plastics, Inc.

Dairy Cattle Exhibitor Hats: Kemin Animal Health

Cattle Check-In Apparel: Sheila McGuirk DVM & Terri Ollivett DVM

840 Tag Sponsor: Datamars Livestock-North America

ExpoTV Broadcast: Dairy Management Inc., Diamond V,  
Golden Calf Company, Semex/Boviteq, STgenetics and Zoetis

Barn Disinfectant: AgroChem USA, LLC

International Brown Swiss Show Parade of Champions

Swiss music is sponsored by:

Brown Swiss Cattle Breeders Association

A special "Thank You" to all Junior Dairy Cattle Show sponsors including:

Junior Show Gold Sponsors:



Junior Show General Sponsor: Wisconsin Jersey Breeders Association, Elmhurst Guernsey

Supreme Champion of the Junior Show Cash Award: BouMatic

Supreme Champion of the Junior Show Trailer Award:  
Frenchville Trailer Sales, LLC

Supreme Champion of the Junior Show Royal Blanket: Select Sires, Inc.

Reserve Supreme Champion of the Junior Show Cash Award:  
Udder Comfort Inc.

Reserve Supreme Champion of the Junior Show  
Royal Blanket: Ameriprint Apparel, LLC

Supreme Champion Heifer of the Junior Show  
Michael Hellenbrand Memorial Trophy:  
Michael Hellenbrand Memorial Fund

Supreme Champion Heifer of the Junior Show Cash Award:  
Golden Calf Company

Supreme Champion Heifer of the Junior Show Royal Banner:  
Scott & Nikki Culbertson

Reserve Supreme Champion Heifer of the Junior Show Cash Award:  
Golden Calf Company

Reserve Supreme Champion Heifer of the Junior Show Royal Banner:  
Ebert Enterprises LLC

Junior Show Grand Champion Sashes: New Holland

Junior Show Junior Champion Sashes: Duane T. Cole, DDS

Grand Champion of Junior Show Cash Awards: Udder Comfort Inc.

Junior Champion of the Junior Show Cash Awards:  
Misty Meadow Dairy

Junior Show Neck Ribbons & Medallions:  
Select Sires, Inc.

# EXPO YOUR WAY

Customize your Expo experience with the WDE mobile event app!

## CUSTOM SCHEDULE

View additional details and favorite events to create your custom schedule.

## CATTLE & EXHIBITOR SEARCH

Search for your favorite animals or exhibitors to find them in the New Holland Pavilions or Cattle Tent.

## DAIRY CATTLE SHOW RESULTS

Keep updated on the Dairy Cattle Show with real-time results on class winners and champions.

## RAILBIRD JUDGING CONTEST

Submit your top four backtag numbers in each Railbird class to see how your placings match up against the official judge!

## TRADE SHOW SEARCH & MAPS

Locate companies and products found in the Trade Show using the searchable list feature or with interactive maps.



Search "World Dairy Expo" in Google Play or the App Store to download or scan this QR code.



## WORLD DAIRY EXPO 2023 SHOWRING SPONSORS



# Accelerating

## THE MODERN HERD



The Accelerated Genetics lineup is for the modern dairy producer, offering progressive genetics to create **healthy, efficient** and **adaptable** cows that perform well in every environment.

14H07804 MYLES, 14H07714 HURRICANE and 14H07770 HELIX  
third lactation daughter group, Fertile Ridge Dairy LLC,  
Mount Horeb, WI. Photo by Jordan.



614.873.4683 | [www.accelgen.com](http://www.accelgen.com)

MYLES, HURRICANE and HELIX qualify for semen export to Canada.



# The Ritchie Ripple Effect

## Every Saved Drop Matters

The benefits of adding a Ritchie to your operation extend far beyond saving you time, money, and water. By choosing Ritchie, you'll conserve water, protect the land, and reduce energy to promote a healthier environment for generations to come. Learn how a more sustainable future starts with a drop of water at [ritchiefount.com/sustainability](http://ritchiefount.com/sustainability).

**Stop by Ritchie booth #1405-1407  
in the Exhibition Hall.**

***Ritchie***<sup>®</sup>  
***Fresh Water  
For Life***<sup>™</sup>

# YOU CAN EXPECT MORE FROM Y-TEX®.

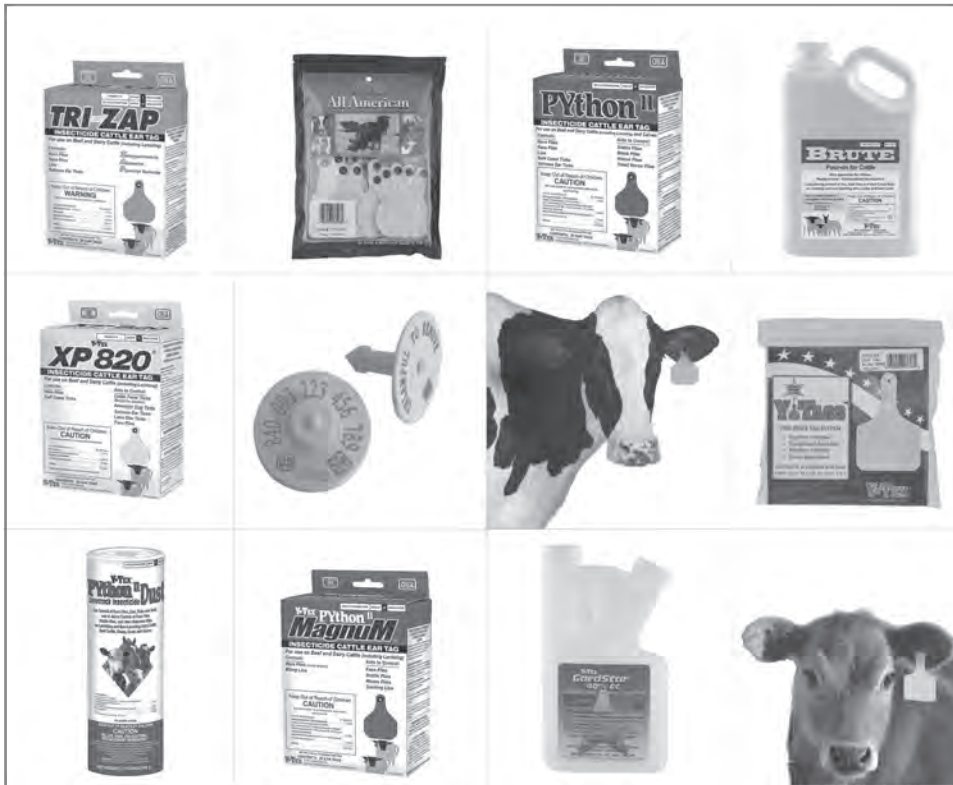

More in the way of the world's finest livestock identification and insecticide ear tags, including our advanced Y-Tags™ one-piece ID tags and TRI-ZAP™ insecticide tags. More livestock pest control options, like our BRUTE® Pour-On for Cattle, SwineGuard® Pour-On for Swine and GARDSTAR® Garden & Poultry Dust. And more quality equine products, like our popular TUTTLE'S® Liquid 747® feed supplement for horses.

## Y•TEX®

EXCELLENCE IN ANIMAL HEALTH™

To learn more about Y-TEX products and our outstanding customer service, visit [www.y-tex.com](http://www.y-tex.com) or call (888) 600-YTEX.

Y-TEX® is a registered trademark of Y-TEX Corporation. All brands pictured are either trademarks or registered trademarks of Y-TEX Corporation. © 2022 Y-TEX Corporation.

## EXPO YOUR WAY

Customize your Expo experience with the WDE mobile event app!

CUSTOM SCHEDULE

CATTLE & EXHIBITOR SEARCH

DAIRY CATTLE SHOW RESULTS

RAILBIRD JUDGING CONTEST

TRADE SHOW SEARCH & MAPS



Search "World Dairy Expo" in Google Play or the App Store to download or scan this QR code.

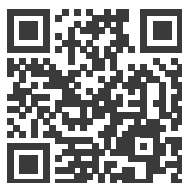

## Holstein International

1 YEAR = 26 MAGAZINES!



1 year: **US\$ 88** ~~US\$ 98~~ **-10%**  
 2 years: **US\$ 157** ~~US\$ 185~~ **-15%**



**Subscribe online**

AND USE DISCOUNT CODE: **HOL5WDE23**

[www.holsteininternational.com](http://www.holsteininternational.com)



**UDDER TECH**



Visit us in the  
**Exhibition Hall**  
Booth EH 4412

**NEW  
ITEMS!**

**VET JACKET**

**LONG SHOULDER  
GUARD**



**FREE LONG SLEEVE SHIRT  
WITH \$50 PURCHASE**

AT THE BOOTH AT WORLD DAIRY EXPO  
WHILE SUPPLIES LAST

[www.uddertechinc.com](http://www.uddertechinc.com)

Farmer Owned.  
Co-op Crafted.



When the dinner bell rings, enjoy a

# GRILLED CHEESE SANDWICH

made with AMPI's Dinner Bell  
Creamery butter and cheese.



Learn more about our products and  
the dairy farmers behind them at the  
AMPI booth, Exhibition Hall #4407.

Scan the QR code for the growing list of  
stores carrying Dinner Bell Creamery & learn  
how to help add your local stores to this list.

[www.dinnerbellcreamery.coop](http://www.dinnerbellcreamery.coop)



# PRO LAK<sup>®</sup> DAIRY

# LACTIVATE<sup>™</sup>

..... TARGETED DAIRY NUTRITION .....



[www.agpacknutrition.com](http://www.agpacknutrition.com)

# AND THEN THERE WAS ONE



A revolutionary leap in baler innovation with cutting-edge technology and advanced features. Capture real-time moisture and weight data which can be stored and analyzed through the John Deere Operations Center™, enabling you to make data-driven decisions and better manage your hay operation year after year. Whether you're working with dry hay or silage, the I Series Round Balers are designed to meet the demands of your operation.

**Experience the future of baling at the John Deere exhibit.**



**JOHN DEERE**

# Extrutech Plastics, Inc.

*Your One-Source Dairy Panel Supplier!!*

BOOTH  
EH 2814  
World Dairy  
Expo  
OCT 3-6  
Madison, WI



HOLY COW!  
Those panels  
are bright!

P224  
Partition  
Wall Panels  
24" Wide x 2-1/4" Thick

Available in  
12", 16" and 24"  
widths

ICC  
ES  
LISTED  
ESR 4583

Interlocking  
Liner Panels  
P1300  
P1600  
P2400

P624

EXTRUTECH FORM® System  
24" wide x 6" thick

EXTRUTECH FORM® System  
24" wide x 8" thick

ICC  
ES  
LISTED  
ESR 4250

P824

P1300

Panel colors: blue, yellow,  
red, green, white, gray,  
beige, and black

Custom sizes available

- Concrete Form System
- Water and corrosion-proof
- Panels will not rust, rot or flake
- Custom cut panel kits to 20 feet
- Cleans easily - low maintenance
- Brightens the interior of any building
- Fewer seams - 2 foot wide panels
- Resists mold, mildew, bacteria growth
- 6" and 8" thick stay-in-place concrete form
- Available in a bright white, high gloss, hard surface
- Low maintenance, easy-to-clean, with water/mild cleaner
- Protective film on both sides keeps panels clean during construction
- Wall and ceiling panels custom made to fit your building



Look for the EPI label on your panel orders. Made in the USA since 1992. That label assures you that, besides being all American made, our building products meet all code requirements and have been evaluated and approved by the International Code Council Evaluation Service (ICC-ES). Liner panels are CLASS-A for fire and smoke. We are committed to providing the best quality and safest building materials possible. ISO 9001:2015 QMS Certified. Panels and forms tested by Intertek testing for superior quality. Twenty year warranty on wall panels.



Visit our web site or give us a call to learn more about our many products shown here and how they will make your next project shine!

**1,000s of Happy Customers Nationwide!**

*Ask for Extrutech and Get the Best Surface, Shine, and Strength in the Industry!*



## Extrutech Plastics, Inc.

Phone: 888-818-0118

www.epiplastics.com E-mail: info@epiplastics.com





**Maximizing milk margins with a comprehensive approach**

**Exploring new feed technologies with proven results**

**Addressing profit leaks with on-farm consultation for optimized farm profitability**

# Solving your biggest challenges, together.

ADM is committed to helping dairy producers maximize milk margins through individualized, innovative nutritional programs specific to their farm. We take a comprehensive approach focusing on optimizing income over feed cost, and providing on-farm consultation to proactively address profit leaks. With advanced research and feed production facilities, ADM offers a comprehensive selection of ingredients, technologies, and services for every stage of the dairy herd.

**Visit us in the Exhibition Hall at World Dairy,  
Booth EH 1611-1712**

[adm.com/dairysolutions](http://adm.com/dairysolutions)



# STOP BY OUR BOOTH TO SEE THE PRODUCT SHOWN

## CUSTOMER SERVICE IS OUR GOAL

### **KLEEN FLO ECO-WAVE AUTOMATIC BULK TANK CONTROLLER**



The Eco-Wave Bulk Tank Controller is designed to cool and wash with a wide range for adjustable settings.

#### COOLING FEATURES

- Cooling cycles are adjustable
- Pre-cool option
- Agitator cycles are adjustable
- High temperature alarm

#### WASH FEATURES

- Up to six cycles can be programmed
- Unit can control all different types of drain systems (water pressure, electric, etc.)
- Up to three rinse cycles
- Wash cycles are adjustable
- Interface from 120/240 VAC to 24 VAC is available
- Screen shows cycle and time remaining in cycle
- Option to manually advance through program for ease of service
- LED lights indicate which outputs are active

*Partnering with you  
in the dairy industry.*



3772 East Newport Rd  
Gordonville, PA 17529

888.880.3993

877.204.7628

sales@ezmilking.com

www.EZMILKING.com

# CLIPPER PARTS & REPAIR

## IF IT CLIPS, WE CAN FIX IT!

AESCULAP



Authorized Aesculap  
Distributor & Service Center.

andis



Heiniger  
quality + swiss made



Yes we have  
**GROUND  
DOWN  
BLADES**

Oster



Visit us  
at Booth  
MC87

*Proud Sponsor of the  
Youth Fitting  
Contest*

 Find us on  
**Facebook**  
Clipper Parts & Repair

**TIM SOLLMAN • 897 1 3/8 STREET • CLAYTON, WI  
715-641-1057 • CLIPRFIX@AMERYTEL.NET • WWW.CLIPITALL.NET**



Quality agricultural supplies  
and milking equipment  
**SINCE 1925.**



Milking Equipment

Barn Equipment

Cleaning & Sanitizing

Calf Raising

Animal Health

Feeding & Watering

Animal Care

Fencing

Farm & Home

Visit us at **WORLD DAIRY EXPO**

Booths EH 2801-2905 • EH 2703, 2704 • TC 440, 441



Scan to learn  
more.



coburn.com



## Class 305 Spring Heifer Calf

Born 03/01/2023 - 05/31/2023

Premiums: \$100, 90, 80, 70, 60, 50, 40, 40, 35, 35, 30, 30, 25, 25, 20, 15, 10, 10

1st Place Award presented by Iroquois Acres, Bridport, VT

Bred &amp; Owned Award presented by Ohio Brown Swiss Association

Junior Premiums: \$25, 20, 15, 15, 10, 10, 10, 10

Junior Award presented by Armbruster Bros. Farms, Inc., Muscodora, WI

*2250 Little A Dynamite Brandy	05/02/2023		S-La Rainbow Bfly Dynamite-ETV D-Frozenes Kittens Joy	Wyatt Clason Albany WI
2251 High Creek Diego Nadia-ETV D-02-04 305 17,960 4.3% 775	04/24/2023	B&O	S-Hilltop Acres Dynamite Diego-ET D-WF Carter Nina-ET	James & Larry Sommers Arlington MN
2252 Miss Good Luck Beautiful	04/20/2023		S-Double W Goodluck D-Robland Goldfawn C Beauty	Knapp Genetics, Siegert Swiss, Keith Koopmann & Ken Borgmann Epworth IA
2253 Perry Brook Ratarok Tiana-ETV	04/11/2023	B&O	S-Rastaroket-ET D-Perry Brook Jon Tallulah-ETV	Kylie Chittenden Whiting VT
*2254 Jenlar Ascuba Wander-ETV 05-03 305 30,280 4.3% 1,304 3.3%P 1,000P 365 35,470 4.2% 1,507 3.4%P 1,189P	03/26/2023	B&O	S-Acclaimed D Scuba-ETV D-Top Acres Garbro S Wish-ET	Brianna, Austin, & Abby Meyer Chilton WI
2255 Rough Road Biniam Gemma	03/24/2023	B&O	S-Scherma Dreamer Biniam D-Rough Road Biver Haysha	Jeremy and Kelsey Kinslow Smiths Grove KY
*2256 Brook Hollow Pure Posh	03/18/2023	B&O	S-Voelkers TD Carter D-Brook Hollow B Posh Party	L: Carissa Pittman O: Delbert & Heather Yoder and Deb & Dan McKenzie West Salem OH
2257 Jenlar Calvin Wylee-ETV D-03-04 305 32,460 4.1% 1,340 3.4%P 1,095P 365 38,300 4.2% 1,607 3.4%P 1,290P	03/17/2023	B&O	S-Vetschs Nesta Calvin-ET D-Jenlar Carter Waltz-ETV	Brianna Meyer Chilton WI
*2258 KADR Glenwood Polly	03/16/2023	B&O	S-Kalingen Calvin Glenwood-ET D-North Lanes SP Phoenix	Kassidy, Ashlynn, Delaney & Ryleigh Olinger Hagerstown IN
*2259 Harvst Brz Els Windstorm	03/15/2023	B&O	S-Giacomini Elisium-ET D-Harvst Brz Carter Winkydink	Ellie Albert Vandalia IL
2260 Edge View R Waco-ETV	03/14/2023	B&O	S-Jo-Dee Royal Hill Rasta-ET D-Top Acres Peppy Wizella	Ken Main and Kenny Joe Manion Copake NY
*2261 Milnmorec Rampage Dimples D-01-10 301 22,381 4.3% 958 3.4%P 764P	03/13/2023		S-Kar-Linn Reeses Rampage D-Twinkle-Hill Dyn Dippy 1458	Amelia & Vienna Tauchen and Addison & Hailey Fischer Cecil WI
2262 Blessing Garbro Dar Phoebe-ETV D-03-09 305 28,150 4.7% 1,332 3.4%P 947P 365 31,970 4.6% 1,480 3.4%P 1,081P	03/11/2023	B&O	S-Hilltop Acres B Daredevil-ET D-Sun-Made Gb Plt Pretzel-ET	Blessing Farms and Garrison Bros. Fort Wayne IN
*2263 Brand D Remedy	03/10/2023		S-Hilltop Acres B Daredevil-ET D-Brand R Roxie	Dakota Voegeli-Paulson Arlington WI

*2264	Shadow Valley Foremost Sizzle	03/10/2023	B&O	S-Cutting Edge T Foremost D-Shadow Valley Aug Stephanie	Amelia Somers Walton NY
*2265	Jenlar Foremost Winnipeg-ETV D-03-04 305 32,460 4.1% 1,340 3.4%P 1,095P 365 38,300 4.2% 1,607 3.4%P 1,290P	03/08/2023	B&O	S-Cutting Edge T Foremost D-Jenlar Carter Waltz-ETV	Brianna, Austin, & Abby Meyer Chilton WI
*2266	Ruthless Skyhigh Ruthy	03/07/2023	B&O	S-La Rainbow Bfly Skyhigh-ET D-GMC Tray Ruth	Megan Hill Bristol VT
2267	M & M Cadence Shakira	03/06/2023	B&O	S-Shiloh Brookings Cadence-ET D-M & M Nemo Sophia	M & M Swiss-Jacob & Levi Stuessel Alma Center WI
*2268	Myline Drake Wonton	03/06/2023		S-Cutting Edge B Drake-ETV D-New View C Wildfire	Amy Hughes Durand IL
2269	Brook Hollow I Am Priority-ET	03/05/2023	B&O	S-Norwin D-Brook Hollow C Pristine	Delbert & Heather Yoder West Salem OH
*2270	Buckmeadow FC W Ivy	03/05/2023	B&O	S-Brown Heaven C First Choice-ET D-Edge View D Wrigley-ETV	C & L Buckley and M, J, S, L & M Saltzman Lawrenceburg KY
2271	Robland ACC To Breeze-ETV D-05-06 305 22,687 4.5% 1,021 3.2%P 724P 365 25,892 4.4% 1,154 3.2%P 843P	03/05/2023	B&O	S-Jennings Gap Time Out D-Robland Anibal Bailee-ET	Robert Landgraf Jackson MO
2272	Blue Diamond FM Smokeshow	03/04/2023	B&O	S-Cutting Edge T Foremost D-Jo-Dee R Smokin Sativa	John & Diane Sagaria, & Kenny Coppini Petaluma CA
*2273	Powerline Diego Sparkle-ETV	03/04/2023		S-Hilltop Acres Dynamite Diego-ET D-Cutting Edge CP Spirit	Paige, Josie, Jude & Camden Kinnard Sturgeon Bay WI
*2274	Red Brae Dreamer Nicolet D-03-04 305 21,038 4.8% 1,005 3.9%P 819P 365 24,438 4.8% 1,163 3.9%P 958P	03/04/2023	B&O	S-Jolahofs Superstar Dreamer-ET D-Cutting Edge F Nicki	Elise & Brady Bleck Muscodia WI
2275	Apex Carter Luxe	03/03/2023	B&O	S-Voelkers TD Carter D-Empire Winrite Lotus	Dylan Fry Chestertown MD
*2276	Beaumonde Timeless Fame	03/03/2023	B&O	S-Brown Heaven R Famous-ET D-Bagder Hollow Snapchat Tori	Adhyn Schell Lewiston MN
*2277	Birdsallway Famous Koolaid	03/03/2023	B&O	S-Brown Heaven R Famous-ET D-Birdsallway Carter Kream ETV	Paige, Josie, Jude & Camden Kinnard Sturgeon Bay WI
2278	Blessing Famous Jamie-Twin D-04-05 305 22,540 3.3% 733 3.4%P 771P 365 26,972 3.6% 968 3.4%P 929P	03/03/2023	B&O	S-Brown Heaven R Famous-ET D-Blessing Biver Jessie	Blessing Farms Fort Wayne IN
2279	Brown Heaven Norwin Fancy Body ET	03/03/2023	B&O	S-Norwin D-Brown Heaven J Fancy-ET	Brown Heaven Vercheres QC
2280	Cutting Edge Thunder Faye 2-ETN	03/03/2023		S-Cutting Edge Thunder D-Cutting Edge Elite Fayann	Ken Main and Kenny Joe Manion Copake NY
2281	Opsal-J Strike A Pose	03/03/2023	B&O	S-Brown Heaven C First Choice-ET D-Opsal-J C Picture Perfect	Joseph Opsal Blue Mounds WI



2282 Top Acres C Wizzie Shine-ETV D-07-05	305 29,960 4.9% 1,482 3.6%P 1,066P 365 35,404 4.9% 1,737 3.5%P 1,246P	03/03/2023	S-Voelkers TD Carter D-Top Acres Supreme Wizard ET	Brothers Three and Shawn & Seth Nehls North Prairie WI
2283 Logan Valley DD Sterling-ET		03/02/2023 B&O	S-Hilltop Acres B Daredevil-ET D-Logan Valley Flashing Star	Aaron Johnson Ettrick WI
*2284 Northkill Creek Grand Slam-Twin D-05-01	305 24,422 4.3% 1,060 3.1%P 767P	03/02/2023 B&O	S-HF Design-ET D-Northkill Creek Ghost	Hannah Balthaser Bernville PA
2285 Spots Pride Fore Play		03/02/2023 B&O	S-Cutting Edge T Foremost D-Spots Pride Famous Play	Emily & Amy Yeiser, Spots Pride Farm Arnold MD
*2286 ABS Daredevil Hotstuff D-03-03	169 12,747 3.9% 501 3.0%P 388P	03/01/2023 B&O	S-Hilltop Acres B Daredevil-ET D-Shiloh Kade Haelie NP	Evelyn Wyse and Alexis Blankenberg Platteville WI
*2287 Acclaimed Roxette-ETV		03/01/2023	S-Acclaimed D Scuba-ETV D-Voelkers Diego Rockstar-ETV	Kennedy, William, & Paige Zimmerman Brodhead WI
2288 Brown Heaven Design Freida		03/01/2023 B&O	S-HF Design-ET D-Brown Heaven Biver Frenchkiss	Brown Heaven Vercheres QC
*2289 Hilltop Acres D Tiana-ETV		03/01/2023 B&O	S-HF Design-ET D-Hilltop Acres Sky Toyota-ETV	L: Brinlee Courtney; O: Tanner Mashek Ridgeway IA
2290 Just So K Wicked D-03-03	305 16,450 5.0% 828 4.1%P 668P 365 19,436 5.0% 967 4.1%P 796P	03/01/2023 B&O	S-Hilltop Acres D Kickstart-ET D-Just So C Whizz	Just So Farm Lake Mills WI
2291 Knapp Ghost Wishful		03/01/2023	S-Knapp Foremost Ghost D-Cutting Edge D Winsome-ETV	Wincrest Genetics and Eva Gilmore Pearl City IL
2292 Kruses Diego Jennette-ETV		03/01/2023	S-Hilltop Acres Dynamite Diego-ET D-Kruses Victor Jiterbug-ET	Peter Vail Englewood FL
2293 Kruses Diego Mindy-ETV D-04-06	294 21,172 4.1% 886 3.5%P 756P	03/01/2023 B&O	S-Hilltop Acres Dynamite Diego-ET D-Kruses Victor Jiterbug-ET	Rick Kruse Earlville IA
2294 Oak Knoll Kallie		03/01/2023 B&O	S-Grindes Walter D-Oak Knoll Kalypso	Joseph Rule Dodgeville WI
2295 Odyssey F Skittles-ETV D-05-01	305 29,380 4.2% 1,228 3.3%P 972P 365 36,310 4.3% 1,548 3.4%P 1,218P	03/01/2023 B&O	S-Cutting Edge T Foremost D-Cutting Edge H Snap-ETV-OCS	Caleb Heck Freeport IL
*2296 Pit-Crew FChoice Taffy Twin		03/01/2023	S-Brown Heaven C First Choice-ET D-Pit-Crew Rampage Taranda	Macy Weyer Woodville WI
2297 Pit-Crew FChoice Taylon Twin		03/01/2023 B&O	S-Brown Heaven C First Choice-ET D-Pit-Crew Rampage Taranda	Pit-Crew Genetics Cambridge MN
*2298 Siegerts Daredevil Velvet		03/01/2023	S-Hilltop Acres B Daredevil-ET D-Lee-Anns Carter Viola	Abby Fairbanks Anamosa IA
*2299 Siegerts Prospect Rosealin		03/01/2023	S-Pit-Crew Rampage Prospect D-Double W Fast Rossie	Cade & Alice Mikkelson Viroqua WI

2300 Stylin R Villain	03/01/2023	B&O	S-Jo-Dee Royal Hill Rasta-ET D-Stylin D Vilanova	Leslie & Linda Bruchey Westminster MD
2301 Kruses ACC Jayla-ETV	12/06/2022		S-Voelkers TD Carter D-Kruses Victor Jiterbug-ET	Peter Vail Reedsburg WI
<b>Class 306 Winter Heifer Calf</b>				
Born 12/01/2022 - 02/28/2023				
Premiums: \$100, 90, 80, 70, 60, 50, 40, 40, 35, 35, 30, 30, 25, 25, 20, 15, 10, 10				
1st Place Award presented by Hilltop Acres Farm, Dennis & Barb Mashek and Family, Calmar, IA				
Bred & Owned Award presented by Jennings Gap Dairy, LLC, the Swope Family, Churchville, VA				
Junior Premiums: \$25, 20, 15, 15, 10, 10, 10, 10				
Junior Award presented by Prairie Hill Farm, Ashlee Garbers, Mindoro, WI				
2302 Nor Bella Dreamer Elia	01/23/2023	B&O	S-Jolahofs Superstar Dreamer-ET D-Nor Bella Wonder Elderberry	Troy McConnell Kincardine ON
2303 Shanks Martini Masha 388	01/19/2023	B&O	S-Hilltop Acres Biver Martini D-Shanks Jesse Marvel 289	Philip Shanks Harvard IL
2304 Kruses Foremost Jitty-ETV D-04-06	01/17/2023	B&O	S-Cutting Edge T Foremost D-Kruses Victor Jiterbug-ET	Rick Kruse Earlville IA
*2305 Jenlar Carter Wicked-ETV D-05-03	01/06/2023	B&O	S-Voelkers TD Carter D-Top Acres Garbro S Wish-ET	Brianna, Austin, & Abby Meyer Chilton WI
			305 30,280 4.3% 1,304 3.3%P 1,000P 365 35,470 4.2% 1,507 3.4%P 1,189P	
2306 C & A Time Out Ruthie	01/05/2023	B&O	S-Jennings Gap Time Out D-C & A Famous Baby Ruth-ETV	Ashley Swenson Nicollet MN
*2307 Pit-Crew Keep The Faith-ET	01/02/2023	B&O	S-Hilltop Acres B Daredevil-ET D-Pit-Crew Tanbark Koko	L: Abby Foss O: Pit-Crew Genetics Cambridge MN
*2308 Blessing Famous Anneka D-04-05	12/30/2022		S-Brown Heaven R Famous-ET D-Blessing Biver Anna	Caylee Nicole James Wolcottville IN
			305 24,490 4.6% 1,137 3.7%P 904P 365 29,180 4.6% 1,345 3.7%P 1,076P	
*2309 Pocket Aces Win The Natty-ETV	12/23/2022		S-Cutting Edge T Foremost D-Arethusa Naughty Or Nice-ET	Keenan Taylor Thygesen Tunbridge VT
*2310 Curvecrest D Cadillac	12/19/2022	B&O	S-HF Design-ET D-Curvecrest FF Camaro	Kelsey Erf Oakdale MN
2311 Brook Hollow Play To Win	12/16/2022	B&O	S-Brown Heaven Winningformula-ET D-Brook Hollow B-Day Present-ET	Delbert & Heather Yoder West Salem OH
*2312 Pit-Crew Diego Papaya-ET D-03-03	12/15/2022	B&O	S-Hilltop Acres Dynamite Diego-ET D-Pit-Crew Rich Peaches-Twin	L: Beau Trapp O: Pit-Crew Genetics Cambridge MN
			305 20,618 4.5% 921 3.4%P 701P 365 24,806 4.4% 1,079 3.4%P 845P	
2313 Blessing Garbro Famous Flam D-04-11	12/14/2022	B&O	S-Brown Heaven R Famous-ET D-Brooke-Lodge W Fireball-ET	Blessing Farms and Garrison Bros. Fort Wayne IN
			305 25,510 4.8% 1,223 3.7%P 936P 365 29,860 4.9% 1,449 3.7%P 1,112P	
2314 Round Hill Foremost Waldi-ETV D-04-00	12/14/2022	B&O	S-Cutting Edge T Foremost D-Top Acres Garbro Wanda-ET	Cindy Warner Frederick MD
			305 23,790 4.7% 1,109 3.6%P 864P	

*2315 W-Pine Grove Famous Layla	12/13/2022	B&O	S-Brown Heaven R Famous-ET D-W-Pine Grove Diego Libby	Wesley Winch Fennimore WI
*2316 Stosh Juke Daisy	12/12/2022	B&O	S-Triangle Acres Carter Juke D-Stosh Famous Dally	Jayse & Jaymeson Pudwill Dakota IL
*2317 Top Acres Daredevil Wisper ET	12/10/2022		S-Hilltop Acres B Daredevil-ET D-Top Acres Supreme Wisp	Griffin Brown Yarker ON
2318 Edge View D Darlene ETV	12/09/2022		S-Switzer Tals Drdvl Doboy-ET D-Cutting Edge T Delilah	Cripple Creek Farm Schuylerville NY
2319 Rich-Gen Foremost Ritchi-ETV	12/09/2022	B&O	S-Cutting Edge Foremost D-Jo-Dee Victor Radiant-ET	Travis Richardson Shelbyville TN
2320 Black Ridge Worth A Shot-ETV	12/08/2022	B&O	S-Brown Heaven C First Choice-ET D-Just So D Wrigley	Hayleigh Geurink and Kelvin Webster Blue Mounds WI
2321 Brown Heaven Elmstar Tinder	12/07/2022	B&O	S-Elmer's Lennox Elmstar D-Brown Heaven Salomon Tidbit	Brown Heaven Vercheres QC
*2322 Holtz-View Famous Gracelyn	12/07/2022	B&O	S-Brown Heaven R Famous-ET D-Holtz-View Wizdom Grace	Mary Holtz Maquoketa IA
*2323 Power Line Thunder Rayne-ET	12/05/2022	B&O	S-Cutting Edge Thunder D-Cutting Edge Zeus Ruffle-ET	L: Kendalyn Waddell; O: Ronald Kelm Waterloo WI
2324 V B Design Pitch Perfect	12/05/2022	B&O	S-HF Design-ET D-V B Biver Pixar ET	Voegeli Farm Inc. Monticello WI
2325 Blessing Garbro F Paulette D-02-09 305 24,769 4.5% 1,122 3.7%P 917P 365 28,714 4.8% 1,374 3.9%P 1,105P	12/04/2022	B&O	S-Brown Heaven R Famous-ET D-Blessing Garbro Biver Pam-ET	Blessing Farms and Garrison Bros. Fort Wayne IN
*2326 Knapp Foremost Chevelle-ET	12/04/2022		S-Cutting Edge T Foremost D-Old Mill Braidein Cinnamon-ET	Magen Busker and Josie Meier Ridott IL
*2327 Four Seasons Stretch Juliet	12/03/2022	B&O	S-Cutting Edge Stretch-ETV D-Four Seasons Moon Jubilee	David Schultheis Slippery Rock PA
*2328 Lucky-King Kickstart Nutz	12/03/2022	B&O	S-Hilltop Acres D Kickstart-ET D-Lee-Ann Hickory Pixie	Drew Lueking Centralia IL
2329 V B Diego Tailgate	12/03/2022	B&O	S-Hilltop Acres Dynamite Diego-ET D-V B Secret Weapon Truly	Voegeli Farm Inc. Monticello WI
*2330 ABS DD Magical Moment D-02-00 258 17,876 4.0% 722 3.1%P 551P	12/02/2022	B&O	S-Hilltop Acres B Daredevil-ET D-ABS Famous Madison	Alexis Blankenberg Platteville WI
2331 Brothers Three Dlx Wildcat-ETV	12/02/2022	B&O	S-Edge View C Deluxe-ETV D-Topp B3 Woodford	Brothers Three and Patrick Crave North Prairie WI
2332 Brothers Three Dlx Wiley-ETV	12/02/2022	B&O	S-Edge View C Deluxe-ETV D-Jenlar Mke Wins In Six-ETV	Brothers Three and Andrea & Brett Haines North Prairie WI

*2333 Edge View D Sofia-ETV	12/02/2022		S-Hilltop Acres B Daredevil-ET D-Fulp Agenda Sage-ET	Micah & Kylie Paige Sparrow Worthville KY
*2334 KADR Fritz Clarabelle	12/02/2022	B&O	S-Edge View C Fritz-ETV D-Kadr Famous Carmelita	Kassidy, Ashlynn, Delaney & Ryleigh Olinger Hagerstown IN
2335 M & M Carter Sage	12/02/2022	B&O	S-Voelkers TD Carter D-M & M Nemo Shes Mine	M & M Swiss-Jacob & Levi Stuessel Alma Center WI
*2336 Pit-Crew FChoice Kristin	12/02/2022	B&O	S-Brown Heaven C First Choice-ET D-Pit-Crew Daredevil Kona	L: Allison Foss O: Pit-Crew Genetics Cambridge MN
2337 A Joy Snowbell	12/01/2022	B&O	S-Voelkers TD Carter D-A Joy Rich Snowberry	Michala Kuhlman Rome PA
			305 26,940 4.2% 1,132 3.2%P 855P 330 28,430 4.2% 1,200 3.2%P 906P	
2338 Brothers Three Dix Wynnie-ETV	12/01/2022		S-Edge View C Deluxe-ETV D-Topp B-3 Woodford	Reid Tanis Nazareth PA
			D-02-10 72 6,296 4.6% 291 3.3%P 209P	
2339 Edge View D Denise-ETV	12/01/2022	B&O	S-Switzer Tals Drdvl Doboy-ET D-Cutting Edge T Delilah	Ken Main and Kenny Joe Manion Copake NY
			D-06-05 305 28,280 4.7% 1,334 3.5%P 992P 365 32,770 4.7% 1,554 3.6%P 1,170P	
2340 Jenlar First Choice Winner ETV	12/01/2022		S-Brown Heaven C First Choice-ET D-Jenlar Carter Waltz ETV	London Dairy Farms London ON
*2341 Siegerts Deluxe Holmoly	12/01/2022		S-Edge View C Deluxe-ETV D-CIE Siegerts Cash Hoopla	Payton Gibbs Epworth IA
			D-04-03 305 21,660 4.4% 898 3.7%P 753P	
*2342 Siegerts Shocker Cueuahs	12/01/2022		S-Kruses Deegan Shocker ET D-Siegerts Dynamyte China	William Sadler West Union IA
*2343 Silver Top Design Tricky	12/01/2022	B&O	S-HF Design-ET D-Silver Top Allstar Trick	L: Adele Biasini, O: Silver Top Swiss Morrisville VT
2344 Top Acres F Winit ETV	12/01/2022		S-Cutting Edge T Foremost D-Top Acres Supreme Wizard ET	Cripple Creek Farm Schuylerville NY
2345 V B First Choice Pedestal-ETV	12/01/2022	B&O	S-Brown Heaven C First Choice-ET D-Rosey D Legacy Pearl	Voegeli Farm Inc. Monticello WI
<b>Class 307 Fall Heifer Calf</b>				
Born 09/01/2022 - 11/30/2022				
Premiums: \$100, 90, 80, 70, 60, 50, 40, 40, 35, 35, 30, 30, 25, 25, 20, 15, 10, 10				
1st Place Award presented by Stylin Genetics, Leslie and Linda Bruchey, Westminster, MD				
Bred & Owned Award presented by Top diMark Swiss, the Regusci Family, Modesto, CA				
Junior Premiums: \$25, 20, 15, 15, 10, 10, 10, 10				
Junior Award presented by Knapp Genetics, Epworth, IA				
2346 Black Ridge P Double Take	11/01/2022	B&O	S-Pit-Crew Rich Phantom-ET D-Cutting Edge D Dynamic	Hayleigh Geurink and Kelvin Webster Blue Mounds WI
2347 Knapp Woody Final Countdown	11/01/2022	B&O	S-Cutting Edge Woody-ETV D-Just So D Faraway-ET	Knapp Genetics Epworth IA
			D-01-11 271 18,220 4.5% 812 3.3%P 605P	
2348 Hilltop Acres P Tulip-ET	10/20/2022	B&O	S-Hilltop Acres HM Pontiac-ETV D-Hilltop Acres K Tammie-ET	Tanner Mashek Calmar IA

*2349 V B Design Wapsi	10/01/2022		S-HF Design-ET D-V B HP Hilton Wasp	Abby Fairbanks Anamosa IA
*2350 Pit-Crew Phantom Krystalize	09/29/2022	B&O	S-Pit-Crew Rich Phantom-ET D-Pit-Crew Braiden Krystal	L: Allison Foss O: Pit-Crew Genetics Cambridge MN
2351 Edge View R Winsome-ETV	09/26/2022		S-Jo-Dee Royal Hill Rasta-ET D-Top Acres Peppy Wizella	Lexie Payne, Jason Lloyd, and Peter Vail Middleburgh NY
2352 Jenlar Rasta Westlynn-ETV	09/25/2022		S-Jo-Dee Royal Hill Rasta-ET D-Jenlar Carter Waltz ETV	Siemers Holsteins Lomira WI
2353 Round Hill Formo Wrigley-ET	09/25/2022	B&O	S-Cutting Edge T Foremost D-Top Acres Garbro Wanda-ET	Cynthia Warner Frederick MD
	05-00	305 17,460 4.0% 707 3.7%P 653P		
		330 18,300 4.1% 743 3.8%P 687P		
*2354 Little A Phantom Taz	09/23/2022	B&O	S-Pit-Crew Rich Phantom-ET D-Frozenes Tapit	Aaliyah Gunn Beloit WI
*2355 Fairdale Rasta St Croix-ETV	09/22/2022	B&O	S-Jo-Dee Royal Hill Rasta-ET D-La Rainbow Blfy Sunkist-ETV	Micah & Kylie Paige Sparrow Worthville KY
*2356 Hilltop Acres D Twirl-ETV	09/21/2022		S-HF Design-ET D-Hilltop Acres Sky Toyota-ETV	Brody Courtney Ridgeway IA
2357 Brook Hollow Cadance Halia	09/20/2022	B&O	S-Shiloh Brookings Cadence-ET D-Brook Hollow JP Honolulu-ET	Delbert & Heather Yoder West Salem OH
*2358 Blessing CNJ F Nycole-ETV	09/18/2022	B&O	S-Brown Heaven R Famous-ET D-Blessing CNJ T Norann-ET	Caylee Nicole James Wolcottville IN
	D-03-02	305 24,545 4.0% 988 3.4%P 843P		
		365 28,529 4.1% 1,160 3.5%P 1,000P		
2359 Hills Valley Foremost Lara	09/17/2022	B&O	S-Cutting Edge T Foremost D-Hills Valley Bush Loredo	Hill's Valley Farm, LLC Cattaraugus NY
2360 Edge View F Daring-ETV	09/16/2022		S-Brown Heaven R Famous-ET D-Cutting Edge T Delilah	John & Bonnie Ayars Mechanicsburg OH
	06-05	305 32,770 4.7% 1,554 3.6%P 1,170P		
2361 Edge View F Taylor-ETV	09/15/2022		S-Cutting Edge T Foremost D-Brittcos Carter Tbone	Seth & Shawn Nehls, Steve & Dori Lichty Beaver Dam WI
2362 Edge View F Winnie-ETV	09/15/2022	B&O	S-Cutting Edge T Foremost D-Top Acres Peppy Wizella	Ken Main and Kenny Joe Manion Copake NY
2363 Jenlar Diego Worthwhile-ETV	09/15/2022		S-Hilltop Acres Dynamite Diego-ET D-Jenlar Carter Waltz-ETV	Peter Vail Englewood FL
2364 Edge View F Tactful-ETV	09/14/2022	B&O	S-Cutting Edge T Foremost D-Brittcos Carter Tbone	Ken Main and Kenny Joe Manion Copake NY
2365 Edge View F Firefly-ETV	09/13/2022		S-Cutting Edge Foremost D-CIE Double W EM Favor	Louis & Garen Oliveira Hanford CA
*2366 Jenlar Martini Tipster	09/13/2022		S-Hilltop Acres Biver Martini D-Jenlar Doboy Twister	James Wanke Jackson WI

*2367 Red Brae Elisium Elizabeth	09/13/2022	B&O	S-Giacomini Elisium-ET	Elise & Brady Bleck
02-02 305 20,226 4.5% 908 3.4%P 693P			D-Sun-Made Richard Ella-ET	Muscoda WI
337 22,288 4.4% 980 3.4%P 766P				
2368 Edge View C Bridge-ETV	09/12/2022	B&O	S-Voelkers TD Carter	Ken Main and Kenny Joe Manion
D-07-00 305 28,760 3.4% 985 3.6%P 1,024P			D-Cutting Edge Titanium Branch	Copake NY
365 32,750 3.5% 1,143 3.6%P 1,182P				
2369 Opsal-J Pray 4 Forgiveness-ETV	09/12/2022	B&O	S-Kar-Linn Reeses Rampage	Joseph Opsal
			D-Opsal-J Dynamite Paparazzi	Blue Mounds WI
2370 Edge View F Snap-ETV	09/11/2022	B&O	S-Cutting Edge T Foremost	Ken Main and Kenny Joe Manion
			D-Cutting Edge P Sherry	Copake NY
2371 Meadow Hill Foremost Tikki	09/11/2022	B&O	S-Cutting Edge T Foremost	Gary Lee Mase
			D-Meadow Hill Famous Taco	Carlton PA
2372 Blessing Garbro F Phyllis-ETV	09/09/2022	B&O	S-Brown Heaven R Famous-ET	Blessing Farms and Garrison Bros.
D-04-08 305 24,470 4.5% 1,104 3.6%P 886P			D-On-A-Whim Cadence Pauline-ET	Fort Wayne IN
365 27,560 4.5% 1,251 3.6%P 1,004P				
2373 Jenlar Rasta Wow-ETV	09/09/2022		S-Jo-Dee Royal Hill Rasta-ET	Jesse & Kiley Muse
			D-Jenlar Carter Waltz-ETV	Etoile KY
*2374 Mil-K Defender Kandi Twin	09/09/2022	B&O	S-Hilltop Acres D Defender	O: Kaylen Miller; L: Ashlynn Schultz
			D-Mil-K Wizdom Kahlua	Orangeville IL
2375 Blessing Daredevil Flory	09/08/2022	B&O	S-Hilltop Acres B Daredevil-ET	Blessing Farms
D-03-08 305 24,780 4.0% 994 3.4%P 852P			D-Blessing Bosephus Franny	Fort Wayne IN
365 27,430 4.0% 1,093 3.4%P 946P				
2376 Blessing Doboy Krissy	09/08/2022	B&O	S-Switzer Tals Drdvl Doboy-ET	Blessing Farms
D-03-07 305 22,240 5.0% 1,108 3.7%P 832P			D-Blessing Formula Kirstin	Fort Wayne IN
365 26,530 5.1% 1,356 3.8%P 1,012P				
*2377 Horseshoe Hill Penelope	09/08/2022	B&O	S-Jo-Dee Nemo Richard-ET	L: Caroline Anderson; O: Joyce Uglow
D-05-10 305 21,421 4.2% 905 3.7%P 786P			D-Horseshoe Hill Parcheesi	Watertown WI
*2378 Opsal-J Pray For Mercy-ETV	09/08/2022	B&O	S-Kar-Linn Reeses Rampage	L: Cameron Ryan; O: Joseph Opsal
			D-Opsal-J Dynamite Paparazzi	Fond Du Lac WI
2379 Round Hill Carter Wallaby-ETV	09/08/2022		S-Voelkers TD Carter	Nate Catlett of Helion Genetics
			D-Top Acres Garbro Wanda-ET	Knoxville MD
2380 Kruses LJ Tank Shylo	09/07/2022	B&O	S-Cozy Nook Doboy Tank	Loras Kruse
D-04-02 286 14,797 4.8% 709 3.5%P 514P			D-Kruses LJ Frontier Sadie	Holy Cross IA
*2381 ABS Famous Mary	09/06/2022	B&O	S-Brown Heaven R Famous-ET	Alexis Blankenberg
D-08-00 305 20,214 4.1% 834 3.4%P 676P			D-Alexis Laura Design Misty	Platteville WI
345 22,558 4.1% 931 3.4%P 764P				
*2382 Blessing Garbo F Whitney	09/06/2022		S-Brown Heaven R Famous-ET	Katelyn Taylor
			D-Top Acres HP Winella-ET	Allenwood PA
*2383 Jenlar Diego Waterloo-ETV	09/06/2022	B&O	S-Hilltop Acres Dynamite Diego-ET	Brianna Meyer
D-03-04 305 32,460 4.1% 1,340 3.4%P 1,095P			D-Jenlar Carter Waltz-ETV	Chilton WI
365 38,300 4.2% 1,607 3.4%P 1,290P				

*2384 Just So C Facetime	09/06/2022		S-Voelkers TD Carter D-Just So V Fabulous	C, C & C Cannon and M, T & K Arnold Dyersville IA
2385 Edge View F Satisfaction-ETV	09/05/2022		S-Cutting Edge T Foremost D-Fulp Agenda Snickers-ET	Lexie Payne, Jason Lloyd, and Peter Vail Middleburgh NY
2386 Edge View F Sheer-ETV	09/05/2022	B&O	S-Cutting Edge T Foremost D-Fulp Agenda Snickers-ET	Ken Main and Kenny Joe Manion Copake NY
	D-08-02	305 21,270 4.5% 966 3.5%P 740P		
		365 24,210 4.5% 1,088 3.5%P 858P		
2387 V B HJ CV Famous Thriller-ETV	09/05/2022	B&O	S-Brown Heaven R Famous-ET D-V B HP Norwin Trya-ET	Voegeli Farms, Inc., H Voegeli Monticello WI
2388 Fairdale Famous Cora-ETV	09/04/2022	B&O	S-Brown Heaven R Famous-ET D-Fairdale Renegade S Candy-ET	Richard & Joe Sparrow Owenton KY
2389 Stylin R Prestyn-ETV	09/04/2022	B&O	S-Kar-Linn Reeses Rampage D-North Lanes Braid Present-ET	Leslie & Linda Bruchey Westminster MD
2390 Top Acres FM Winkie-ETV	09/04/2022	B&O	S-Cutting Edge T Foremost D-Top Acres Supreme Wizard-ET	Wayne E. Sliker St. Paris OH
	D-05-07	305 29,580 5.1% 1,516 3.3%P 982P		
		365 34,914 5.3% 1,840 3.3%P 1,163P		
*2391 Top Acres FM Winzit-ETV	09/04/2022		S-Cutting Edge T Foremost D-Top Acres Supreme Wizard-ET	Peyton Voegeli Poynette WI
*2392 A Joy D Plum	09/03/2022		S-Cutting Edge B Drake-ETV D-Cobyrock CP Peach	Lauren D L'amoreaux Louisville OH
2393 Encore-Gen Carter Primrose-ETV	09/03/2022		S-Voelkers TD Carter D-Precious B Peaceful-ET	TJ & Jazmin Wingert Kent IL
2394 Jenlar Famous Winslow-ET	09/03/2022		S-Brown Heaven R Famous-ET D-Jenlar Carter Waltz-ETV	Cindy Warner Frederick MD
	D-03-04	305 32,460 4.1% 1,340 3.4%P 1,095P		
		365 38,300 4.2% 1,607 3.4%P 1,290P		
*2395 KS Suzie Design Sound	09/03/2022	B&O	S-HF Design-ET D-KS Shila Bobby Suzie	Kiele Eberling Postville IA
2396 Lauterbach Famous Payton Twin	09/03/2022	B&O	S-Brown Heaven R Famous-ET D-Lauterbach C Perception	Korey and Torie Oechsle Delavan WI
*2397 WOCC Foremost Hurricane	09/03/2022		S-Cutting Edge T Foremost D-Kruses Carter Halo-ETV	Suton Paulson and Sage Dornan Rockford IL
2398 A Joy D Chiquita	09/02/2022		S-Cutting Edge B Drake-ETV D-A Joy W Cheetah	Peter Vail Englewood FL
*2399 BMG Timeout Lola	09/02/2022	B&O	S-Jennings Gap Time Out D-BMG Daredevil Laurel	L: Kelsey Erf; O: Blue Mountain Genetics Zumbro Falls MN
2400 Hills Valley Pactole Puzzle	09/02/2022		S-Pactole D-Hills Valley Carter Power	Jeremy Kinslow Smiths Grove KY
*2401 Way Lyn Famous Paris	09/02/2022		S-Brown Heaven R Famous-ET D-Way Lyn Braiden Perfect ET	Cynthia L Warner Frederick MD

2402 Wil-Ridge Ram Twister	09/02/2022	B&O	S-Kar-Linn Reeses Rampage D-Wil-Ridge Get Topsy	Madeline Schmidt Tomah WI
2403 Xtreme Daredevil Elaina-ET	09/02/2022	B&O	S-Hilltop Acres B Daredevil-ET D-Xtreme Pepper Exquisite	Beth Nelson and Aaron Johnson Ettrick WI
2404 A Joy RF Narnia	09/01/2022	B&O	S-A Joy Royal Flush D-A Joy G Nala-ET	Abbie Evans Little Meadows PA
2405 Christy's BM RP F Delicacy	09/01/2022	B&O	S-Brown Heaven R Famous-ET D-Christy's-BM FM Dynasty	Jon & Alexis Retzlaff, Gregg Christianson, Bill Medo Shawano WI
*2406 IE Four Seasons KS Sequin	09/01/2022	B&O	S-Hilltop Acres D Kickstart ET D-IDR Four Seasons B Sapphire	Josh Fry Butler PA
*2407 Just So D Sundown Twin	09/01/2022		S-La Rainbow Bfly Dynamite-ETV D-Just So B Sunwise	Dakota & Kinzey Sawyer Marshalltown IA
*2408 Knapp Foremost Bottoms Up	09/01/2022		S-Cutting Edge T Foremost D-Knapp Woody Bombshell	Abbie Gahring Homestead IA
*2409 Siegerts Coin Treasure	09/01/2022		S-Kulp-Terra Silver Coin D-CIE TSC Star B Tracy	Sophie J & Lexi Schaefer Galesville WI
*2410 Top Acres FM Wizer-ETV	09/01/2022		S-Cutting Edge T Foremost D-Top Acres Supreme Wizard-ET	Colt & Luke Buckley, M J S J M Saltzman & Andrew Carrier Lawrenceburg KY
2411 Triangle Acres Slam Phoenix	09/01/2022	B&O	S-Twinkle-Hill Sblamborghini D-Sun-Made TA Biv Palm-ET	John Korth Freeport IL
<p>Class <b>308 Summer Yearling Heifer</b>  Born 06/01/2022 - 08/31/2022  Premiums: \$100, 90, 80, 70, 60, 50, 40, 40, 35, 35, 30, 30, 25, 25, 20, 15, 10, 10  1st Place Award and Bred &amp; Owned Award presented by A Joy Swiss, Athens, PA  Junior Premiums: \$25, 20, 15, 15, 10, 10, 10, 10  Junior Award presented by the Young Family, Tinmouth, VT</p>				
*2412 Zumbach Rasta Desi Rose	08/06/2022	B&O	S-Jo-Dee Royal Hill Rasta-ET D-Zumbachs Dynamite Daphney	Nathen Zumbach Springville IA
*2413 AM Acres Discovery Adele	07/17/2022	B&O	S-Hilltop Acres H Discovery D-Am Acres Allstar Annabelle	Carmen & Ella Parish Linden WI
*2414 Holy Ayr Fire Burning	07/17/2022	B&O	S-Shiloh Brookngs Cadence-ET D-Oak Knoll SS Frost Bite	Noah Heine Helenville WI
*2415 Acclaimed DD Sailor-ETV	07/15/2022		S-Hilltop Acres B Daredevil-ET D-Kruses Joey Sugar	Evan Hathaway and Payton Calvert Barneveld WI
2416 Henzelwood Rampage Wabash	07/09/2022		S-Kar-Linn Reeses Rampage D-Henzelwood Tequila Wynter	Alexis Sherry Chambersburg PA
2417 Brook Hollow Cadance Hoey	07/05/2022	B&O	S-Shiloh Brookings Cadence-ET D-Brook Hollow Total Hoopla-ET	Delbert & Heather Yoder West Salem OH



2418 Iroquois Acres F Dreamy	07/02/2022	B&O	S-Brown Heaven R Famous-ET D-Iroquois Acres Cliff Dreamer	Iroquois Acres Bridport VT
*2419 Kadr Daredevil Vienna	06/30/2022	B&O	S-Hilltop Acres B Daredevil-ET D-North Lanes Prince Venice	Kassidy, Ashlynn, Delaney & Ryleigh Olinger Hagerstown IN
2420 Edge View J Talent	06/22/2022		S-Portmann BS Bays Jonmar D-New View SM Tickle	Mike Pierson Hamburg MN
*2421 Buckmeadow Seaman Willow	06/21/2022	B&O	S-Cutting Edge Seaman D-Kruses Tallant Wildcat	M, J & S Saltzman and C & L Buckley Lawrenceburg KY
2422 Meado-Brook Formost Keeley-ETV	06/20/2022	B&O	S-Cutting Edge T Foremost D-Eloc Wagor Kandid	Mitch Kappelman Manitowoc WI
*2423 Shadow Valley Daredevil Halo	06/20/2022	B&O	S-Hilltop Acres B Daredevil-ET D-Stylin S Hadley	Amelia Somers Walton NY
2424 Kulp-Gen Pactole Debbie-ET D-03-04 305 20,820 4.8% 1,005 3.6%P 743P 365 23,780 4.9% 1,155 3.6%P 863P	06/17/2022	B&O	S-Pactole D-Hilltop Acres Dario Deidra-ET	David & Anne Kulp Manheim PA
2425 JC Famous Snazzy	06/16/2022	B&O	S-Brown Heaven R Famous-ET D-JC Jongleur Satin	Jennifer Clark Lacrosse WI
*2426 Horseshoe Hill NU Twilight D-06-01 305 22,640 3.9% 890 3.4%P 772P	06/14/2022	B&O	S-Brown Heaven C First Choice-ET D-Horseshoe Hill NU Taylor	Nick Uglov Watertown WI
*2427 Edge View F Faraway	06/10/2022	B&O	S-Brown Heaven R Famous-ET D-Cutting Edge Thunder Faye	Kelly Jo Manion Copake NY
2428 Power Line Krunch Shania	06/09/2022		S-Kruses Foremost Krunch-ET D-Power Line Memo Suzanna-ET	Michael Waddell Waterloo WI
2429 8th Day Rhymes FM Reason	06/08/2022	B&O	S-Cutting Edge T Foremost D-8th Day Ryanns GW Rhyme	Aaron Olson Racine MN
*2430 La Rainbow Sweet Valerie-ETV	06/06/2022		S-CA Mascari Luth Bloom Lover D-La Rainbow Sweet Venus-TW	Aubree, Aiden & Alaina Topp and Jacob, Logan & Madison Harbaugh Marion WI
*2431 Northkill Creek Get Groovy D-05-02 305 29,697 4.0% 1,175 3.3%P 977P	06/05/2022	B&O	S-Voelkers TD Carter D-Northkill Creek Groovy	Hannah Balthaser Bernville PA
*2432 Red Brae Discovery Zander D-03-08 305 20,120 4.9% 977 3.6%P 724P 365 22,284 4.9% 1,094 3.7%P 815P	06/04/2022	B&O	S-Hilltop Acres H Discovery D-Red Brae Faust Zoeta	Elise & Brady Bleck Muscodia WI
2433 Jenlar Norwin Wiki-ETV	06/03/2022		S-Norwin D-Jenlar Carter Waltz-ETV	Philip Shanks Harvard IL
*2434 Jenlar Norwin Worldclass-ETV D-03-04 305 32,460 4.1% 1,340 3.4%P 1,095P 365 38,300 4.2% 1,607 3.4%P 1,290P	06/03/2022	B&O	S-Norwin D-Jenlar Carter Waltz-ETV	Brianna Meyer Chilton WI

2435 M & M Cadence Satin	06/03/2022	B&O	S-Shiloh Brookngs Cadence-ET D-M & M T Silk-ET	M & M Swiss-Jacob & Levi Stuessel Alma Center WI
*2436 Random Luck Win At Payne	06/03/2022		S-Brown Heaven Winningformula-ET D-Random Luck Legacy Paris	Kylie Osinga Hico TX
2437 Dahlhouse Winrite Nirvana	06/02/2022		S-Top Acres Cade Winrite-ETV D-Dahlhouse Carter Norma Jean	Beth Dahl, Peter Hawkes, Nicolette Shelley Delta UT
*2438 Hills Valley LT Dare2dream	06/02/2022	B&O	S-Hilltop Acres B Daredevil-ET  D-Hills Valley LT Wdy Darling	L: Brody Jackson; O: Hills Valley Farm and Lynn Telaak Cattaraugus NY
*2439 Payacres Famous Sunrise Twin	06/02/2022	B&O	S-Brown Heaven R Famous-ET D-Pyacres Twilight Sundrop	Brianna Paye Casco WI
2440 A Joy Rasta Pasta	06/01/2022	B&O	S-Jo-Dee Royal Hill Rasta-ET D-Coby Rock Cdnc Palm	Andrew & Abbie Evans Little Meadows PA
*2441 Crescentmead Claudia	06/01/2022		S-Old Mill WDE Supreme-ET D-Horseshoe Hill NU Clairra	Zackery A Schraufnagel Brownsville WI
2442 Meadow Hill Famous Alibi	06/01/2022		S-Brown Haven R Famous-ET D-Meadow Hill Dorito Annjet	Bret & Shelby Keister Cochranton PA
*2443 Stylin SW Promise	06/01/2022		S-Cutting Edge Secret Weapon D-Siegerts Damian Pinapple	Hayden Weaver Ephrata PA

**Class 309 Spring Yearling Heifer**

Born 03/01/2022 - 05/31/2022

Premiums: \$100, 90, 80, 70, 60, 50, 40, 40, 35, 35, 30, 30, 25, 25, 20, 15, 10, 10

1st Place Award presented by Horseshoe Hill, Norm & Joyce, Nick & Buffy Uglow, Watertown, WI

Bred & Owned Award presented by Jenlar Brown Swiss, Larry & Jennifer Meyer and Family, Chilton, WI

Junior Premiums: \$25, 20, 15, 15, 10, 10, 10, 10

Junior Award presented by Topp-View PC, Botkins, OH

2444 CIE Marshview Shotgun Perky	05/08/2022	B&O	S-Larainbow Sweet Shotgun-ETV D-IE Marshview Medal Popcorn	Dave and Amy Zentner Oshkosh WI
*2445 Jer-Lene I'm A Cali Girl	04/22/2022	B&O	S-Superbrown Kiba Superstar D-Iroquois Acres Jong Cali	Brian Pacheco Kerman CA
2446 Primrose Daredevil Sprinkles	04/15/2022	B&O	S-Hilltop Acres B Daredevil-ET D-Dublin-Hills Shondie	Darcy & Austin Ertmer Elizabeth IL
*2447 Scenic Ridge Phantom Lucylu	04/08/2022	B&O	S-Pit-Crew Rich Phantom-ET D-Scenic Ridge Tyler Lucy	L: Alexis Oakland; O: Scenic Ridge Swiss Elgin IA
2448 Brook Hollow Molten Hot	04/02/2022	B&O	S-Shiloh Brookings Cadence-ET D-Brook Hollow Hot Lava-ET	Delbert & Heather Yoder West Salem OH
*2449 Topp-View Kingsley Precious	03/30/2022	B&O	S-Gubelman Kingsley ET D-Topp-View Glenwood Pandemic	Madelyn Topp Wapakoneta OH
*2450 Udderconfusion Kstr Kristal	03/30/2022		S-Hilltop Acres D Kickstart-ET D-Grunders Chili Pepr Koffee-TW	Hailey M Kinney Durand IL

2451 Autumn Moon Oatmeal		03/27/2022		S-Brown Heaven R Famous-ET D-Autumn Moon Waffles ET	Alyssa Grocott and Lookout Farm Edmeston NY	
2452 Black Ridge W Triple Threat		03/20/2022	B&O	S-Cutting Edge Woody-ETV D-Sun-Made R Tinkerbelle-ET	Hayleigh Geurink and Kelvin Webster Blue Mounds WI	
*2453 Jenlar Carter Whimsical-ETV		03/19/2022	B&O	S-Voelkers TD Carter	Brianna, Austin, & Abby Meyer	
	D-05-03	305 30,280	4.3% 1,304	3.3%P 1,000P	D-Top Acres Garbro S Wish-ET	Chilton WI
		365 35,470	4.2% 1,507	3.4%P 1,189P		
2454 V B Can-Due Juno		03/17/2022	B&O	S-Kulp-Terra Hilton Can-Due-ET D-V B Dynamite July	Voegeli Farm Inc. Monticello WI	
*2455 Curvecrest Phouse Snowfall		03/15/2022	B&O	S-Hilltop Acres K Powerhouse ETV D-Curvecrest Delux Snowdaze	William Erf Oakdale MN	
*2456 Edge View R Sunshine-ETV		03/10/2022		S-Jo-Dee Royal Hill Rasta-ET D-Cutting Edge B Sonny	Summer Kiernan Copake NY	
*2457 Jenlar Famous Winslet-ETV		03/10/2022	B&O	S-Brown Heaven R Famous-ET D-Jenlar Carter Waltz-ETV	Brianna, Austin, & Abby Meyer Chilton WI	
	D-03-04	305 32,460	4.1% 1,340	3.4%P 1,095P		
		365 38,300	4.2% 1,607	3.4%P 1,290P		
*2458 Hilltop Acres PH Kia		03/07/2022		S-Hilltop Acres K Powerhouse D-Hilltop Acres KN Keisha	Jaclyn Osinga Hico TX	
*2459 Mase's Manor Lethal Weapon		03/07/2022	B&O	S-Cutting Edge Secret Weapon D-Mase's Manor Parker Layla ET	Makenna F. Mase Cochranon PA	
*2460 Silver Royal J Favorite		03/06/2022	B&O	S-Triangle Acres Carter Juke D-Kulp-Gen Carrier Fauna Twin	Eli Staudinger Reedsville WI	
2461 Oak Knoll Sbr Original		03/05/2022	B&O	S-Hilltop Acres B Daredevil-ET D-Gibraltar Liberate Taylor	Melinda Waddell and Jessica Whitaker Dodgeville WI	
2462 Blessing Phantom Vail		03/04/2022	B&O	S-V B Biver Phantom-ET D-Blessing Cadence Vianna	Blessing Farms Fort Wayne IN	
	D-02-05	305 17,706	4.8% 854	3.5%P 612P		
		365 21,760	4.9% 1,058	3.6%P 773P		
*2463 Birdsallway Famous Nell-ET		03/03/2022		S-Brown Heaven R Famous-ET D-Birdsallway Glenwood Nilla	Carter Kruse Dyersville IA	
*2464 Starry-Night J Lunar		03/03/2022		S-Triangle Acres Carter Juke D-Just Do D Tangle	Calen Jo Schraufnagel Brownsville WI	
2465 CIE Leecher Skyhigh Piper		03/02/2022	B&O	S-La Rainbow Bfly Skyhigh-ET D-IE Leecher Hickory Pumpkin	Alysha M Bauer Marshfield WI	
2466 Hager Hill F Turtle Dove		03/02/2022	B&O	S-Brown Heaven R Famous-ET D-Shiloh GL In A Tizzy-ET	Hager Hill Holsteins and Swiss Ellsworth WI	
*2467 Pit-Crew Daredevil Shay		03/02/2022	B&O	S-Hilltop Acres B Daredevil-ET D-Pit-Crew Formula Tawny	L: Abby Foss O: Pit-Crew Genetics Cambridge MN	
	D-02-02	305 14,225	4.7% 661	3.3%P 473P		
		365 16,842	4.7% 791	3.4%P 573P		

*2468 Pit-Crew Rasta Tricky	03/02/2022	B&O	S-Jo-Dee Royal Hill Rasta-ET	L: Kole Trapp O: Pit-Crew Genetics
D-03-11 305 25,298 3.6% 907 3.4%P 852P			D-Pit-Crew Formula Tricks	Cambridge MN
365 30,196 3.6% 1,091 3.4%P 1,035P				
*2469 Wapsi-Ana FNF Jordyn-ETV	03/02/2022	B&O	S-Brown Heaven R Fast&furious-ET	Abby Fairbanks
			D-Kruses GK Biver Jeanette	Anamosa IA
2470 Black Ridge R Look My Way	03/01/2022	B&O	S-Kar-Linn Reeses Rampage	Hayleigh Geurink and Kelvin Webster
			D-Knapp Woody Look At Me	Blue Mounds WI
*2471 Pit-Crew Phantom Nikita	03/01/2022	B&O	S-Pit-Crew Rich Phantom-ET	L: Allison Foss O: Pit-Crew Genetics
D-02-02 305 19,314 3.5% 668 3.3%P 628P			D-Pit-Crew Formula Nicky	Cambridge MN
365 23,091 3.5% 818 3.4%P 775P				
<b>Class 310 Winter Yearling Heifer</b>				
Born 12/01/2021 - 02/28/2022				
Heifer not in milk.				
Premiums: \$100, 90, 80, 70, 60, 50, 40, 40, 35, 35, 30, 30, 25, 25, 20				
1st Place Award presented by Korn Dairy, Terreton, ID				
Bred & Owned Award presented by Wisconsin Brown Swiss Association, Inc.				
Junior Premiums: \$25, 20, 15, 15, 10, 10				
Junior Award presented by Mil-K Valley, Orangeville, IL				
2472 Double W Kade Kate NP	02/01/2022		S-Double W Kade-P	Wincrest Genetics
			D-Double W Biver Kada	Pearl City IL
*2473 Lehearth Famous Someday	01/15/2022	B&O	S-Brown Heaven R Famous-ET	Nolan Kummer
			D-Terra Rose Cliff Shasta	Evans City PA
2474 Meadow Hill Famous Bourbon	01/10/2022	B&O	S-Brown Heaven R Famous-ET	Gary Lee Mase
			D-Meadow Hill B Booty Call	Carlton PA
*2475 Champion View DD Harmony-ETV	12/31/2021	B&O	S-Hilltop Acres B Daredevil-ET	Ellie G. Wideman
D-04-03 305 34,203 4.8% 1,643 3.2%P 1,106P			D-Champion View WF Hop	Gettysburg PA
365 39,608 4.8% 1,899 3.2%P 1,292P				
2476 CIE Marshview Percy Drizzle	12/15/2021	B&O	S-Sun Made Garbro Percy-ET	Dave and Amy Zentner
			D-IE Marshview Deegan Drizzy	Oshkosh WI
*2477 Pit-Crew Daredevil Khloe	12/08/2021	B&O	S-Hilltop Acres B Daredevil-ET	L: Abby Foss O: Pit-Crew Genetics
D-02-02 305 14,279 4.1% 590 3.4%P 479P			D-Pit-Crew Formula Kyra	Cambridge MN
339 15,867 4.2% 664 3.4%P 542P				
*2478 Blessing CNJ Famous Neva-ETV	12/07/2021	B&O	S-Brown Heaven R Famous-ET	Caylee Nicole James
D-04-02 305 24,366 4.5% 1,107 3.4%P 826P			D-Jo-Dee Vision Noel-ET	Wolcottville IN
365 28,053 4.5% 1,269 3.5%P 971P				
2479 Shelburne BR Dells Designer NP	12/07/2021		S-La Rainbow Sweet Spark ETV P	Hayleigh Geurink and Kelvin Webster
			D-Shelburne Deegan Dell	Blue Mounds WI
2480 Spots Pride SW Pearl	12/07/2021	B&O	S-Cutting Edge Secret Weapon	Emily & Amy Yeiser, Spots Pride Farm
			D-Spots Pride Famous Play	Arnold MD
2481 Browns Lady Lyza	12/04/2021		S-Brown Heaven R Famous-ET	Peter Vail
			D-Mort Java Luckey Lady	Reedsburg WI

2482 Edge View S Measure	12/04/2021		S-Cutting Edge D Silvertop D-Cutting Edge T Melody	Lane Domeyer Homestead IA
2483 Red Brae Powerball Zoie	12/04/2021		S-RNR Carter Powerball D-Red Brae Noble Zodeva	Marlin Gaff and Blessing Farm Wawaka IN
2484 Wapsi-Ana PB Supra	12/04/2021		S-RNR Carter Powerball D-Wapsi-Ana Richard Subaru	Melinda Waddell and Joseph Rule Dodgeville WI
2485 Myline DW Martinis Inxs	12/03/2021	B&O	S-Hilltop Acres Biver Martini D-Double W History Isabell	Jill & Brad Kinney and Double W Farm Dairy Durand IL
*2486 Pit-Crew Devils Rhythm	12/03/2021	B&O	S-Hilltop Acres B Daredevil-ET D-Pit-Crew Formula Rosebud-ET	L: Allison Foss O: Pit-Crew Genetics Cambridge MN
*2487 Random Luck ACC Pink-ETV	12/03/2021		S-Hilltop Acres B Daredevil-ET D-Random Luck S Peekaboo-ET	Jacob Betley Pulaski WI
2488 Opsal-J Pop A Bottle	12/02/2021	B&O	S-Brown Heaven R Famous-ET D-Opsal-J C Picture Perfect	Joseph Opsal & Peter Vail Blue Mounds WI
*2489 Hemsteads Victorious Vera	12/01/2021	B&O	S-Gubelman Kingsley ET D-Buckeye Knoll Dyna Peach	Lillian Hempfling Delphos OH
*2490 Hills Valley Pball Whopper	12/01/2021	B&O	S-RNR Carter Powerball D-Hills Valley Braiden Waffle	L: Brody Jackson, O: Hills Valley Farm, LLC Cattaraugus NY
2491 Just So W Tassel	12/01/2021		S-Cutting Edge Woody-ETV D-Kulp-Gen Anibal Tawny-ET	Peter Vail Englewood FL
2492 Twinkle-Hill T Amberlei-ETV	12/01/2021	B&O	S-Cozy Nook Daredevil Toby-ET D-Twinkle-Hill PS Amberlee	Twinkle-Hill Farm, Jeannie Winkelman Watertown WI

**Class 311 Fall Yearling Heifer**

Born 09/01/2021 - 11/30/2021

Heifer not in milk.

Premiums: \$100, 90, 80, 70, 60, 50, 40, 40, 35, 35

1st Place Award presented by RAD-ical Genetics, the Rucks Family, Okeechobee, FL

Bred & Owned Award presented by Jennings Gap Dairy, LLC, the Swope Family, Churchville, VA

Junior Premiums: \$25, 20, 15, 15

Junior Award presented by Top diMark Swiss, the Regusci Family, Modesto, CA

2493 Mil Neu Skyhigh Esther	10/16/2021		S-La Rainbow Bfly Skyhigh-ET D-Mil Neu Franken Miss Trudi	Kalee Schaefer Albany WI
2494 Opsal-J Fuel My Fire-ET	10/01/2021	B&O	S-Brown Heaven R Famous-ET D-RK Arthurst Tanbark Feisty	Joseph Opsal Blue Mounds WI
2495 Stef-N Famous Kelsi-ETV	09/22/2021	B&O	S-Brown Heaven R Famous-ET D-Stef-N Payoff Karma	Niki & Kelsi Steffenhagen Kenosha WI
*2496 Jenlar Famous Whiffle-ETV	09/19/2021		S-Brown Heaven R Famous-ET D-Jenlar Carter Waltz-ETV	Landen Knapp Epworth IA
2497 Edge View C Savanna-ETV	09/15/2021	B&O	S-Voelkers TD Carter D-Voelkers Durango Sasha	Ken Main and Kenny Joe Manion Copake NY
			D-05-07 305 32,000 6.7% 2,136 3.7%P 1,170P 365 36,860 6.8% 2,523 3.7%P 1,361P	

*2498 Red Brae Richard Fabulous D-03-09 305 21,471 5.3% 1,145 3.6%P 777P 365 22,950 5.3% 1,216 3.6%P 836P	09/12/2021 B&O	S-Jo-Dee Nemo Richard-ET D-Red Brae Norwin Fabiola	Elise & Brady Bleck Muscodia WI
*2499 Brook Hollow Caramel Apple	09/11/2021 B&O	S-Voelkers TD Carter D-Caramel Corn	L: Carissa Pittman O: Delbert & Heather Yoder and Deb & Dan McKenzie West Salem OH
2500 Edge View R Ruthie-ETV	09/10/2021 B&O	S-Jo-Dee Royal Hill Rasta-ET D-Cutting Edge A Ruby	Ken Main and Kenny Joe Manion Copake NY
2501 Meadow Hill PA Dare Bow	09/10/2021 B&O	S-Hilltop Acres B Daredevil-ET D-Meadow Hill Kingpin Billy Jo	Gary Lee Mase & Drake Hazlett Carlton PA
2502 JC Famous Delta V	09/06/2021 B&O	S-Brown Heaven R Famous-ET D-JC Whiskey Delightful	Jennifer Clark Lacrosse WI
*2503 Mase's Manor Make Me Famous	09/06/2021 B&O	S-Brown Heaven R Famous-ET D-Mase's Manor Winmore Money	Makenna F. Mase Cochranon PA
2504 Kruses ACC C Just Dance-ETV D-04-06 305 21,170 4.2% 886 3.6%P 756P	09/05/2021	S-Voelkers TD Carter D-Kruses Victor Jiterbug-ET	Glamourview-lager & Walton Walkersville MD
2505 Blessing Garbro K Gorgeous D-02-09 305 23,480 4.8% 1,117 3.7%P 875P 365 28,210 4.8% 1,356 3.8%P 1,071P	09/04/2021	S-Gubelman Kingsley ET D-Cutting Edge C Gattinara-ETV	Caylee Nicole James Wolcottville IN
2506 Thorndale Wdy Ivy League-ET	09/04/2021 B&O	S-Cutting Edge Woody-ETV D-Thorndale Fam Ivy-ETV	Donald Partridge Batavia NY
*2507 M & M Victor Showstopper	09/03/2021 B&O	S-SCF Jet Victor Twin D-M & M Total Snickers	M & M Swiss-Jacob & Levi Stuessel Alma Center WI
2508 Bell-Manor Paulo Pint	09/02/2021	S-Wind Mill Pence Paulo 148 D-Bell-Manor Wm Angelo Poise	Jill & Brad Kinney Durand IL
2509 Fairdale Daredevil Talia-ETV	09/02/2021	S-Hilltop Acres B Daredevil-ET D-Sun-Made HP Wndt Tobie-ET	Peter Vail Englewood FL
*2510 Knapps DD Challenge ETV	09/02/2021	S-Hilltop Acres B Daredevil-ET D-Hartmanhills Durham Charisma	Daleyn Gehrig Jerusalem OH
2511 Edgeview D Sawyer-ETV	09/01/2021	S-Jo-Dee Royal Hill Rasta-ET D-Voelkers Durango Sasha	Jesse & Kiley Muse Etoile KY

**Class 315 Junior Champion Female of the Junior Show**

Award courtesy of Lee-Ann's Swiss, Dewitt, IA  
 \$250 Junior Champion of the Junior Show Cash Award presented by Misty Meadow Dairy, the Hogan family, Tillamook, OR  
 Champion Banner presented by Select Sires, Inc., Plain City, OH  
 Rosette presented by Doug & Linda Hodorff, Eden, WI

**Class 316 Reserve Junior Champion Female of the Junior Show**

Award presented by Mil-K Valley, Orangeville, IL  
 Reserve Champion Banner presented by Select Sires, Inc., Plain City, OH  
 Rosette presented by St. Jacobs ABC, DeForest, WI

**Class 317 Junior Champion Female**

Norman E. Magnussen Memorial Award presented by E-Zee Milking Equipment, LLC, McFarland, WI  
 \$500 Junior Champion Cash Award presented by Cargill Animal Nutrition, Watertown, WI  
 Champion Banner presented by Select Sires, Inc., Plain City, OH  
 Rosette presented by GenOvations, Lodi, WI

**Class 318 Reserve Junior Champion Female**

Award presented by Royal Hill Swiss, Don Graft, Fort Wayne, IN  
 Reserve Champion Banner presented by Select Sires, Inc., Plain City, OH  
 Rosette presented by Phibro Animal Health Corp., Quincy, IL

**Class 319 Junior Best Three Females**

Group to consist of 3 animals Fall Yearling (not in milk) and younger, none of which have freshened. All three animals must have been bred by exhibitor and at least one owned by exhibitor. Partnership bred animals, outside the family, may not be included in this class. Each exhibitor limited to one entry.

Premiums: \$75, 65, 55, 45, 35

1st Place Award presented by Uffda Genetics, Foreston, MN

2512 Andrew & Abbie Evans  
 Little Meadows PA

2513 Armbruster Bros Farms Inc  
 Muscoda WI

2514 Blessing Farms  
 Fort Wayne IN

2515 Blessing Farms and Garrison Bros.  
 Fort Wayne IN

2516 Brianna Meyer  
 Chilton WI

2517 Brianna, Austin, & Abby Meyer  
 Chilton WI

2518 Brothers Three Brown Swiss  
 North Prairie WI

2519 Brown Heaven  
 Vercheres QC

2520 Delbert & Heather Yoder  
 West Salem OH

2521 Fairdale Farm LLC  
 Worthville KY

2522 Gary Lee Mase  
 Carlton PA

2523 Hayleigh Geurink and Kelvin Webster  
 Blue Mounds WI

2524 Joseph Opsal  
 Blue Mounds WI

2525 Just So Farm  
Lake Mills WI

2526 Kassidy, Ashlynn, Delaney & Ryleigh Olinger  
Hagerstown IN

2527 Ken Main and Kenny Joe Manion  
Copake NY

2528 M & M Swiss, Matt, Megan, Jake & Levi Stuessel  
Alma Center WI

2529 Pit-Crew Genetics  
Cambridge MN

2530 Pit-Crew Genetics  
Cambridge MN

2531 Rick Kruse  
Earlville IA

2532 Voegeli Farm Inc.  
Monticello WI

**Class 320 Genomic Merit of the Heifer Show**

(Not a lead-out class.) The highest genomic merit heifer in the show will receive an award based on a combination of Genomic PPR, Genomic \$NM and the show placing. The heifer must stand in the top ten places of her class and exhibitor nominated with a complete genomic test results for the animal sent to the National Brown Swiss office by September 1 of the current year. Award is presented by the National Brown Swiss Association.

**Class 321 Premier Breeder of Heifer Show**

Royal Banner presented by Agpro, Inc., Paris, TX

**Class 322 Premier Exhibitor of Heifer Show**

Royal Banner presented by Agpro, Inc., Paris, TX

**Class 323 Premier Sire of the Heifer Show**

Royal Banner presented by St. Jacobs ABC, DeForest, WI

**Class 325 Yearling Heifer in Milk**

Born 09/01/2021 - 12/31/2021

Cow must have freshened and in milking form.

Premiums: \$150, 140, 130, 120, 110, 100

1st Place Award presented by Voelker Swiss Farm LLC, the Voelker Family, Perryville, MO

Bred & Owned Award presented by Armbruster Bros. Farms, Inc., Muscoda, WI

Best Udder Rosette presented by Holstein International and Cattle Connection, Stiens, The Netherlands

Junior Premiums: \$50, 35

Junior Award presented by Hilltop Acres Farm, Dennis & Barb Mashek and Family, Calmar, IA

*2533 Top Line Doboy Frenzy	12/27/2021	B&O	S-Switzer Tals Drdvl Doboy-ET D-Walnut Crest Thunder Fresca	Alex Roe Monticello WI
2534 Horseshoe Hill Caden Tango D-06-04 305 22,470 4.3% 975	11/12/2021	B&O	S-Shiloh Brookings Cadence-ET D-Horseshoe Hill Tanqueray	Joyce Uglow Watertown WI
2535 V B Elmstar Nickelback	09/28/2021	B&O	S-Elmer's Lennox Elmstar D-V B Dynamite Nadine	Voegeli Farm Inc. Monticello WI



*2536 Jenlar Famous Whirl-ETV	09/18/2021	B&O	S-Brown Heaven R Famous-ET	Brianna, Austin, & Abby Meyer
D-03-04 305 32,460 4.1% 1,340 3.4%P 1,095P			D-Jenlar Carter Waltz-ETV	Chilton WI
365 38,300 4.2% 1,607 3.4%P 1,290P				
*2537 Edge View C Dallas-ETV	09/11/2021		S-Voelkers TD Carter	Sydney Bullard and Addison & Theo Goldenburg
			D-Cutting Edge T Delilah	Turner ME
*2538 Jenlar Rasta Wissota-ETV	09/06/2021	B&O	S-Jo-Dee Royal Hill Rasta-ET	Brianna Meyer
D-03-04 305 32,460 4.1% 1,340 3.4%P 1,095P			D-Jenlar Carter Waltz-ETV	Chilton WI
365 38,300 4.2% 1,607 3.4%P 1,290P				
*2539 Edge View D Rylee-ETV	09/03/2021		S-Hilltop Acres B Daredevil-ET	Kylie & Kiara Konyn
			D-Cutting Edge A Ruby	Delavan WI
2540 Get-R-Done Daredevil Gunsmoke	09/03/2021		S-Hilltop Acres B Daredevil-ET	Steve Wagner
01-10 40 1,950 3.5% 68 3.1%P 60P			D-Get-R-Done Kingpin Ginnie	Gray ME
2541 Kruses ACC S Jiggle-ETV	09/03/2021		S-La Rainbow Sweet Salsa-ETV	Acclaimed Swiss
04-06 294 21,170 4.2% 886 3.6%P 756P			D-Kruses Victor Jiterbug-ET	Epworth IA
2542 Kruses Salsa Bonnie-ETV	09/03/2021		S-La Rainbow Sweet Salsa-ETV	Pocket Aces Swiss
D-04-06 294 21,170 4.2% 886 3.6%P 756P			D-Kruses Victor Jiterbug-ET	Epworth IA
2543 Top Acres Diego Wizer	09/03/2021		S-Hilltop Acres Dynamite Diego-ET	Cripple Creek Farm
01-11 26 1,118 3.7% 41 2.6%P 30P			D-Top Acres Supreme Wizard	Schuylerville NY
2544 Jenlar Rasta Welcome-ETV	09/01/2021		S-Jo-Dee Royal Hill Rasta-ET	R & L Read, L Olson, L & B Beckard, T Graves
			D-Jenlar Carter Waltz-ETV	Hutchinson MN

### Class 327 Summer Junior Two-Year-Old Cow

Born 06/01/2021 - 08/31/2021

Premiums: \$150, 140, 130, 120, 110, 100, 90, 80

1st Place Award presented by Pit-Crew Genetics, Cambridge, MN

Bred & Owned Award presented by Jennings Gap Dairy, LLC, the Swope Family, Churchville, VA

Best Udder Rosette presented by Holstein International and Cattle Connection, Stiens, The Netherlands

Junior Premiums: \$50, 35, 25

Junior Award presented by Hills Valley Farm, Cattaraugus, NY

*2545 Sar-Boh Silver Whip	07/22/2021	B&O	S-La-Rainbow Sweet Silver-ET	Sarah Hagenow
			D-Top Acres HP B Whizkid-ET	Poynette WI
*2546 Jenlar FC Windmill-ETV	07/17/2021		S-Brown Heaven C First Choice-ET	Brody Jackson, Blake & Garrett Hill
01-11 41 3,322 4.0% 133 3.1%P 102P			D-Jenlar Carter Waltz-ETV	Cattaraugus NY
2547 Hills Valley C Freckles-ET	07/08/2021	B&O	S-Shiloh Brookings Cadence-ET	Hill's Valley Farm, LLC
01-11 31 1,907 4.2% 80 3.3%P 63P			D-Round Hill Braiden Fenny	Cattaraugus NY
2548 Knapp Woody Pamela	07/03/2021		S-Cutting Edge Woody-ETV	Peter Vail
01-11 38 2,417 3.4% 81 3.1%P 74P			D-Acclaimed D Pia-ETV	Englewood FL
2549 HF O Summer Dream	06/27/2021		S-O Malley	Philip Shanks
			D-HF Liberate Dream On	Harvard IL
2550 Mayers First Choice Vesper	06/25/2021	B&O	S-Brown Heaven C First Choice-ET	Mayer Farm, Dylan Mayer
02-00 36 2,130 4.1% 88 3.3%P 71P			D-Mayers Carter Vingdot	Slinger WI

2551 Brown Heaven Calvin Firenight ET	06/24/2021	B&O	S-Vetschs Nesta Calvin-ET D-Brown Heaven Biver Firework ET	Brown Heaven Vercheres QC
2552 A Joy W Nike 01-11 41 2,429 3.3% 81 3.0%P 72P	06/15/2021	B&O	S-Top Acres Cade Winrite-ETV D-A Joy C Nissan	Abbie Evans Little Meadows PA
2553 Double W Finn Sheer	06/14/2021	B&O	S-Double W Finnigan D-Double W Chacal Sutton	Double W Dairy Farm Holyoke CO
2554 Just So R Fresca 01-11 69 4,392 3.3% 148 3.1%P 137P	06/06/2021	B&O	S-Jo-Dee Royal Hill Rasta-ET D-Just So D Frisky	Just So Farm Lake Mills WI
2555 Bittersweet Cayenne Rosa	06/02/2021		S-R Hart Cayenne Pepper D-Bittersweet Richard Rosey	Sara Price Montfort WI
2556 Double J Famous Sniper	06/02/2021	B&O	S-Brown Heaven R Famous-ET D-Spring-Vale Seaman Snickers	Jordan Helsley Roaring Spring PA
2557 Edge View D Fern	06/02/2021		S-La Rainbow Bfly Dynamite-ETV D-Cutting Edge F Faroh-ETV	Knapp Genetics, K Koopmann and Jim Hammerand Epworth IA
*2558 Pit-Crew Phantom Kristine	06/02/2021	B&O	S-Pit-Crew Rich Phantom-ET D-Pit-Crew Daredevil Kona	L: Abby Foss O: Pit-Crew Genetics Cambridge MN
2559 Top Acres DD Wizett-ETV D-07-05 305 29,960 4.9% 1,482 3.6%P 1,066P	06/02/2021		S-Hilltop Acres B Daredevil-ET D-Top Acres Supreme Wizard-ET	Philip Shanks Harvard IL
*2560 Xtreme Phantom Tea	06/02/2021		S-V B Biver Phantom-ET D-Groves-Sun Jonglr Teacup-ET	Micah & Kylie Paige Sparrow Worthville KY
2561 Daveco WF Frankie 02-00 18 1,188 4.1% 47 2.7%P 24P	06/01/2021	B&O	S-Brown Heaven Winningformula-ET D-Daveco Dynamite Faye	Jillian Bonow Lewiston MN

**Class 328 Junior Two-Year-Old Cow**

Born 03/01/2021 - 05/31/2021

Premiums: \$150, 140, 130, 120, 110, 100, 90, 80, 70, 60

1st Place Award presented by Muffets Twin Acre, Jacob & Elizabeth Roedl, Edgewood, IL

Bred & Owned Award presented by Brothers Three Brown Swiss, the Hushon Family, North Prairie, WI

Best Udder Rosette presented by Holstein International and Cattle Connection, Stiens, The Netherlands

Junior Premiums: \$50, 35, 25

Junior Award presented by RAD-ical Genetics, the Rucks Family, Okeechobee, FL

2562 Olson 4th Generation Chloe	04/24/2021	B&O	S-Cozy Nook Carter Tequila ET D-V B Hillpoint Mischief ET	Trygve Olson Black Earth WI
2563 Twinkle-Hill Merica Amble 1535 02-04 23 1,150 5.5% 63 4.0%P 46P	04/15/2021		S-Hilltop Acres TK Merica-ET D-Twinkle-Hill K Ambiance-ETV	Hayden Hauschildt Ellsworth WI
*2564 Goldfawn Rampage Partytime	04/10/2021	B&O	S-Kar-Linn Reeses Rampage D-Goldfawn Braidn Petunia	Theo Goldenberg Mcgregor TX
2565 Ar-Line Doboy Lilac	04/09/2021	B&O	S-Switzer Tals Drdvl Doboy-ET D-Ar-Line Davenport Lavender	Ranae Herman Bangor WI
*2566 Pit-Crew Daredevil Kyla-ET	04/01/2021	B&O	S-Hilltop Acres B Daredevil-ET D-Pit-Crew Tanbark Koko	L: Allison Foss O: Pit-Crew Genetics Cambridge MN

2567	Edge View F Bailey	03/26/2021	B&O	S-Cutting Edge T Foremost	Kelly Jo Manion
	02-03 24 1,296 4.0% 52 3.5%P 45P			D-Meadow Hill Famous BJ	Copake NY
2568	Jaden Rasta Dance	03/26/2021	B&O	S-Jo-Dee Royal Hill Rasta-ET	Hayden Hauschildt
	01-11 179 8,290 4.1% 341 3.3%P 276P			D-Jaden B Dahlia	Ellsworth WI
2569	All-Glo Rampage Prim-ETV	03/24/2021	B&O	S-Kar-Linn Reeses Rampage	Justin & Ashley Kaufman
	D-05-10 305 19,661 3.7% 721 3.3%P 639P			D-Just-In Braiden Paradise	Berlin PA
	365 22,527 3.7% 837 3.3%P 741P				
2570	Mayers Bank It Natalia	03/21/2021	B&O	S-La Rainbow Bfly Bank It	Mayer Farm, Kayla & Devin Mayer
	02-00 136 9,095 4.1% 375 2.9%P 263P			D-Sun-Made Elite S Nora-ET	Slinger WI
*2571	Ronick Kingsley Prudencia	03/21/2021		S-Gubelman Kingsley ET	Brian Pacheco
	02-00 118 4,067 4.5% 173 3.4%P 129P			D-Ronick Goldmine Prudence	Kerman CA
2572	Horseshoe Hill Nor Blossom	03/18/2021	B&O	S-Norwin	Joyce & Nick Uglov
	02-02 103 6,333 3.9% 244 3.0%P 192P			D-Horseshoe Hill Bumblebee	Watertown WI
2573	Brook Hollow Total Please Me	03/17/2021	B&O	S-Sunnyisle Total-ET	Delbert & Heather Yoder
				D-Brook Hollow Miss Pout	West Salem OH
2574	Acclaimed Secret Dreams-ETV	03/15/2021		S-Cutting Edge Secret Weapon	Hayleigh Geurink and Kelvin Webster
	01-11 97 6,722 4.0% 267 3.3%P 219P			D-Cutting Edge W Dasher ETV	Blue Mounds WI
2575	Thorndale Drake Vivid-ET	03/15/2021	B&O	S-Cutting Edge B Drake-ETV	Donald Partridge and Hills Valley Farm
				D-Lake Lane PG Vivia	Castile NY
*2576	WF Dynamite Tanna	03/15/2021		S-La Rainbow Bfly Dynamite-ETV	Kalley and Brielle Christen
	02-01 138 6,328 3.6% 230 3.2%P 204P			D-WF Furious Tanna-ET	Lester Prairie MN
*2577	Knapp Woody Banker-ETV	03/08/2021	B&O	S-Cutting Edge Woody-ETV	Landen Knapp
				D-We Sell Bose 4708	Epworth IA
2578	Edge View C Dynamic-ETV	03/06/2021	B&O	S-Vetschs Nesta Calvin-ET	Ken Main and Kenny Joe Manion
				D-Cutting Edge T Delilah	Copake NY
2579	Blessing Garbro Famous Fire	03/05/2021	B&O	S-Brown Heaven R Famous-ET	Blessing Garrison and L & D Fraley
	D-04-11 305 25,510 4.8% 1,223 3.7%P 936P			D-Brooke-Lodge W Fireball-ET	Fort Wayne IN
	365 29,860 4.9% 1,449 3.7%P 1,112P				
2580	Edge View C Whirl-ETV	03/05/2021		S-Vetschs Nesta Calvin-ET	Voelker Bros Syndicate
	D-08-03 291 22,050 4.3% 957 3.4%P 743P			D-Top Acres Peppy Wizella	Perryville MO
*2581	Edge View N Dagmar	03/05/2021	B&O	S-Norwin	Kelly Jo Manion
	02-03 44 2,180 4.2% 91 3.3%P 73P			D-Cutting Edge D Dharma-ETV	Copake NY
*2582	Payacres Diego Smirnoff	03/05/2021	B&O	S-Hilltop Acres Dynamite Diego-ET	Brianna Paye
				D-Payacres Twilight Sundrop	Casco WI
2583	RNR Cadence Jayla	03/04/2021		S-Shiloh Brookings Cadence-ET	Blessing Farms and Garrison Bros.
	D-05-06 305 27,980 4.1% 1,136 3.6%P 1,007P			D-RNR Biver Juliet	Fort Wayne IN
	365 24,137 4.7% 1,096 3.6%P 870P				
2584	Empire Winrite Lotus	03/02/2021		S-Top Acres Cade Winrite-ETV	Dylan Fry
				D-Empire Ces Lexus-ET	Chestertown MD

2585	Brown Heaven Elmstar Fancygirl ET	03/01/2021	B&O	S-Elmer's Lennox Elmstar	Brown Heaven
	02-00 125 16,936 4.6% 783 3.5%P 595P			D-Brown Heaven J Fancy-ET	Vercheres QC
2586	GM2 Diego Silverado	03/01/2021		S-Hilltop Acres Dynamite Diego-ET	Louis & Garen Oliveira
	02-03 43 2,568 3.2% 90 3.1%P 86P			D-Renegade Kingpin Sabrina	Hanford CA
*2587	Pit-Crew Rampage Nola OCS	03/01/2021		S-Kar-Linn Reeses Rampage	Cael, Chase & Caden Cannon
	D-01-11 305 18,340 4.3% 780 3.4%P 620P			D-Pit-Crew Daredevil Noelle	Dyersville IA
<b>Class 329 Senior Two-Year Old Cow</b>					
Born 09/01/2020 - 02/28/2021					
Premiums: \$150, 140, 130, 120, 110, 100, 90, 80, 70, 60, 50, 45, 40, 40					
1st Place Award presented by Hilltop Acres Farm, Dennis & Barb Mashek and Family, Calmar, IA					
Bred & Owned Award presented by Round Hill Acres, Cynthia Warner, Frederick, MD					
Production Rosette presented by Case IH, Racine, WI					
Best Udder Rosette presented by Holstein International and Cattle Connection, Stiens, The Netherlands					
Junior Premiums: \$50, 35, 25					
Junior Award presented by Oak Knoll Farm, Randy & Tammy Rule, Dodgeville, WI					
*2588	Red Brae Skyhigh Lynlee-OCS	12/12/2020	B&O	S-La Rainbow Bfly Skyhigh-ET	Elise Bleck
	02-07 22 1,176 3.9% 46 3.4%P 40P			D-Red Brae SPA Goliath Lucy	Muscoda WI
2589	Blessing Diego Faith	12/07/2020	B&O	S-Hilltop Acres Dynamite Diego-ET	Blessing Farms
	D-03-05 305 24,510 4.3% 1,056 3.7%P 909P			D-Blessing Biver Floria-ETV	Fort Wayne IN
	365 27,868 4.5% 1,252 3.8%P 1,060P				
2590	Blessing Garbro F Patrice-ETV	12/06/2020	B&O	S-Brown Heaven R Famous-ET	Blessing Farms and Garrison Bros.
	D-03-09 305 28,150 4.7% 1,332 3.4%P 947P			D-Sun-Made GB Plt Pretzel-ET	Fort Wayne IN
	365 31,970 4.6% 1,480 3.4%P 1,081P				
2591	Edge View F Sophia-ETV	11/08/2020	B&O	S-Brown Heaven R Famous-ET	Ken Main and Kenny Joe Manion
	02-04 140 9,440 4.4% 413 3.6%P 338P			D-Cutting Edge P Sherry	Copake NY
2592	Voelkers Nello Asher	10/30/2020	B&O	S-Pleischs Nelgor Nello	Charles Voelker
	02-04 100 5,652 3.4% 194 3.1%P 178P			D-Voelkers Carter Aron	Perryville MO
2593	Ritchie View Dare Bel Jingles	10/12/2020	B&O	S-Hilltop Acres B Daredevil-ET	Mountain View Meadows Brown Swiss
	02-00 283 20,554 4.0% 819 3.1%P 633P			D-Mtn View Benjis Liberty Bel	Winlock WA
2594	Edge View C Deanna-ETV	09/19/2020		S-Voelkers TD Carter	Brian Pacheco
	02-07 94 7,400 3.7% 289 2.9%P 222P			D-Cutting Edge T Delilah	Kerman CA
2595	Groves View Luke Tabby	09/19/2020		S-Groves View Teq Nuke-ET	London Dairy Farms
				D-Groves-Sun Powrply Tenae-ET	London ON
2596	All-Glo Famous Pineapple-ETV	09/18/2020		S-Brown Heaven R Famous-ET	London Dairy Farms
				D-All-Glo Carter Popsicle	London ON
*2597	Clover Lane Karly-OCS	09/10/2020	B&O	S-Kar-Linn Reeses Rampage	Lauren & Gavin Kishman
				D-Clover Lane Thunder Hazzel	Monona IA
2598	Jaden Famous Celebrity	09/09/2020	B&O	S-Brown Heaven R Famous-ET	Hayden Hauschildt
	02-02 280 19,951 4.6% 920 3.3%P 652P			D-Jaden Total Chaos	Ellsworth WI
2599	Brook Hollow Norwin Mischief	09/08/2020	B&O	S-Norwin	Delbert & Heather Yoder and Heartland Dairy
	02-05 128 10,022 2.6% 261 3.3%P 331P			D-Brook Hollow Wonder Macaroon	West Salem OH

2600 Edge View N Forever-ETV 02-06	136 8,025 4.1% 327	09/08/2020 B&O	S-Norwin D-CIE Double W EM Favor	Ken Main and Kenny Joe Manion Copake NY
2601 Hilltop Acres EM Polly-ETV 01-09	305 28,872 4.7% 1,362	09/05/2020 B&O	S-Elmer's Lennox Elmstar D-Hilltop Acres Cad Paula	Dennis Mashek Calmar IA
2602 Kruses Carter Jive-ETV 02-07	106 7,418 3.6% 269	09/03/2020	S-Voelkers TD Carter D-Kruses Victor Jiterbug-ET	Peter Vail Englewood FL
*2603 Shiloh F Martini Honey D-03-00	305 11,966 3.8% 450	09/03/2020	S-Hilltop Acres Biver Martini D-Shiloh Tonka Heather-ET	Adele Biasini Morrisville, VT
2604 Brown Heaven Kade Friend 02-01	305 22,693 4.3% 975	09/01/2020 B&O	S-Double W Kade-P D-Brown Heaven Biver Frenchkiss	Brown Heaven Vercheres QC
2605 Krahn girls Dyna Whiskey Twin		09/01/2020	S-La Rainbow Bfly Dynamite-ETV D-VB HP Supreme Worthy-ET	Fairdale Farm LLC Worthville KY
*2606 Pearl Dell Drake Whitney 02-07	116 8,253 3.7% 308	09/01/2020 B&O	S-Cutting Edge B Drake-ETV D-Hylight Cadence Winnie	Elizabeth D Schieferstine Vernon NY

**Class 332 Junior Three-Year-Old Cow**

Born 03/01/2020 - 08/31/2020

Premiums: \$150, 140, 130, 120, 110, 100, 90, 80, 70, 60, 50, 45

1st Place Award and Bred & Owned Award presented by Royal Hill Swiss, Don Graft, Fort Wayne, IN

Production Rosette presented by Case IH, Racine, WI

Best Udder Rosette presented by Holstein International and Cattle Connection, Stiens, The Netherlands

Junior Premiums: \$50, 35, 25

Junior Award presented by High Creek Genetics, Larry Sommers, Arlington, MN

2607 RNR Nello Jenn-Twin 01-10	305 18,131 4.5% 822 365 23,068 4.7% 1,085	07/19/2020	S-Pleischs Nelgor Nello D-RNR Glenncore Jean-ET	Blessing Farms and Garrison Bros. Fort Wayne IN
2608 Hilltop Acres R Willa-ETV 01-03	305 17,385 4.2% 732 312 17,730 4.2% 748	07/04/2020	S-Jo-Dee Royal Hill Rasta-ET D-Top Acres Durham Wintu-ET	Ken Main and Kenny Joe Manion Copake NY
2609 Brook Hollow Total Hoopla ET		07/01/2020 B&O	S-Sunnyisle Total-ET D-Brook Hollow JP Honolulu-ET	Delbert & Heather Yoder West Salem OH
2610 Oak Knoll Riot 02-02	305 14,724 4.3% 640	06/20/2020 B&O	S-Kar-Linn Reeses Rampage D-Oak Knoll Tickled Pink	Joseph Rule Dodgeville WI
*2611 Twincounty Famous Diamond		06/18/2020 B&O	S-Brown Heaven R Famous-ET D-Hell Hollow Bosephus Denali	Dakota J Fraley Muncy PA
2612 V B Bank It Zest		06/18/2020 B&O	S-La Rainbow Bfly Bank It D-V B Richard Zolo Twin	Voegeli Farm Inc. Monticello WI
2613 Topp B-3 Woodford 02-10	72 6,296 4.6% 291	06/15/2020 B&O	S-Voelkers TD Carter D-Brothers Three TV Willa-ET	Topp-View & Brothers Three Watertown WI
*2614 Summerwynd Flash Je Taime 01-11	305 20,934 4.2% 880 340 23,206 4.2% 985	06/09/2020 B&O	S-Lentreeroche Biver Flash D-Summerwynd Jane Doe	Tyler Schroepfer Biramwood WI

*2615	Bo Shona Dobby Hermione					06/06/2020	S-Switzer Tals Drdvl Dobby-ET	Amelia Somers	
	01-11	305	18,086	4.3%	784	3.9%P	702P	D-Bo Shona Dyna Unikitty	Copake NY
		365	22,677	4.4%	992	3.9%P	893P		
2616	Hills Valley LT Woody Darling					06/03/2020	B&O S-Cutting Edge Woody-ETV	Hills Valley Farm and Lynn Telaak	
	01-11	287	18,196	4.3%	797	3.7%P	666P	D-Cutting Edge D Daria	Cattaraugus NY
*2617	Johann Charming					05/10/2020	S-Hilltop Acres CP Martini-ET	Ryland, Brayton & Camdyn Nierman	
	02-07	189	14,113	3.9%	556	3.3%P	463P	D-Johann Carter Dartmouth	Brownstown IN
2618	Twinkle-Hill Dyn Dippy 1458					05/09/2020	S-La Rainbow Bfly Dynamite-ETV	Ron & Nicolle Wussow	
	01-10	301	22,381	4.3%	958	3.4%P	764P	D-Twinkle-Hill AG Dianca 1326	Cecil WI
*2619	ABS Woody Skyla					04/17/2020	B&O S-Cutting Edge Woody-ETV	Alexis Blankenberg	
	03-01	77	6,231	4.0%	252	3.2%P	198P	D-Alexis Sunshine Suniejaguar	Platteville WI
2620	Twinkle-Hill D Sundial 1450					04/12/2020	S-Hilltop Acres CD Dawson	Twinkle-Hill Farm, Garret Bishop	
	01-11	305	22,426	3.0%	676	3.2%P	720P	D-Twinkle-Hill Sundial 1276	Watertown WI
		362	26,900	3.1%	832	3.3%P	877P		
2621	Arethusa Phantom Axel					04/03/2020	S-Pit-Crew Rich Phantom-ET	Lindsay Rucks and Peter Vail	
	02-00	305	17,641	4.3%	753	3.2%P	556P	D-Arethusa TB Anchorage	Valatie NY
2622	CIE Double W Star Noma					04/01/2020	S-Hilltop Acres Dairystar-ETV	Fairdale Farm LLC	
	02-00	268	24,050	3.7%	893	3.5%P	832P	D-IE Double W Mick Norma	Worthville KY
2623	CIE Roeen Seaman Apocalypse					03/20/2020	S-Cutting Edge Seaman	Jaynie Rule	
	02-05	298	15,096	4.2%	629	3.3%P	494P	D-IE Roeen Lebron Andie	Dodgeville WI
2624	Iroquois Acres Cliff Dreamer					03/11/2020	B&O S-Kulp-Terra Daryou Cliff-ET	Iroquois Acres	
								D-Arthurst Supreme Dream-ET	Bridport VT
2625	All-Glo Carter Pretzel					03/10/2020	B&O S-Voelkers TD Carter	Justin & Ashley Kaufman	
	02-00	305	13,425	4.2%	562	3.3%P	451P	D-Just-In Grandslam Pickles	Berlin PA
2626	Coredale Daredevil Papaya-ET					03/09/2020	B&O S-Hilltop Acres B Daredevil-ET	Amanda (Thompson) Stewart	
								D-Coredale Whiskey Peaches	Dover PA
2627	V B Can-Due Wonder					03/08/2020	B&O S-Kulp-Terra Hilton Can-Due-ET	Voegeli Farm Inc.	
	02-02	302	20,353	4.4%	888	3.6%P	739P	D-Hills Valley Cadenc Wicked-ET	Monticello WI
*2628	Colebrook Creek Dt Alina					03/07/2020	B&O S-La Rainbow Bfly Dynamite-ETV	Abigail Wilber	
								D-Colebrook Creek Wf Allis	New Hartford CT
2629	Cher-Mi Richard Vonn					03/06/2020	S-Jo-Dee Nemo Richard-ET	Donald Graft & Family	
	02-00	305	19,267	3.8%	740	3.4%P	655P	D-Cher-Mi Pays Vaud	Wapakoneta OH
*2630	AM Acres Monlight Amber-OCS					03/05/2020	B&O S-La Rainbow B Moonlight-ET	Carmen & Ella Parish	
	03-01	113	11,637	3.4%	396	3.1%P	360P	D-AM Acres Cadence Alexis	Linden WI
2631	Oak Knoll Rosemary					03/05/2020	B&O S-Brown Heaven R Famous ET	Jaynie Rule	
	03-03	37	2,386	3.6%	87	3.4%P	82P	D-Oak Knoll Rosebud	Dodgeville WI
2632	A Joy C Snowday					03/03/2020	B&O S-Voelkers TD Carter	Blake Spatola	
	02-00	305	16,515	4.1%	697	3.2%P	530P	D-Kuhlkows R Snowbank	Little Meadows PA
		341	18,549	4.1%	765	3.2%P	596P		

2633 Fairholm Norwin Kenzee	03/03/2020	B&O	S-Norwin D-Sun-Maid Richard Kesha-ET	Fairholm, Josh & Samantha Fairbanks Anamosa IA
*2634 Meadow Hill Betty Jo	03/03/2020		S-Brown Heaven R Famous-ET D-Meadow Hill Dorito Bobby Jo	Theo Goldenberg Mcgregor TX
2635 A Joy CP Snow White	03/01/2020	B&O	S-R Hart Cayenne Pepper D-A Joy Rich Snowberry	Abbie Evans Little Meadows PA
02-03 305 17,805 4.1% 733 3.2%P 563P				
2636 Brown Heaven Genox Jeaverissa	03/01/2020	B&O	S-Studer's BS Glen Genox-Boy D-Brown Heaven T Jeaverissa ET	Brown Heaven Vercheres QC
02-00 305 22,007 4.3% 941 3.6%P 789P				
2637 Hills Valley Carter Viola	03/01/2020		S-Voelkers TD Carter D-Hills Valley Brutus Vicky	Ken Main and Kenny Joe Manion Copake NY
02-01 305 21,410 3.6% 775 3.4%P 718P				
308 21,521 3.6% 780 3.4%P 722P				
*2638 Topp-View Glenwood Fantastic	03/01/2020	B&O	S-Kalingen Calvin Glenwood-ET D-Topp-View Lee Fame	Madelyn Topp Wapakoneta OH
02-03 285 2,208 4.5% 942 3.4%P 797P				
<b>Class 333 Senior Three-Year-Old Cow</b>				
Born 09/01/2019 - 02/29/2020				
Premiums: \$150, 140, 130, 120, 110, 100, 90, 80, 70, 60, 50, 45				
1st Place Award presented by Brown Heaven Farm, Vercheres, QC, Canada				
Bred & Owned Award presented by Sisters Three Dairy, Stanley, NY				
Production Rosette presented by Case IH, Racine, WI				
Best Udder Rosette presented by Holstein International and Cattle Connection, Stiens, The Netherlands				
Junior Premiums: \$50, 35, 25				
Junior Award presented by Pinnacle Swiss, Caro, MI				
2639 Double W Kade Tutti	02/29/2020	B&O	S-Double W Kade-P D-Double W Kannon Tulip	Double W Dairy Farm Holyoke CO
2640 Pit-Crew Formula Nicky	12/26/2019	B&O	S-Brown Heaven Winningformula-ET D-Pit-Crew Daredevil Noelle	Pit-Crew Genetics Cambridge MN
02-02 305 19,314 3.5% 668 3.3%P 628P				
365 23,091 3.5% 818 3.4%P 775P				
2641 Brook Hollow Christmas Present	12/25/2019	B&O	S-Voelkers TD Carter D-Brook Hollow Baby Present	Delbert & Heather Yoder and Mark Binverse West Salem OH
02-06 305 25,620 3.3% 845 3.2%P 820P				
365 30,660 3.3% 1,012 3.2%P 981P				
2642 Double W FF Tootsie	12/24/2019	B&O	S-Brown Heaven R Fast&furious-ET D-Double W Wunder Tobie	Jill & Brad Kinney and Double W Farm Dairy Durand IL
03-05 67 6,846 3.4% 252 2.8%P 195P				
*2643 Pit-Crew Formula Tawny	12/08/2019	B&O	S-Brown Heaven Winningformula-ET D-Cozy Valley WD Tumbler-ET	L: Abby Foss O: Pit-Crew Genetics Cambridge MN
02-02 305 14,225 4.7% 661 3.3%P 473P				
365 16,842 4.7% 791 3.4%P 573P				
*2644 Terra Rose Cliff Shasta	12/04/2019		S-Kulp-Terra Daryou Cliff-ET D-Terra Rose Sup Sasha ET	Adele Biasini Morrisville, VT
03-09 216 17,017 5.2% 885 3.0%P 510P				
2645 CIE Double W Kickstart Winsome	12/03/2019		S-Hilltop Acres D Kickstart-ET D-IE Double W Carl Whichway	Ken Main, Kenny Manion and Double W Dairy Copake NY
02-04 127 11,755 4.8% 563 4.1%P 482P				
324 23,355 4.3% 1,003 3.5%P 826P				
2646 Knapp Woody Guns N Roses	12/02/2019		S-Cutting Edge Woody-ETV D-We Sell Bose 4822	Brian Pacheco Kerman CA
03-07 7 560 4.8% 33 3.5%P 21P				

2647	Red Brae DAA Glenwood Joni	12/02/2019	B&O	S-Kalingen Calvin Glenwood-ET	David Armbruster
	02-04 305 20,496 4.2% 868 3.6%P 731P			D-Red Brae DAA Bosephus Jona	Muscoda WI
	365 24,727 4.3% 1,065 3.6%P 895P				
2648	Cutting Edge N Sheila-ETV	12/01/2019		S-Norwin	Dayne & Maecyn Voelker
	02-04 305 18,863 4.0% 754 3.5%P 652P			D-Voelkers Durango Sasha	Perryville MO
2649	Twin Hollow Daredevil Blue	12/01/2019		S-Hilltop Acres B Daredevil-ET	John & Bonnie Ayars
	02-04 305 20,910 3.9% 819 3.7%P 770P			D-Twin Hollow Narley Krebs	Mechanicsburg OH
2650	Jaden Richard Gere	10/30/2019	B&O	S-Jo-Dee Nemo Richard-ET	Hayden Hauschildt
	03-06 102 7,100 3.4% 243 3.0%P 216P			D-Jaden Durham Georgia	Ellsworth WI
*2651	Birdsallway Carter Krispy-ETV	10/11/2019	B&O	S-Voelkers TD Carter	Paige, Josie & Camden Kinnard
	03-03 150 13,950 3.8% 530 2.9%P 405P			D-Birdsallway Richard Kristal	Sturgeon Bay WI
2652	Hilltop Acres DB Whisper-ETV	10/05/2019		S-Switzer Tals Drdvl Doboy-ET	Dylan Fry
	03-05 105 8,474 4.3% 362 3.1%P 259P			D-Top Acres Durham Wintu-ET	Chestertown MD
*2653	Johann Brownsville	10/01/2019		S-La Rainbow Bfly Dynamite-ETV	Madelyn, Mackenzie & Grant Topp
	03-05 300 22,218 3.8% 836 3.7%P 824P			D-Johann Birmingham	Wapakoneta OH
*2654	Top Acres GW Wispit-ETV	09/21/2019		S-Kalingen Calvin Glenwood-ET	Rachel, Allie, Brock & Olivia Champluvier
				D-Top Acres Supreme Wisp	Wyalusing PA
2655	Top Acres Braidr Willow-ETV	09/19/2019		S-Blessing Tex Braiden-ET	Uluru Swiss Acres
	02-05 305 23,808 3.1% 748 3.0%P 722P			D-Top Acres Supreme Wizard-ET	Clermont IA
2656	Cutting Edge N Shril-ETV	09/15/2019	B&O	S-Norwin	Ken Main and Kenny Joe Manion
	02-05 116 8,631 4.2% 362 3.7%P 316P			D-Cutting Edge P Sherry	Copake NY
	329 17,688 4.2% 751 3.7%P 651P				
2657	Hilltop Acres K Buttercup	09/10/2019		S-Hilltop Acres D Kickstart-ET	Fairdale Farm LLC
	02-01 305 27,180 4.8% 1,313 3.3%P 895P			D-Hilltop Acres Dun Bluebell	Worthville KY
*2658	Brook Hollow Handiwork-ET	09/09/2019		S-Cutting Edge Woody-ETV	Lauren D L'amoreaux
				D-Brook Hollow JP Honolulu-ET	Louisville OH
2659	Kruses Moonlight Juliet-ET	09/09/2019	B&O	S-La Rainbow B Moonlight-ET	Rick Kruse
	02-03 305 15,761 4.1% 647 3.1%P 483P			D-Kruses Victor Jiterbug-ET	Earlville IA
	365 18,414 4.2% 771 3.2%P 582P				
2660	Cutting Edge BG DS Sharice	09/05/2019		S-Hilltop Acres Dairystar-ETV	Blessing Farms and Garrison Bros.
	02-03 305 21,201 4.3% 905 3.5%P 746P			D-Top Acres W Shasta	Fort Wayne IN
	365 24,563 4.2% 1,039 3.6%P 872P				
2661	Kruses LJ Famous Nan	09/05/2019	B&O	S-Brown Heaven R Famous-ET	Loras Kruse
	02-03 296 16,970 4.5% 758 3.3%P 560P			D-CIE Kruses LJ Stuart Nikki	Holy Cross IA
2662	V B HP Kickstart Top Tier	09/04/2019	B&O	S-Hilltop Acres D Kickstart-ET	Voegeli Farm Inc.
	02-00 305 20,293 4.6% 928 3.5%P 710P			D-V B HP Norwin Teanna-ET	Monticello WI
	365 24,184 4.6% 1,100 3.6%P 858P				
2663	Just So D Fortune-ET	09/02/2019	B&O	S-Hilltop Acres B Daredevil-ET	Just So Farm
	01-10 305 17,203 4.8% 830 3.7%P 637P			D-Cutting Edge WF Fargo	Lake Mills WI
	365 20,138 4.8% 991 3.7%P 753P				



2664 Hills Valley Carter Flirty-ET	09/01/2019	S-Voelkers TD Carter	Peter Vail
02-06 305 20,924 4.0% 830 3.2%P 660P		D-Round Hill Braiden Fenny	Englewood FL
*2665 Just So D Tangle	09/01/2019	S-La Rainbow Bfly Dynamite-ETV	Zackery A Schraufnagel
		D-Kupl-Gen Anibal Tawny-ET	Brownsville WI
*2666 Red Brae Thunder Shimmer-ET	09/01/2019 B&O	S-Cutting Edge Thunder	Elise Bleck
01-11 305 15,631 5.0% 777 3.8%P 594P		D-Red Brae La Jongleur Showy	Muscoda WI
353 17,736 5.0% 887 3.8%P 678P			
*2667 Red Brae Thunder Shine-ET	09/01/2019 B&O	S-Cutting Edge Thunder	Elise Bleck
02-03 305 14,952 4.9% 726 3.6%P 531P		D-Red Brae La Jongleur Showy	Muscoda WI
365 17,342 5.0% 868 3.6%P 629P			
<b>Class 334 Intermediate Champion Female of the Junior Show</b>			
Award presented in memory of Jim Armbruster by Dave Badula, Cassville, WI			
Champion Banner presented by St. Jacobs ABC, DeForest, WI			
Rosette presented by Doug & Linda Hodorff, Eden, WI			
\$300 from Brierwood of Hillsdale, IL presented in memory of Ron and Sally Paaske			
<b>Class 335 Reserve Intermediate Champion Female of the Junior Show</b>			
Award presented by Maryland Brown Swiss Association			
Reserve Champion Banner and Rosette presented by St. Jacobs ABC, DeForest, WI			
<b>Class 336 Intermediate Champion Female</b>			
Eugene Nelson Intermediate Champion Award presented by Dairy Agenda Today, Basehor, KS			
Champion Banner presented by Semex/Boviteq, Madison, WI			
Rosette presented by GenOvations, Lodi, WI			
<b>Class 337 Reserve Intermediate Champion Female</b>			
Award presented by Muffets Twin Acre, Jacob & Elizabeth Roedl, Edgewood, IL			
Reserve Champion Banner presented by Semex/Boviteq, Madison, WI			
Rosette presented by Phibro Animal Health Corp., Quincy, IL			
<b>Class 338 Four-Year-Old Cow</b>			
Born 09/01/2018 - 08/31/2019			
Premiums: \$150, 140, 130, 120, 110, 100, 90, 80, 70, 60, 50, 45, 40, 40			
1st Place Award presented by Blessing Farms, Steve & Stan Blessing and Families, Fort Wayne, IN			
Bred & Owned Award presented by Jennings Gap Dairy, LLC, the Swope Family, Churchville, VA			
Production Rosette presented by Case IH, Racine, WI			
Best Udder Rosette presented by Holstein International and Cattle Connection, Stiens, The Netherlands			
Junior Premiums: \$50, 35, 25			
Junior Award presented by Twinkle-Hill Farm, the Winkelman Family, Watertown, WI			
2668 Just So D Frisky	07/10/2019 B&O	S-La Rainbow Bfly Dynamite-ETV	Just So Farm
02-10 305 20,504 4.6% 946 3.5%P 726P		D-Cutting Edge Wf Fargo	Lake Mills WI
330 21,699 4.6% 1,014 3.5%P 772P			
*2669 Royal Hill Rich Nori	07/06/2019	S-Jo-Dee Nemo Richard-ET	Brayton, Ryland & Camdyn Nierman
03-04 209 16,237 3.8% 615 3.1%P 505P		D-Sun-Made Elite Noreen-ET	Brownstown IN
2670 Top Acres Cade Whiffle-ETV	06/04/2019	S-Shiloh Brookings Cadence-ET	Dylan Fry
		D-Top Acres Supreme Wisp	Chestertown MD
2671 Lauterbach C Perception	06/03/2019 B&O	S-Voelkers TD Carter	Korey and Torie Oechsle
03-03 305 22,172 4.5% 1,010 3.1%P 702P		D-Buckeye Knoll Jobo Pickle	Delavan WI

2672 Red Brae Ej Easton Breezy	05/06/2019	B&O	S-Nor Bella Biver Easton	Eric Armbruster
02-07 305 19,827 4.2% 846 3.8%P 708P			D-Red Brae Ej Cayenne Bretina	Muscoda WI
365 23,207 4.4% 1,022 3.6%P 845P				
2673 Browns Ladys Lilac	04/23/2019		S-Double W Finnigan	Peter Vail
03-01 282 16,486 3.9% 635 3.3%P 545P			D-Mort Java Luckey Lady	Englewood FL
2674 Hilltop Acres Dynmt Daphnie-ET	04/13/2019		S-La Rainbow Bfly Dynamite-ETV	Fairdale Farm LLC
03-00 305 25,354 4.3% 1,086 3.4%P 871P			D-Hilltop Acres Gln Dignity-ET	Worthville KY
*2675 Blessing CNJ T Norann-ET	04/01/2019	B&O	S-Cutting Edge Thunder	Caylee Nicole James
03-02 305 24,545 4.0% 988 3.4%P 843P			D-Jo-Dee Vision Noel-ET	Wolcottville IN
365 28,529 4.1% 1,160 3.5%P 1,000P				
*2676 Open-Road Astar Whoopiepie	03/30/2019		S-Twinkle-Hill Cadnc Allstar	Amy Hughes
03-11 162 11,203 4.1% 386 3.5%P 336P			D-Top Acres Braiden Winzit-ET	Durand IL
2677 Miley Bosephus Princess	03/25/2019		S-Jobo Wonder Bosephus-ET	Blessing Farms and Garrison Bros.
02-04 305 16,960 4.8% 809 3.6%P 605P			D-Miley Win Fomula Paisley	Fort Wayne IN
*2678 Kruses Gk Phantom Jambore	03/13/2019		S-V B Biver Phantom-ET	Wesley Winch
03-07 280 27,345 4.6% 1,258 3.3%P 905P			D-Kruses Gk Walker Jill	Fennimore WI
2679 Kruses Woody Jill	03/08/2019	B&O	S-Cutting Edge Woody-ETV	Rick Kruse
03-03 303 17,856 4.2% 758 3.3%P 585P			D-Kruses Carter Jillian-ET	Earlville IA
*2680 Kruses LJ Fab Skylar-ET	03/06/2019		S-Brown Heaven J Fabulous-ET	Carter Kruse
			D-Kruses Lj Vic Starstruck-ET	Dyersville IA
2681 Brown Heaven F & F Sea Dally	03/03/2019	B&O	S-Brown Heaven R Fast&furious-ET	Brown Heaven
02-11 305 25,146 4.8% 1,217 3.6%P 904P			D-Brown Heaven Jet Speedy Dally	Vercheres QC
*2682 Cutting Edge W Famous-ETV	03/01/2019		S-Cutting Edge Woody-ETV	Emmett Smithling
			D-Cie Double W Em Favor	Stanley NY
2683 Brown Heaven Carter Falby	01/13/2019	B&O	S-Voelkers TD Carter	Milk Source and Brown Heaven
03-03 305 24,616 3.6% 886 3.1%P 763P			D-Brown Heaven Glenn Fantasy	Kaukauna WI
*2684 Topp-View Jongleur Angel	12/28/2018	B&O	S-Jolahofs Polo Jongleur-ET	Madelyn Topp
02-08 301 23,213 3.8% 829 3.2%P 761P			D-R Hart Formula Amaze	Wapakoneta OH
2685 Cutting Edge Thundr Fancy-ETV	12/20/2018		S-Cutting Edge Thunder	Amelia & Kasen Landkammer
03-05 305 25,030 4.2% 600 3.7%P 620P			D-Cie Double W Em Favor	Burtrum MN
438 27,850 6.4% 900 4.1%P 933P				
*2686 Twinkle Hill All Spiri	12/18/2018		S-Twinkle-Hill Cadnc Allstar	Carter Kruse
			D-Twinkle Hill V Spliced 1131	Dyersville IA
2687 Buschs Famous Jenna	12/15/2018		S-Brown Heaven R Fast&furious-ET	Peter Vail
03-04 305 22,455 3.8% 861 3.1%P 695P			D-Buschs Stuart Jolie	Englewood FL
2688 Ritchi View Nuck Hum Dinger	10/02/2018		S-Ritche View Knucklehead	Ken Main, Kenny Joe Manion and Allan Brisson
03-08 305 21,037 4.4% 928 3.7%P 769P			D-Ritche View Bel Carter Ella	Copake NY
365 24,811 4.6% 1,130 3.7%P 924P				
2689 Robland Norwin Bermuda-ET	09/29/2018		S-Norwin	Goldfawn Farm and Tony Kohls
			D-Robland Brookings Brownie-26	Mcgregor TX

2690	Oak Knoll SS Heatwave	09/25/2018	B&O	S-La Rainbow Bfly Dynamite-ETV	Joseph Rule
	04-08 67 5,632 3.9% 220 3.1%P 174P			D-Oak Knoll SS Chill ET	Dodgeville WI
2691	Jenlar Carter Whiplash-ETV	09/17/2018		S-Voelkers TD Carter	Hill's Valley Farm, LLC
	03-08 305 29,357 4.4% 1,285 3.2%P 932P			D-Top Acres Garbro S Wish-ET	Cattaraugus NY
*2692	Double W Lam Nina	09/05/2018		S-Twinkle-Hill Sblamborghini	Landen Knapp
				D-Double W Finn Notary	Epworth IA
2693	Round Hill Mbf Wednesday-ET	09/05/2018		S-Blessing Tex Braiden-ET	Michael Nelson
				D-Top Acres Garbro Wanda	Lewiston MN
2694	Voelkers Bush Aggie-ETV	09/01/2018	B&O	S-Jobo Vigor Bush-ET	Grant Voelker
	03-06 305 23,899 4.1% 977 3.4%P 801P			D-Voelkers Parde Addison	Perryville MO
<b>Class 339 Five-Year-Old Cow</b>					
Born 09/01/2017 - 08/31/2018					
Premiums: \$150, 140, 130, 120, 110, 100, 90, 80, 70, 60					
1st Place Award presented by Royal Hill Swiss, Don Graft, Fort Wayne, IN					
Bred & Owned Award presented by Sisters Three Dairy, Stanley, NY					
Production Rosette presented by Case IH, Racine, WI					
Best Udder Rosette presented by Holstein International and Cattle Connection, Stiens, The Netherlands					
Junior Premiums: \$50, 35, 25					
Junior Award presented by Encore Genetics, Fennimore, WI					
*2695	KE Danielle Tip Up Dice	08/07/2018	B&O	S-Holyland Tip Up-ET	Kiele Eberling
				D-KE Daisy Kannon Danielle Twin	Postville IA
2696	Cutting Edge F Diamond	06/26/2018	B&O	S-Cutting Edge T Foremost	Ken Main and Kenny Joe Manion
	03-08 305 25,659 3.7% 954 3.4%P 867P			D-Cutting Edge K Derby Twin	Copake NY
	364 28,248 3.8% 1,076 3.4%P 971P				
*2697	Brandenburg Richard Valerie	06/18/2018		S-Jo-Dee Nemo Richard-ET	Sawyer & Emerson Brandenburg
	05-02 305 29,552 4.0% 1,176 3.3%P 988P			D-Brandenburg Tanbark Vegas	Fort Atkinson WI
2698	Brothers Three Tv Willa-ET	06/13/2018	B&O	S-Sunnyisle Total-ET	Brothers Three Brown Swiss
	03-08 305 17,461 3.8% 663 3.2%P 556P			D-Brothers Three Wisper-OCS	North Prairie WI
	365 19,282 3.8% 746 3.2%P 625P				
2699	Brown Heaven Biver Frenchkiss	06/01/2018	B&O	S-Scherma Blooming Biver	Brown Heaven
	03-06 305 28,995 4.9% 1,418 3.9%P 1,118P			D-Brown Heaven Manchest Freckle	Vercheres QC
2700	Red Brae Spa Protege Dalida	05/14/2018	B&O	S-Pit-Crew Pepper Protege	Steven Armbruster
	03-07 305 21,580 4.3% 919 3.6%P 761P			D-Red Brae Spa Jongleur Dalia	Muscoda WI
	365 23,861 4.3% 1,032 3.6%P 855P				
2701	Daveco Sea Foam	05/08/2018	B&O	S-Cutting Edge Seaman	Jillian & Taylor Bonow
	04-00 303 26,020 3.5% 918 3.5%P 918P			D-Daveco Nemo Furby	Lewiston MN
2702	North Lanes Bos Patience	05/01/2018	B&O	S-Jobo Wonder Bosephus-ET	Chelsea Skidmore
				D-North Lanes Ag Paisley-ET	Union City OH
2703	CIE Cedar Acres Lucky Jenni	04/10/2018	B&O	S-Cedar Acres Tony Lucky	Mya Schraufnagel
				D-IE Cedar Acres Tinkerbelle	Brownsville WI

*2704	Johann Carter Dartmouth	04/08/2018	S-Voelkers TD Carter	Brayton, Ryland & Camdyn Nierman
	04-03	264 24,002 4.1% 976 4.0%P 969P	D-Johann Georgiann	Brownstown IN
		344 30,215 4.1% 1,233 4.1%P 1,225P		
2705	Cutting Edge D Tyra-ET	03/27/2018	S-La Rainbow Bfly Dynamite-ETV	Blessing Farms and Garrison Bros.
	02-05	305 22,235 4.0% 892 3.8%P 795P	D-Dublin-Hills Treats	Fort Wayne IN
		365 34,334 4.1% 1,395 3.3%P 1,135P		
2706	WF Cayenne Nicole-ET	03/24/2018	S-R Hart Cayenne Pepper	Fairdale Farm LLC
	03-01	305 33,272 4.1% 1,357 3.2%P 1,078P	D-Jo-Dee Denmark Nookie-ET	Worthville KY
2707	Pit-Crew Formula Tricks	03/16/2018 B&O	S-Brown Heaven Winningformula-ET	Pit-Crew Genetics
	03-11	305 25,298 3.6% 907 3.4%P 852P	D-Pit-Crew Richard Trix	Cambridge MN
		365 30,196 3.6% 1,091 3.4%P 1,035P		
2708	Brown Heaven Bigstar Florence	03/02/2018	S-Zumbuhl's Big Star	Fred Mathy and Donna Harp
			D-Lentreroche Vigor Flower	Brandon MB
2709	Double W Rich Rainbow	02/15/2018	S-Jo-Dee Nemo Richard-ET	Knapp Guernseys
			D-Cie Double W Cadence Rachel	Epworth IA
2710	Horseshoe Hill Nu Claira	02/11/2018	S-Cutting Edge Thunder	Milk Source Genetics
			D-Horseshoe Hill Nu Clarissa	Kaukauna WI
2711	Red Brae Ej Allstar Bertha	01/06/2018 B&O	S-Twinkle-Hill Cadnc Allstar	Eric Armbruster
	03-05	305 19,831 4.5% 885 3.4%P 677P	D-Red Brae Ej Brewski Berti-OCS	Muscoda WI
		365 20,913 4.5% 935 3.4%P 720P		
2712	A Joy T Snowfall	12/23/2017	S-Cutting Edge Thunder	Peter Vail
	04-03	305 20,370 5.3% 1,075 3.3%P 681P	D-Kuhlkows Braid Snowcone	Englewood FL
2713	Siegerts Damian Pinapple	12/14/2017	S-Hilltop Acres Bk Damian-ET	Leslie & Linda Bruchey
	04-06	258 19,529 4.5% 976 3.7%P 708P	D-Precious B Priceless	Westminster MD
2714	New View C Bravo	12/05/2017	S-Voelkers TD Carter	John & Bonnie Ayars
	03-07	305 26,113 4.0% 1,031 3.6%P 935P	D-Cutting Edge Titanium Branch	Mechanicsburg OH
2715	Gibraltar Liberate Taylor	11/12/2017	S-BMG Biver Liberate	Melinda Waddell, Joseph Rule and Jessica Whitaker
	05-03	151 15,848 3.8% 604 3.1%P 497P	D-Gibraltar Dupont Trouble	Dodgeville WI
2716	Double W Lam Estera-OCS	10/29/2017	S-Twinkle-Hill Sblamborghini	Jill & Brad Kinney
	05-07	67 6,979 3.3% 249 2.8%P 199P	D-Double W Richard Elsa	Durand IL
2717	WF Biver Northernlights-ET	10/29/2017 B&O	S-Scherma Blooming Biver	Woodwind Farm
	04-02	305 26,290 4.8% 1,220 3.7%P 947P	D-Jodee Denmark Nookie	Independence WI
		354 30,282 4.8% 1,481 3.7%P 114P		
2718	Cutting Edge F Faroh-ETV	10/10/2017	S-Cutting Edge T Foremost	Ken Main and Kenny Joe Manion
	02-04	305 19,925 4.0% 787 3.6%P 719P	D-Cie Double W Em Favor	Copake NY
		365 23,025 4.1% 940 3.7%P 848P		

## Class 340 Aged Cow, Six-Year-Old &amp; Over Cow

Born before 09/01/2017

Premiums: \$150, 140, 130, 120, 110, 100, 90, 80, 70, 60

1st Place Award presented by Royal Hill Swiss, Don Graft, Fort Wayne, IN

Bred &amp; Owned Award presented by Iowa Brown Swiss Association

Production Rosette presented by Case IH, Racine, WI

Best Udder Rosette presented by Holstein International and Cattle Connection, Stiens, The Netherlands

Junior Premiums: \$50, 35, 25

Junior Award presented by Pinnacle Swiss, Caro, MI

2719	Top Acres W Shasta		07/24/2017		S-Top Acres Wizdom	Blessing Farms and Garrison Bros.
	04-01	305 29,219	4.1%	1,202	3.3%P 964P	D-Shen-Val Supreme Satin-ET
		365 34,334	4.1%	1,395	3.3%P 1,135P	Fort Wayne IN
*2720	Iroquois Acres Total Candy		07/17/2017		S-Sunnyisle Total-ET	Brian Pacheco
	05-09	86 9,773	3.2%	284	3.0%P 278P	D-Iroquois Acres Jong Cali
						Kerman CA
*2721	Groves View Pepper Tess		06/14/2017		S-R Hart Cayenne Pepper	Carter Kruse
					D-Groves-Sun Tanbark Twink-ET	Dyersville IA
*2722	Jenlar Davnpt Turtle Sundae		06/07/2017	B&O	S-Hilltop Acres CT Davenport-ET	Brianna & Austin Meyer
	04-02	305 27,275	4.1%	1,123	3.2%P 884P	D-Jenlar C Pepper Tillie
		365 30,801	4.1%	1,250	3.2%P 999P	Chilton WI
*2723	Kruses Carter Karmel		04/13/2017		S-Voelkers TD Carter	Cooper Denman
					D-Kruses Joey Kitten-ET	Bridgeport TX
*2724	Northkill Creek Groovy		03/16/2017	B&O	S-Harts Thunder	Hannah & Mark Balthaser
	05-02	305 29,697	4.0%	1,175	3.3%P 977P	D-Northkill Creek Gold
						Bernville PA
2725	Graystone Osborn Total Gibson		03/11/2017		S-Sunnyisle Total-ET	Dylan Fry
					D-Graystone Blue Chip Gracie	Chestertown MD
2726	Pit-Crew Durham Tuscany		03/03/2017	B&O	S-Hilltop Acres W Durham-ET	Pit-Crew Genetics
	05-04	305 20,246	4.1%	829	3.9%P 786P	D-Pit-Crew Supreme Torino-ET
		345 22,434	4.1%	926	3.9%P 872P	Cambridge MN
*2727	Shadow Valley Bos Tilly		03/02/2017	B&O	S-Jobo Wonder Bosephus-ET	Amelia Somers
					D-Cutting Edge HP B Trina-ET	Walton NY
2728	IE Cozy Nook Voelkers Sb Ivy		03/01/2017		S-Lime Rock Seaside Bloom	Dayne Voelker
	04-03	304 21,651	4.3%	922	3.2%P 690P	D-IDR Cozy Nook Dirk Ingrid
						Perryville MO
2729	Beu Dell Thunder Jemma		12/01/2016		S-Cutting Edge Thunder	Fairdale Farm LLC
	04-04	305 29,646	4.2%	1,246	3.4%P 1,014P	D-Beu Dell Robbie Jazzy
						Worthville KY
*2730	Fosters Dot		11/14/2016		S-Blessing Braiden Walton	Brayton, Ryland & Camdyn Nierman
	05-06	303 31,160	4.4%	1,368	3.5%P 1,076P	D-Fosters Wit Ditto
						Brownstown IN
2731	GF Thunder Aruba Aloha		09/28/2016		S-Harts Thunder	Stephanie Miller
	06-10	112 11,888	3.0%	355	2.9%P 343P	D-Timberline Td Aruba
		306 16,562	3.8%	625	3.7%P 608P	Walnut Grove MO
2732	A Joy C Nissan		09/15/2016	B&O	S-Voelkers Td Carter	Andrew & Abbie Evans
	04-09	305 24,617	4.2%	1,044	3.2%P 782P	D-A Joy Braid Neon
		365 29,332	4.4%	1,292	3.2%P 942P	Little Meadows PA

2733	Cutting Edge H Snap-ETV-OCS	09/03/2016	S-Harts Thunder	Caleb Heck
	05-01 305 29,382 4.2% 1,228 3.3%P 972P		D-Sdf Zz Snafu-ET-OCS	Freeport IL
	365 36,309 4.3% 1,548 3.4%P 1,218P			
*2734	Johann Jongleur Amaze	09/01/2016	S-Jolahofs Polo Jongleur-ET	Madelyn Topp
	05-03 288 25,896 4.2% 1,116 3.8%P 999P		D-Johann Adrift	Wapakoneta OH
2735	Get-R-Done Kingpen Galaxy	03/11/2016	S-Jo-Dee Trooper Kingpin	Steve Wagner
	06-09 242 22,902 4.0% 913 3.3%P 762P		D-Get-R-Done Braiden Gigi	Gray ME
*2736	Iroquois Acres Jong Cali	06/03/2015	S-Jolahofs Polo Jongleur-ET	Brian Pacheco
	07-10 101 24,641 3.1% 743 3.3%P 758P		D-Iroquois Acres Terror Carly	Kerman CA
*2737	SS Debs 929	12/14/2014	S-Ss Debs Show	Landen Knapp
			D-Ss Debs 51	Epworth IA
*2738	SCF PK JP Talley	03/05/2014	S-Morrell SCF JV Pepper	Jaelyn Jobe
			D-Scf Pk Secret Trinket	Bridgeport TX
2739	R & S Type-Wise Venus	09/02/2012 B&O	S-Timber Sun Impact-ET	Kevin Eggink and Stan Hayes
	06-07 305 22,770 3.9% 897 3.4%P 774P		D-Elm Park Vurchoo	Glenwood City WI
<b>Class 341 Component Merit Cow</b>				
Born before 08/31/2018				
Lifetime production of at least 8,500 lbs. combined fat & protein, be shown in milking form and be in her third or higher lactation. Record must be met by July 1 of current show year. Official test must be provided.				
Premiums: \$150, 140, 130, 120, 110				
1st Place Award presented by Voelker Swiss Farm LLC, the Voelker Family, Perryville, MO				
Bred & Owned Award presented by Hills Valley Farm, Cattaraugus, NY				
Production Rosette presented by Case IH, Racine, WI				
Best Udder Rosette presented by Holstein International and Cattle Connection, Stiens, The Netherlands				
Junior Premiums: \$50, 35				
Junior Award presented by KADR Farms, Hagerstown, IN				
2740	Double W Cadence Dotti	05/07/2017 B&O	S-Shiloh Brookings Cadence-ET	Double W Dairy Farm
			D-Double W Bush Deva	Holyoke CO
*2741	Dutch-Marie Dundee Allie	01/24/2017	S-Hilltop Acres H Dundee-ET	Hadleigh, Ezra & Kenna Jones and Kelly Jo Manion
	04-04 305 39,153 4.1% 1,603 3.5%P 1,351P		D-Dutch-Marie Kaleb 2164	Edmonton KY
*2742	Red Brae Spa Cayenne Neola	12/02/2016 B&O	S-R Hart Cayenne Pepper	Calli & Wyatt Storms
	04-08 305 28,808 4.3% 1,234 3.6%P 1,033P		D-Red Brae Spa Cd Neona	Muscoda WI
	365 32,187 4.2% 1,354 3.6%P 1,159P			
2743	Groves-Sun Jonglr Teacup-ET	12/01/2015	S-Jolahofs Polo Jongleur-ET	Beth Nelson and Aaron Johnson
	05-06 305 28,972 4.1% 1,187 3.3%P 934P		D-Groves View Agenda Tina-ET	Ettrick WI
	365 33,090 4.1% 1,369 3.3%P 1,083P			
2744	IE Twinkle-Hill Bush Jengas	05/22/2015 B&O	S-Jobo Vigor Bush-ET	Twinkle-Hill Farm
	06-00 305 32,490 4.6% 1,498 3.6%P 1,175P		D-IDR Twinkle-Hill Emerg Jenga	Watertown WI
	365 39,011 4.6% 1,814 3.7%P 1,427P			
2745	Cutting Edge Thunder Faye	09/01/2013	S-Cutting Edge Thunder	Ken Main and Kenny Joe Manion
	08-09 305 28,877 4.9% 1,409 3.6%P 1,039P		D-Cutting Edge Elite Fayann	Copake NY
	365 33,300 4.8% 1,596 3.6%P 1,205P			

\*2746 Mase's Manor Grandslam Love                      03/15/2013 B&O S-Top Acres Grandslam-ET                      Makenna F. Mase  
D-Mase's Manor Adml Lover Girl                      Cochranon PA

Class **342 Best Three Females**

Group to consist of any three females. At least one must have freshened, the other two any age, all bred by exhibitor, and at least one owned by exhibitor. Partnership bred animals, outside the family, may not be included in this class. Each exhibitor is limited to one entry.

Premiums: \$100, 85, 70, 60, 45

Norman E. & Marion Magnussen Memorial Best Three Females Award courtesy of Norman E. Magnussen Family, Lake Mills, WI

- 2747 Andrew & Abbie Evans  
Little Meadows PA
- 2748 Armbruster Bros Farms Inc  
Muscodia WI
- 2749 Blessing Farms  
Fort Wayne IN
- 2750 Blessing Farms and Garrison Bros.  
Fort Wayne IN
- 2751 Brianna, Austin, & Abby Meyer  
Chilton WI
- 2752 Brown Heaven  
Vercheres QC
- 2753 Delbert & Heather Yoder  
West Salem OH
- 2754 Hayden Hauschildt  
Ellsworth WI
- 2755 Hill's Valley Farm, LLC  
Cattaraugus NY
- 2756 Iroquois Acres  
Bridport VT
- 2757 Just So Farm  
Lake Mills WI
- 2758 Justin & Ashley Kaufman  
Berlin PA
- 2759 Ken Main and Kenny Joe Manion  
Copake NY
- 2760 Ken Main and Peter Vail  
Copake NY
- 2761 Pit-Crew Genetics  
Cambridge MN
- 2762 Rick Kruse  
Earlville IA

2763 Twinkle-Hill Farm  
Watertown WI

2764 Voegeli Farm Inc.  
Monticello WI

**Class 343 Produce of Dam**

Group to consist of two animals, any age, the produce of one cow which must be named. Animals need not both be owned by one exhibitor.

Premiums: \$75, 60, 50, 40, 30

1st Place Award presented by Royal Hill Swiss, Don Graft, Fort Wayne, IN

2765 Acclaimed Swiss  
Epworth IA

D-Kruses Victor Jiterbug-ET

2766 Armbruster Bros Farms Inc  
Muscodia WI

D-Red Brae La Jongleur Showy

2767 Brianna Meyer  
Chilton WI

D-Jenlar Carter Waltz-ETV

2768 Brianna, Austin, & Abby Meyer  
Chilton WI

D-Top Acres Garbro S Wish-ET

2769 Brown Heaven  
Vercheres QC

D-Brown Heaven Biver Frenchkiss

2770 Caylee Nicole James  
Wolcottville IN

D-Jo-Dee Vision Noel-ET

2771 Delbert & Heather Yoder  
West Salem OH

D-Brook Hollow Jp Honolulu-ET

2772 Hill's Valley Farm, LLC  
Cattaraugus NY

D-Jenlar Carter Waltz

2773 Joseph Opsal  
Blue Mounds WI

D-Opsal-J C Picture Perfect

2774 Just So Farm  
Lake Mills WI

D-Cutting Edge Wf Fargo

2775 Justin & Ashley Kaufman  
Berlin PA

D-Just-In Braiden Paradise

2776 Ken Main and Kenny Joe Manion  
Copake NY

D-Cutting Edge P Sherry

2777 Ken Main and Kenny Joe Manion  
Copake NY

D-Cie Double W Em Favor

2778 Ken Main and Kenny Joe Manion  
Copake NY

D-Top Acres Peppy Wizella

2779 Ken Main and Kenny Joe Manion  
Copake NY

D-Cutting Edge T Delilah



2780 L: Brinlee Courtney; O: Tanner Mashek Ridgeway IA	D-Hilltop Acres Sky Toyota-ETV
2781 Pit-Crew Genetics Cambridge MN	D-Pit-Crew Daredevil Kona
2782 Pit-Crew Genetics Cambridge MN	D-Pit-Crew Tanbark Koko
2783 Pit-Crew Genetics Cambridge MN	D-Pit-Crew Daredevil Noelle
2784 Rick Kruse Earlville IA	D-Kruses Victor Jiterbug-ET

**Class 344 Total Performance Winner**

1st Place Award presented by Royal Hill Swiss, Don Graft, Fort Wayne, IN

**Class 345 Holstein Marketplace Sires International Type & Production Award**

Award presented by Holstein Marketplace Sires, Brattleboro, VT

**Class 348 Senior Champion Female of the Junior Show**

Award presented in memory of Jim Armbruster by Dave Badula, Cassville, WI

Champion Banner presented by GenOvations, Lodi, WI

Rosette presented by Doug & Linda Hodorff, Eden, WI

**Class 349 Reserve Senior Champion Female of the Junior Show**

Award presented by Iroquois Acres, Bridport, VT

Reserve Champion Banner presented by GenOvations, Lodi, WI

Rosette presented by St. Jacobs ABC, DeForest, WI

**Class 350 Grand Champion Female of the Junior Show**

Lillian & Keith King and Jim King Grand Champion of the Junior Show Award presented by Kingsdale Farms, Victoria, IL

\$500 Udder Comfort Grand Champion Award presented by Udder Comfort Inc., Williamsburg, ON, Canada

Grand Champion Trophy presented by World Dairy Expo

Champion Banner presented by Select Sires, Inc., Plain City, OH

Rosette presented by Doug & Linda Hodorff, Eden, WI

The Howard Voegeli Award presented by the Family of Howard Voegeli

The Ron & Sally Paaske Award presented by the Paaske Family

**Class 351 Reserve Grand Champion Female of the Junior Show**

Award presented in memory of Jim Armbruster by Dave Badula, Cassville, WI

Lillian & Keith King and Jim King Reserve Grand Champion of the Junior Show Award presented by Kingsdale Farms, Victoria, IL

Reserve Champion Banner presented by Select Sires, Inc., Plain City, OH

Rosette presented by St. Jacobs ABC, DeForest, WI

The Howard Voegeli Award presented by the Family of Howard Voegeli

- Class **366 Senior Champion Female**  
James Crowley Sr., Senior Champion Award presented by Maryland Brown Swiss Association  
Champion Banner and Rosette presented by GenOvations, Lodi, WI
- Class **367 Reserve Senior Champion Female**  
Award presented by Kruse's Swiss Farm, Earlville, IA  
Reserve Champion Banner presented by GenOvations, Lodi, WI  
Rosette presented by Phibro Animal Health Corp., Quincy, IL
- Class **368 Grand Champion Female**  
Allen Hetts Grand Champion Trophy presented by World Dairy Expo  
\$1,000 Udder Comfort Grand Champion Award presented by Udder Comfort Inc., Williamsburg, ON, Canada  
Champion Banner presented by Select Sires, Inc., Plain City, OH  
Rosette presented by GenOvations, Lodi, WI  
Vid Vye Memorial Trophy presented by Brown Swiss Cattle Breeders Association  
Swiss Bell presented by Brown Swiss Association of Switzerland
- Class **369 Reserve Grand Champion Female**  
Award presented by Wisconsin Brown Swiss Association, Inc.  
Reserve Champion Banner presented by Select Sires, Inc., Plain City, OH  
Rosette presented by Phibro Animal Health Corp., Quincy, IL
- Class **391 Premier Breeder**  
Royal Banner presented by Agpro, Inc., Paris, TX  
Ira Inman Award - Awarded annually to the Premier Breeder at each National Brown Swiss Show. A replica of the original trophy, which is kept at the National Office, is given to each winner.
- Class **392 Premier Exhibitor**  
Royal Banner presented by Select Sires, Inc., Plain City, OH
- Class **393 Premier Sire**  
Ted Kreuger Premier Sire Royal Banner presented by Five-G Consulting, Reno, TX

## List of Exhibitors - Brown Swiss

ID	Name	Farm Name	State
4867	Abbie Evans	A Joy Swiss	PA
11871	Andrew & Abbie Evans	A Joy Swiss	PA
12970	Blake Spatola	A Joy Swiss	PA
11008	Alexis Blankenberg	Ab Swiss	WI
14090	Alexis Oakland	Aka Genetics	IA
6005	Justin & Ashley Kaufman	All-Glo Farms	PA
13643	Carmen & Ella Parish	AM Acres	WI
11946	Dylan Fry	Apex Genetics	MD
3094	Ranae Herman	Ar-Line Dairy	WI
11217	Ayars Family Farm	Ayars Family Farm	OH
11525	Sara Price	Badger Hollow Farms	WI
13358	Griffin Brown	Beslea Farms Ltd	ON
13540	Jacob Betley	Betley Farms	WI
11734	Hayleigh Geurink and Kelvin Webster	Black-Ridge	WI
12235	Blessing Garrison and L & D Fraley	Blessing Farms	IN
2007	Blessing Farms	Blessing Farms	IN
3843	Blessing Farms and Garrison Bros.	Blessing Farms	IN
13632	L: Kelsey Erf; O: Blue Mountain Genetics	Blue Mountain Genetics	MN
13382	William Sadler	Bo-Je Farms	IA
1510	Sawyer & Emerson Brandenburg	Brandenburg Dairy Farm	WI
12469	Brigeen Farms, Inc.	Brigeen Farms, Inc.	ME
1086	Delbert & Heather Yoder	Brook Hollow Farm	OH
13351	Brothers Three and Patrick Crave	Brothers Three	WI
5752	Brothers Three Brown Swiss	Brothers Three	WI
13352	Brothers Three and Shawn & Seth Nehls	Brothers Three Brown Swiss	WI
11123	Colt & Luke Buckley	Buckmeadow Farms	KY
11726	Budjon Farms	Budjon Farms	WI
3079	Dylan Reed	B-Willenborg Farms Inc.	IL
13696	Ashley Swenson	C & A Swiss	MN
13562	Zackery A Schraufnagel	Cedar Acres	WI
11001	Wyatt Clason	Clayland Acres	WI
12764	Amanda (Thompson) Stewart	Coredale Farm	PA
13112	L: Brinlee Courtney; O: Tanner Mashek	Courtlane Holsteins	IA
11989	Cripple Creek Farm	Cripple Creek Farm	NY
11576	Kelsey Erf	Curvecrest Farm	MN
13631	William Erf	Curvecrest Farm	MN
4442	Jillian & Taylor Bonow	Daveco Swiss	MN
14008	Kyle Johnson	Deeter Farms	PA
10983	Alexis Sherry	Dochaven Genetics	PA
12812	Double W Dairy Farm	Double W Farm	CO
9687	Kiele Eberling	Eberling Dairy	IA

## List of Exhibitors - Brown Swiss

ID	Name	Farm Name	State
13511	Amelia Somers	Elite Dairy 2	NY
12326	Kelly Jo Manion	Elite Dairy 2	NY
11209	Ken Main and Kenny Joe Manion	Elite Dairy 2	NY
13510	Ken Main, Kenny Joe Manion and Allan Brisson	Elite Dairy 2	NY
12355	Ken Main, Kenny Manion and Double W Dairy	Elite Dairy 2	NY
13509	L: Summer Kiernan O: Ken Main & Kenny Joe Manion	Elite Dairy 2	NY
12074	Ken Main and Peter Vail	Elite Dairy II	NY
11405	Fairdale Farm LLC	Fairdale Farm LLC	KY
9438	Josh & Samantha Fairbanks	Fairholm	IA
11476	Keenan Taylor Thygesen	Farmstead Genetics	VT
12241	Sophie J & Lexi Schaefer	First Glance	WI
12537	Brad Pierson	Flower-Brook Registered Holsteins	MN
13414	David Schultheis	Four Seasons Farm	PA
13416	Josh Fry	Four Seasons Farm	PA
12360	Sarah & Megan Hill	Four-Hills Farm	VT
13408	Payton Gibbs	Gibbs Holsteins	IA
5254	Glamourview-lager & Walton	Glamourview-lager & Walton	MD
13497	Goldfawn Farm and Tony Kohls	Goldfawn Farm	TX
13499	Theo Goldenberg	Goldfawn Farm	TX
929	Steve Wagner	Graystone	ME
13894	Riley Anderson	Hager Hill Swiss	WI
14175	Dakota Sawyer	Hazelbrush Farms	IA
13312	Meagan Hempfling	Hemsteads Holsteins LLC	OH
13368	Brody Jackson, Blake & Garrett Hill	Hill's Valley Farm, LLC	NY
6998	Hill's Valley Farm, LLC	Hill's Valley Farm, LLC	NY
1186	Dennis Mashek	Hilltop Acres Farm	IA
14083	Mary Holtz	Holtz-View Farms	IA
10594	Noah Heine	Holy-Ayr Enterprise	WI
13848	L: Caroline Anderson; O: Joyce Uglow	Horseshoe Hill	WI
13852	Nick Uglow	Horseshoe Hill	WI
2943	Nick Uglow	Horseshoehill Swiss	WI
13866	Sevanna Fairbank	In-Style Holsteins	WI
9979	Iroquois Acres	Iroquois Acres	VT
3665	Hayden Hauschildt	Jaden Swiss	WI
12413	Jennifer Clark	Jc Swiss	WI
13828	Brianna & Austin Meyer	Jenlar Holsteins & Brown Swiss	WI
13822	Brianna Meyer	Jenlar Holsteins & Brown Swiss	WI
13827	Brianna, Austin, & Abby Meyer	Jenlar Holsteins & Brown Swiss	WI
2862	Ellie G. Widerman	Jobo Farm LLC	PA
12866	Jordan Helsley	Jordan Helsley	PA
3595	Just So Farm	Just So Farm	WI

## List of Exhibitors - Brown Swiss

ID	Name	Farm Name	State
11283	Kassidy, Ashlynn, Delaney & Ryleigh Oliger	Kadr Farms	IN
12178	Carter Kruse	Kcck Genetics	IA
13786	Jeremy and Kelsey Kinslow	Kinslow Dairy	KY
4465	Jeremy Kinslow	Kinslow Dairy	KY
13791	Knapp Genetics, K Koopmann and Jim Hammerand	Knapp Genetics	IA
11225	Knapp Guernseys	Knapp Genetics	IA
10101	Landen Knapp	Knapp Genetics	IA
13871	Peter Vail	Knh Endres Farm	WI
250	Rick Kruse	Kruse's Swiss Farm	IA
9031	Nolan Kummer	Kummer Farm	PA
14098	Amelia & Kasen Landkammer	Landkammer's Legacy	MN
12138	Lauren D L'amoreaux	Laurind Swiss	OH
13803	Rachel, Allie, Brock & Olivia Champluvier	Like-Val Farm	PA
6078	Aaron Johnson	Logan Valley Farm	WI
12063	London Dairy Farms	London Dairy Farm	ON
8168	Brian Nierman	Long Lane Farm	IN
2501	Lookout	Lookout	QC
3403	M & M Swiss, Matt, Megan, Jake & Levi Stuessel	M & M Swiss	WI
10231	M & M Swiss-Jacob & Levi Stuessel	M and M Swiss	WI
12262	Maple Downs Farms II	Maple-Downs Farm	NY
8807	Maple-Leigh Futures	Maple-Leigh Futures	WI
14023	Briana Zentner	Marshview Dairy	WI
14092	Peighton Deroo	Marshview Dairy	WI
8908	Makenna F. Mase	Mase's Manor	PA
14111	Abbie Gahring	Maxx Boarding	IA
14171	Lane Domeyer	Maxx Boarding	IA
12934	Devin Mayer	Mayer Farm	WI
8340	Mitch Kappelman	Meadow Brook Farms	WI
1560	Gary Lee Mase	Meadow Hill Farm	PA
13808	Magen Busker and Josie Meier	Meier Meadows	IL
6548	Peter Vail	Mile High	FL
10222	Milk Source Genetics	Milk Source	WI
13996	O: Kaylen Miller; L: Ashlynn Schultz	Mil-K Valley	IL
13314	Amelia & Vienna Tauchen and Addison & Hailey Fischer	Milk-N-More	WI
11412	Mountain View Meadows Brown Swiss	Mountain View Meadows	WA
11901	Jill Kinney	Myline Enterprises	IL
13726	Troy Mcconnell	Nor Bella Acres Inc	ON
1548	Chelsea Skidmore	North Lane Farm	OH
12134	Hannah Balthaser	Northkill Creek	PA
14132	Jaynie Rule	Oak Knoll Farm	WI
14135	Joseph Rule	Oak Knoll Farm	WI

List of Exhibitors - Brown Swiss

ID	Name	Farm Name	State
14139	Melinda Waddell and Jessica Whitaker	Oak Knoll Farm	WI
14103	Melinda Waddell and Joseph Rule	Oak Knoll Farm	WI
14138	Melinda Waddell, Joseph Rule and Jessica Whitaker	Oak Knoll Farm	WI
13035	Daleyn Gehrig	Oaklawn Acres	OH
1326	Caleb Heck	Odysseyswiss	IL
14176	Trygve Olson	Olsons Brown Swiss Dairy	WI
9220	Joseph Opsal	Opsal's Ridge Registered Holsteins	WI
13613	Jaclyn Osinga	Override Holsteins	TX
9121	Kylie Osinga	Overside	TX
12112	Brian Pacheco	Pacheco Dairy, Inc.	CA
1713	Suton Paulson	Paule-View	IL
12213	Brianna Paye	Payacres	WI
9847	L: Abby Foss O: Pit-Crew Genetics	Pit-Crew Genetics	MN
9848	L: Allison Foss O: Pit-Crew Genetics	Pit-Crew Genetics	MN
12520	L: Beau Trapp O: Pit-Crew Genetics	Pit-Crew Genetics	MN
11475	L: Kole Trapp O: Pit-Crew Genetics	Pit-Crew Genetics	MN
1691	Pit-Crew Genetics	Pit-Crew Genetics	MN
13512	Darcy & Austin Ertmer	Primrose Brown Swiss	IL
13899	Kalley and Brielle Christen	Quad C	MN
14182	Donald Graft & Family	Quietcove Holsteins	OH
14160	R & L Read, L Olson, L & B Beckard, T Graves	Raylore Farm	MN
9372	Armbruster Bros Farms Inc	Red Brae Dairy	WI
8491	Travis Richardson	Richardson Genetics	TN
12196	Ron & Nicolle Wussow	Ronald Wussow	WI
5104	Cynthia Warner	Round Hill Acres	MD
13377	Jon & Alexis Retzlaff, Gregg Christianson, Bill Medo	R-Plaine Farm	WI
7965	Dylan & Cameron Ryan	Ryan-Vu Holsteins	WI
9259	Cooper Denman	Sandy Creek Farm	TX
9266	Jaelyn Jobe	Sandy Creek Farm	TX
12817	C, C & C Cannon and M, T & K Arnold	Sco-Lo	IA
8772	Cael, Chase & Caden Cannon	Sco-Lo	IA
12854	Amelia Somers	Shadow Valley Farm	NY
785	Philip Shanks	Shanks Farm	IL
12493	Adele Biasini	Silver Top Swiss	VT
4315	Katelyn Taylor	South Creek Acres	PA
10778	Emily & Amy Yeiser, Spots Pride Farm	Spots-Pride Farm	MD
5587	Leslie & Linda Bruchey	Stylin' Genetics	MD
11101	Tyler Schroepfer	Summerwynd	WI
11942	Alysha M Bauer	Taking Chances	WI
14173	Cade & Alice Mikkelson	Thompsview Farms	WI
5507	Donald Partridge	Thorndale Farms	NY

## List of Exhibitors - Brown Swiss

ID	Name	Farm Name	State
13300	Trinity Scott	Thorndale Farms	NY
1895	Eric Topp	Topp View	OH
12220	Rebecca Korth	Triangle Acres	IL
3966	Landree Fraley	Twin County Farms	PA
11215	Laurie Winkelman	Twinkle-Hill Farm	WI
11216	Twinkle-Hill Farm	Twinkle-Hill Farm	WI
1601	Kevin Eggink and Stan Hayes	Type-Wise Swiss	WI
13971	Hailey M Kinney	Udder Confusion Dairy Farm	IL
12311	Uluru Swiss Acres	Uluru Swiss Acres	IA
4463	Voegeli Farm Inc.	Voegeli Farm, Inc.	WI
10442	Voegeli Farms, Inc., C Voegeli and H Voegeli	Voegeli Farms, Inc.	WI
8914	Dayne Voelker	Voelker Swiss Farm LLC	MO
1663	Tammy Voegeli	VoGrin Swiss	WI
13625	James Wanke	Wanke Farms	WI
14011	Abby Fairbanks	Wapsi-Ana	IA
14089	Hayden Weaver	Weaver Show Cattle	PA
13641	Wesley Winch	Winch's Pine Grove Farms	WI
13677	Wincrest Genetics	Wincrest Genetics	IL
13669	Wincrest Genetics and Eva Gilmore	Wincrest Genetics	IL
5583	Jesse & Kiley Muse	Windyhollow Show Cattle	KY
13676	Tj & Jazmin Wingert	Wingert Farms	IL
3658	Woodwind Farm	Woodwind Farm	WI
1325	Beth Nelson and Aaron Johnson	Xtreme Swiss	WI
10817	Nathen Zumbach	Zumbach Swiss'n Acres	IA
11783	Aaliyah Gunn		WI
12379	Aaron Olson		MN
14254	Abigail Wilber		CT
11444	Acclaimed Swiss		IA
7130	Adhyn Schell		MN
10363	Alex Roe		WI
13346	Alyssa Grocott and Lookout Farm		NY
13854	Aubree, Aiden & Alaina Topp and Jacob, Logan &		WI
10248	Ben Kinnard		WI
6684	Beth Dahl, Peter Hawkes, Nicolette Shelley		UT
11207	Bret & Shelby Keister		PA
13830	Brody Courtney		IA
13350	Brothers Three and Andrea & Brett Haines		WI
2410	Brown Heaven		QC
13045	Brown Swiss Enterprises		WI
8182	Caylee Nicole James		IN

## List of Exhibitors - Brown Swiss

ID	Name	Farm Name	State
13982	Drew Lueking		IL
10501	Eli Staudinger		WI
9297	Elizabeth D Schieferstine		NY
13918	Evan Hathaway and Payton Calvert		WI
14206	Fred Mathy and Donna Harp		MB
11317	Hadleigh, Ezra & Kenna Jones and Kelly Jo Manion		KY
12450	Hills Valley Farm and Lynn Telaak		NY
13071	Jayse Pudwill		IL
13324	John & Diane Sagaria, & Kenny Coppini		CA
13743	Kalee Schaefer		WI
13014	Kendalyn Waddell		WI
13928	Kennedy, William, & Paige Zimmerman		WI
11481	Kortney Smithling		NY
14057	Lauren & Gavin Kishman		IA
11039	Lindsay Rucks and Peter Vail		NY
12539	Louis & Garen Oliveira		CA
13747	Macy Weyer		WI
13985	Madeline Schmidt		WI
12678	Marlin Gaff and Blessing Farm		IN
12785	Michael Nelson		MN
13013	Michael Waddell		WI
10234	Milk Source and Brown Heaven		WI
11032	Nate Catlett of Helion Genetics		MD
11041	Niki & Kelsi Steffenhagen		WI
10247	Paige & Josie Kinnard		WI
13307	Peyton Voegeli		WI
11443	Pocket Aces Swiss		IA
7615	Sarah Hagenow		WI
13340	Stephanie Miller		MO
13504	Summer Kiernan		NY
13474	Topp-View & Brothers Three		WI



# SEPARATING THE INNOVATORS FROM THE IMITATORS.

**BOVALTA™ BMR IS THE NEWEST ADDITION TO A  
PROVEN LINE OF HIGH-PERFORMANCE SILAGE.**

## THE GOLD STANDARD IN SILAGE JUST GOT BETTER.



### **NEW! BREVANT® BRAND BOVALTA™ BMR PRODUCTS.**

Taking BMR to new levels of digestibility, tonnage, starch and agronomics.

**Bovalta™**  
BMR



### **BREVANT BRAND UNIFIED™ PRODUCTS.**

Proven increased starch digestibility to reduce ensiling times and increase feed efficiency.

**unified™**  
CORN SILAGE with SilaSoft™  
TECHNOLOGY



### **BREVANT BRAND FORAGE QUALITY (FQ) PRODUCTS.**

New silage offering brings confidence and flexibility for silage or grain. Superior silage tonnage and quality characteristics in top-grain-producing hybrids. FQ products meet the same standards and level of quality as traditional Brevant brand TMF products.

**FQ**



### **BREVANT BRAND TMF PRODUCTS.**

Built to maximize performance on a silage specific acre. Combines industry leading tonnage and agronomic strengths with high fiber and starch digestibility.

**STOP BY THE BREVANT® SEEDS BOOTH (598,599,638,639) TO LEARN  
MORE ABOUT OUR FULL LINEUP OF SILAGE PRODUCTS.**

# DEFINED BY

# YOU



A true partner is defined by those they support. That's why at Compeer Financial we're defined by you — your hopes for the future as well as what you need today. As a member-owned cooperative, our clients help shape the direction we go and how we serve them. And as agriculture continues to evolve, so will we, together. So whether you need an experienced lender, a trusted advisor or a friend you can count on, we're ready.

**DEFINE YOUR SUCCESS WITH US AT [COMPEER.COM/YOU](https://www.compeer.com/you) OR CALL (844) 426-6733**

Dairy Processing | Cold Storage | Loans & Leases | Business Services | And More

Compeer Financial can provide assistance with finances based on historical data and industry expertise. Compeer does not provide legal, tax or investment advice. Compeer Financial, ACA is an Equal Credit Opportunity Lender and Equal Opportunity Provider and Employer. © 2023 All rights reserved. NMLS #619731



# SHOW YOUR COWS THAT YOU CARE



## Our Barn-Grooving Solutions Keep Your Cows in Good Standing

Slippery barn floors are a common cause of injuries to cows, and can create big problems for dairy farmers. You can avoid this problem by grooving their floors to create traction. SMITH's FS351 DCS self-propelled heavy-duty scarifier is the perfect tool for creating these grooves.

It is capable of removing a path up to 16 inches wide, and can be equipped with a wide variety of cutters to create nearly any groove pattern or surface profile. The FS351 DCS also features SMITH's exclusive electronic DCS Depth Control System, which allows users to precisely adjust the cutter depth without stopping production.

- *Self-propelled with easy speed adjustment*
- *Side plate for faster drum changes*
- *Vacuum ports for dust collection*
- *Available in gasoline, electric, and propane-powered versions*

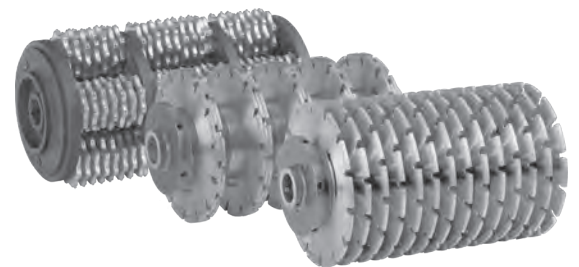
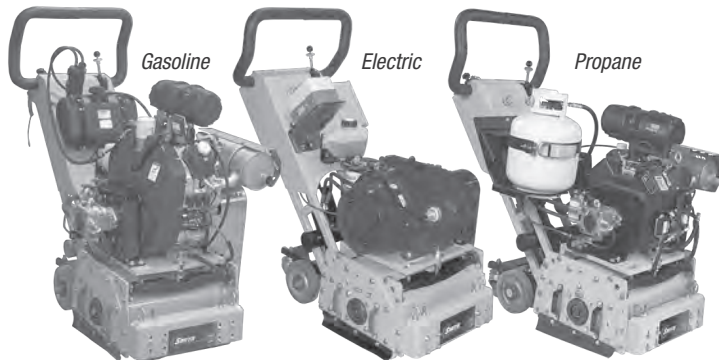
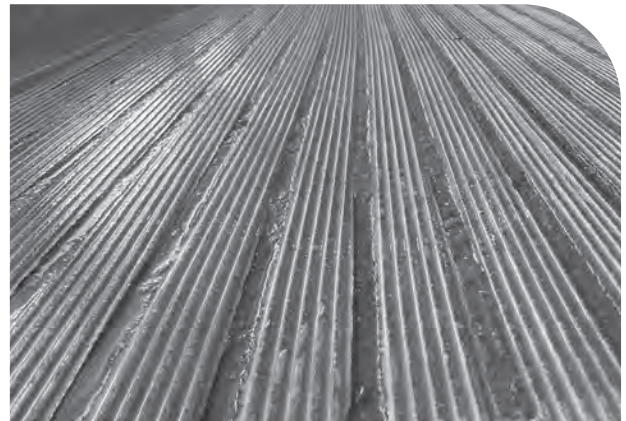

**CONTACT US ABOUT OUR BARN-GROOVING SOLUTIONS TODAY!**



**See us at World Dairy Expo booth TC 603/604  
or visit us online at [www.smithmfg.com](http://www.smithmfg.com)**

**HEALTHY ANIMALS.  
HEALTHY FOOD.  
HEALTHY WORLD.®**



We know a healthy herd is a productive one. Our comprehensive portfolio of dairy offerings includes proven and effective solutions that help you address important challenges and optimize the opportunity to support the health and productivity of your cows.

**Stop By and Visit With Us At**  
#EH4516 & #TM FF

**Phibro**  
ANIMAL HEALTH CORPORATION **TM**

**AB20**

**Animate**

**cellerate**  
YEAST SOLUTIONS®

**OmniGen**

**Hy•D**



**BouMatic** 

For the life of your dairy™

## **SHIELD HER FROM THE COLD**

BouMatic's Arctic Shield +Plus is a premium three-way protection skin conditioning package in a post dip that helps prevent frostbite. The high level of conditioning helps shield teat skin against cracking and chapping in cold harsh conditions while providing germicidal protection to help prevent mastitis.

Protect and insulate your herd when the temperature dramatically drops. Maintains its effectiveness even in subzero °F conditions.

*Effective but gentle, Arctic Shield +Plus is necessary for the upcoming cold weather season.*

*Learn more at [BouMatic.com/ArcticShield](http://BouMatic.com/ArcticShield)*



# CUT. RAKE. BALE. REPEAT.™



From first cut to last bale, New Holland hay and forage equipment helps you make top-quality hay and make it more productively — day in and day out. That's the advantage of our over 125 years of invention and innovation. New Holland haytools save you time and money, all while maximizing quality and feed value. You'll also work more confidently, knowing your local New Holland dealer is there with unparalleled service and support when it matters most. Cut, rake, bale, repeat — no one does hay better.

Stop by Trade Mall C to learn how New Holland equipment can help your dairy operation. Or, visit [newholland.com](http://newholland.com)





## REGISTER TODAY



to receive critical business information to help you thrive in a constantly changing economic environment.

[milkbusinessconference.com](http://milkbusinessconference.com)

### Agenda topics include:

- How to Find, Retain and Develop the Best Farm Employees
- The Biggest Challenges Ahead for Animal Agriculture
- From Good to Great — Producers Share Their Recipe for Success
- How Can Beef on Dairy Make You Even More Money

**PLUS: Jeff Civilico**, Las Vegas Headline, Host Personality, Philanthropist, will speak on “Work That Matters”



**COMMITTED TO**  
*WORLD DAIRY EXPO*  
**COMMITTED TO**  
*SILAGE*

**VISIT US IN THE TRADE CENTER TO LEARN MORE ABOUT OUR WORLD  
CLASS SILAGE HYBRIDS.**



**MASTERSCHOICE**  
SEEDCORN.COM



*your* **CALVES** *deserve*  
*the* **BEST COLOSTRUM**



Not all colostrum management systems are created equally. Golden Calf Company's Calf Hero™ colostrum pasteurizers and bags are field-tested to withstand the daily use of the largest dairies in America and our snap-in single-use tube feeder revolutionizes the hygiene of colostrum feeding. The benefits our customers praise most often are healthy calves and consistency of protocols. We are proud that all of our products are both designed and manufactured in the heart of America's dairyland.

Calf Hero™ colostrum bags are fully compatible with other systems in the market. Give us a call at 715.318.0897 or stop by our booth to get a competitive quote.

*bigger than ever*

**GOLDEN CALF COMPANY**  
**booth EH 3016 - 3318**

[www.GoldenCalfCompany.com](http://www.GoldenCalfCompany.com) 715.318.0897

-Notes-

# REDPINK VRC

MAIN CONCOURSE,  
 BOOTH MC67



REDPINK VRC

SABBIONA REDPINK VRC CF TY TV TL R  
 IT098990870073 - 198HO02315  
 CHAMPION RED X RIVETING X IMAX

## ONE OF THE BEST RED VARIANT SIRES IN THE WORLD

- ✓ BULL WITH THE VRC (DOMINANT RED) GENE: 50% OF OFFSPRING WILL BE BORN RED, REGARDLESS OF MATERNAL LINE.
- ✓ HE COMES FROM AN EXCEPTIONAL SABBIONA HOLSTEIN COW FAMILY: HIS DAM IS VG89 AND HIS GRANDDAM EX93.
- ✓ NICE COMBINATION OF LOW SOMATIC CELL COUNT AND POSITIVE MILKING SPEED.
- ✓ HIGH PRODUCTION INDEX, GOOD TYPE AND OUTSTANDING UDDERS.
- ✓ EASY CALVING

GPFT	+4525	REAR LEG SET	-0.12
MILK	+1557	SCS	114
PROTEIN	56 Kg	LONGEVITY	118
PROTEIN %	+0.04	HEAT TOL.	104
FAT	61 Kg	MILKING SPEED	105
FAT %	+0.03	GTPI*	+2757

ANAFI 08/2023

\*CDCB 08/2023

*At your side since 1974.*

**Intermizoo**<sup>®</sup>

# MOTHERS *Matter*

Maternal lines have always been critically important when sourcing the right sires for our Showcase listing. History has shown that maternal lines anchor the success of Showcase sires. These influential mothers are the backbone of our lineup and should be credited for the massive success that their lineage achieves in the showing and beyond.



 **SHOWCASE™**

L-R: S-S-I Doc Have Not 8784-ET (EX-96-EX-MS),  
Townlineacre King Doc Lena (EX-92-EX-MS),  
Siemers Lstr Hanan 33317-ET (VG-89-EX-MS)

### **S-S-I Doc Have Not 8784-ET (EX-96-EX-MS)**

Have Not is making history not only for her record-breaking sale price, but because of her ability to create progeny that will influence the breed for decades. She is the dam of 7H016791 HOMER and 7H016295 HAS IT ALL.

### **Townlineacre King Doc Lena (EX-92-EX-MS)**

Lena is a newcomer to the exclusive club of influential mothers. Tracing through the Goldwyn Locket branch of the Roxy maternal line, she already has two sons available: 7H016491 LEGENDAIRY and 250H016490 LOMBARDI.

### **Siemers Lstr Hanan 33317-ET (VG-89-EX-MS)**

The Hanker branch of the Dellia family has been a highlight of Showcase for several years, but 33317 levels up by adding traits like red factor and polled. Her sons 250H016498 HULU and 7H016493 HAKAN-P are carriers for these highly sought-after traits.



**YOUR SUCCESS** *Our Passion.*

(614) 873-4683 ♦ [www.selectsires.com](http://www.selectsires.com)